

# FINAL

JANUARY

## SPRING 1985 GRADUATE CLASS SCHEDULE



*Photo by Aaron Rosenblatt*

STATE UNIVERSITY OF NEW YORK AT  
**Stony Brook**

SPRING 1985 FINAL EXAMINATION SCHEDULE - MONDAY, MAY 13 THROUGH FRIDAY, MAY 17

PERIOD 1: 8:30 a.m.-11:30 a.m. PERIOD 2: Noon-3:00 p.m. PERIOD 3: 3:30 p.m.-6:30 p.m. PERIOD 4: 7:00 p.m.-10:00 p.m.

Large multisectioned courses having a common final examination time are listed in Part I. Their final examinations are scheduled according to the course number rather than the lecture time in Period 4, M through TH, or Period 2, W. All other final examinations are scheduled according to class time. See Part II. Examinations for courses having both a lecture and recitation are scheduled according to the lecture time. Unless otherwise announced by the instructor, the examination will be given in the room where the regular class is held. In planning programs for the semester, students should take the final examination schedule into consideration. It is the student's responsibility to plan a program that avoids examination conflicts as well as too many examinations in the same day. Instructors are not obliged to give make-up examinations to students who fail to avoid such situations.

PART I. PERIOD 4 and PERIOD 2-W

AMS 102	W-4	CHE 322	TH-4	ESG 271	TU-4	MAT 126	W-2	PHY 100	TU-4
BIO 152	W-4	CSE 113	M-4	MAP 102	TH-4	MAT 127	W-2	PHY 102	TU-4
BIO 232	W-4	ECO 114	M-4	MAT 120	W-2	MAT 131	W-2	PHY 104	TU-4
CHE 132	TH-4	ECO 251 (04-09)	TH-4	MAT 125	W-2	MAT 132	W-2	POL 261	TU-4

PART II. REGULAR CLASS MEETING TIME

	FINAL EXAMINATION TIME	
	DAY	PERIOD
<u>MONDAY-WEDNESDAY-FRIDAY</u>		
8:30-9:20 and classes beginning anytime from 8:30 to 9:15 on any of these days	W	3 *
9:30-10:20 and classes beginning anytime from 9:20 to 10:15 on any of these days	TU	2
10:30-11:20 and classes beginning anytime from 10:20 to 11:15 on any of these days	M	2
11:30-12:20 and classes beginning anytime from 11:20 to 12:15 on any of these days	TH	2
12:30-1:20 and classes beginning anytime from 12:20 to 1:15 on any of these days	TH	1
1:30-2:20 and classes beginning anytime from 1:20 to 2:15 on any of these days	M	3
2:30-3:20 and classes beginning anytime from 2:20 to 3:15 on any of these days	F	1
3:30-4:20 or M-W 3:30-4:45 and classes beginning anytime from 3:20-4:15 on any of these days	F	2
4:30-5:20 or M-W 5:30-6:45 and classes beginning anytime from 4:20-5:55 on any of these days	W	3 *
Classes beginning anytime from 6:00 p.m. to 7:15 p.m. and M classes at 6:00 or later	M	4
Classes beginning at 7:30 p.m. or later and W classes beginning at 6:00 or later	W	4
<u>TUESDAY-THURSDAY</u>		
8:30-9:45 and classes beginning anytime from 8:30 to 9:30 on either of these days	TU	3 **
9:55-11:10 and classes beginning anytime from 9:40 to 10:55 on either of these days	W	1
11:20-12:35 and classes beginning anytime from 11:00 to 12:20 on either of these days	TU	1
12:45-2:00 and classes beginning anytime from 12:30 to 1:45 on either of these days	M	1
2:15-3:30 and classes beginning anytime from 1:55 to 3:20 on either of these days	TH	3
3:45-5:00 and classes beginning anytime from 3:30 to 4:45 on either of these days	F	3
5:30-6:45 and classes beginning anytime from 5:00 to 5:55 on either of these days	TU	3 **
Classes beginning anytime from 6:00 p.m. to 7:15 p.m. and TU classes beginning at 6:00 or later	TU	4
Classes beginning at 7:30 p.m. or later and TH classes beginning at 6:00 or later	TH	4

\* MWF 8:30-9:20 and 4:30-5:20 and MW 5:30-6:45 classes have final examinations at the same time.

\*\* TUTH 8:30-9:45 and TUTH 5:30-6:45 classes have final examinations at the same time.

# ACADEMIC CALENDAR

SPRING 1985

- December 31, Monday Last day for mail payments of Spring Semester fees for preregistered students.
- January 7, Monday Last day for preregistered students to pay Spring Semester fees in person without late payment penalty.
- January 14, Monday Foreign students arrive.
- January 15-18, Tuesday-Friday Final registration and payment (or proper deferral) of fees for all students not previously registered (schedule announced prior to registration).
- January 16, Wednesday Undergraduate student orientation for new transfer students. Intersession housing ends. Residence halls open for new student check-in at 1:00 p.m.
- January 17, Thursday Undergraduate student orientation for new Freshmen.
- January 18, Friday Residence halls open for returning student check-in (Friday-Sunday). Undergraduate student orientation for students not having participated previously.
- January 21, Monday Classes begin; late registration period begins with \$20 late fee assessed.
- January 23, Wednesday Senior Citizen Auditor Program registration (telephone 246-3305 for information).
- February 1, Friday End of late registration period; last day for undergraduate students to add a course or to drop a course without a W (Withdrawal) grade being recorded; last day for all students to drop a course without tuition liability; last day for undergraduates to apply for a change of status to or from full-time/part-time.
- February 8, Friday Last day for undergraduates to file for May graduation at the Office of Records/Registrar.
- February 15, Friday Last day for graduate students to add or drop a course. Last day for graduate students to file for May graduation; graduate students (except CED) file at Graduate School Office; CED students file at CED Office.
- March 8, Friday Spring recess begins at close of classes.
- March 15, Friday Spring quarter housing period ends.
- March 18, Monday Classes resume.
- March 22, Friday Last day for removal of Incomplete and NR (No Record) grades from the Fall semester.
- March 29, Friday Last day for undergraduates to withdraw from a course without withdrawing from the University; last day to change courses to or from Pass/No Credit.
- April 15, Monday Advance registration for Fall semester begins (schedule announced prior to registration). Bills for Fall semester to be mailed approximately June 1 with payment due during latter part of July.
- April 19, Friday Last day for graduate students to submit theses and dissertations to Graduate School for May graduation.
- April 22, Monday Registration begins for Summer Session with fees payable at time of registration.
- May 10, Friday Last day of classes; last day to withdraw from the University.
- May 13, Monday Final examinations begin; final grades due in Registrar's Office 48 weekday hours after last class meeting or scheduled examination.
- May 17, Friday Final examinations end; Spring semester ends. Residence halls close for all except graduating seniors and summer residents.
- May 19, Sunday Commencement; all residence halls close.
- May 24, Friday Last day for departments to submit Completion Statements for May master's and doctoral degree candidates.

HEALTH SCIENCES CENTER COURSES

In order to register for a Health Sciences Center Course, permission of the instructor must be obtained prior to registration. The courses listed below are available on a limited basis to non-HSC students.

- HAS 507 CLINICAL NUTRITION, 3 cr., Wednesday, 5:00-7:30, Mullen, 124-3240
- HAS 510 COMMUNITY RESOURCES FOR THE ELDERLY, 3 cr., Tuesday 5:00-7:30, Porcino, 6-5936
- HAS 529 PATIENT EDUCATION, 3 cr., HTBA, Rice, 124-3198
- HAS 537 RESOURCE MANAGEMENT, 3 cr., Thursday, 6:00-8:30, Gorin, 124-3245
- HAS 538 HEALTH ECONOMICS & PUBLIC POLICY, 3 cr., Monday, 5:00-7:30, Leikin, 124-3243
- HAS 562 TEACHING STRATEGIES FOR HEALTH PROFESSIONALS, 3 cr., Wednesday, 5:00-7:30, Instructor TBA, Dr. Walton for permission 124-3240
- HBA 536 BIOLOGICAL CLOCKS, 3 cr., HTBA, Dr. Edmunds, 6-5028
- HBA 564 PRIMATE EVOLUTION, 4 cr., HTBA, Dr. Fleagle, 4-3121
- HBA 590 PROJECTS IN ANATOMICAL SCIENCES, 1-6 cr., HTBA, Staff, 4-2350
- HBA 656 CELL BIOLOGY, 3 cr., HTBA, Dr. Prives, 4-3139
- HBM 505 BIOPHYSICS OF MACROMOLECULES, 2 cr., HTBA, PRQ: Permission of instructor  
Micro. Dept. 6-2446
- HBM 531 MEDICAL MICROBIOLOGY, 1-4 cr., HTBA, Term code X, Micro Dept., 6-2446
- HBM 599 GRADUATE RESEARCH, 1-8 cr., HTBA. Individual arrangements to be made with an instructor in Microbiology. Micro Dept. 6-2446
- HBM 612 ANIMAL VIROLOGY, 3 cr., HTBA, Dr. Tegtmeyer, 6-2239
- HBM 622 SHORT COURSES IN MICROBIOLOGY, 1 cr., HTBA, Micro Dept. 6-2446
- HBM 690 MICROBIOLOGY SEMINAR, 1 cr., HTBA, Micro Dept., 6-2446
- HBM 691 READINGS IN MICROBIOLOGY LITERATURE, 1 cr., HTBA, Dr. Brugge, 6-2829
- HBP 552 RADIOPATHOLOGY, 1 cr., HTBA, 4-3000
- HBP 553 PATHOLOGY OF NEOPLASIA, 2 cr., HTBA, 4-3000
- HBP 554 ADVANCED IMMUNOLOGY, 2 cr., HTBA, 4-3030, Dr. Habicht
- HBP 558 GLYCOPROTEINS, 2 cr., HTBA, Dr. McDevitt, 4-3014
- HBP 559 PROTEOLYTIC ENZYMES, 2 cr., Drs. Jesty and Janoff, 4-3006
- HBP 590 SEMINARS IN IMMUNOLOGY, 1 cr., HTBA, Dr. Habicht, 4-3030
- HBP 690 SEMINAR IN PATHOLOGY, 1-4 cr., HTBA, Dr. Miller, 4-3000
- HBY 551 MEMBRANE PHYSIOLOGY & BIOPHYSICS, 3 cr., HTBA, Dr. McLaughlin, 4-3039
- HBY 591 RESEARCH PROJECT IN PHYSIOLOGY & BIOPHYSICS, 1-12 cr., HTBA, 4-2287
- HBY 690 SEMINARS IN PHYSIOLOGY & BIOPHYSICS, 1-2 cr., HTBA, 4-2287
- HBO 500 BIOLOGY OF THE ORAL MINERALIZED TISSUES, 3 cr., Dr. Kaufman, 4-2870, PRQ: Oral Biology & Pathology or equivalent
- HBO 510 SALIVARY METABOLISM AND SECRETION, 3 cr., Dr. Kleinberg, 6-2860, Dr. Pollock, 6-2876, PRQ: Oral Biology & Pathology or equivalent
- HBO 520 ORAL MICROBIAL SYSTEMS, 3 cr., Dr. Pollock, 6-2876, Dr. McNamara, 6-2873, Dr. Kleinber, 6-2860, PRQ: Oral Biology & Pathology or equivalent
- HBO 530 MOLECULAR BIOLOGY & PATHOLOGY OF THE PERIODONTIUM, 3 cr., Dr. Golub, 6-2878, Dr. Garant, 6-2802. PRQ: Oral Biology & Pathology or equivalent
- HBO 535 EPITHELIAL KERATINIZATION & DIFFERENTIATION, 3 cr., Dr. Taichman, 4-2884, PRQ: Suggested HBP 531; students must have background in Cellular Biochemistry
- HBO 545 SUGAR AND MAN, 3 cr., Dr. Screebny, 4-2840
- HBO 560 ORAL BIOLOGY & PATHOLOGY I, 3 cr., Dr. Kleinberg, 6-2860 and staff
- HBO 561 ORAL BIOLOGY & PATHOLOGY II, 3 cr., Dr. Kleinberg, 6-2860 and staff
- HBO 562 ORAL BIOLOGY & PATHOLOGY III, 3 cr., Dr. Kleinberg, 6-2860 and staff
- HBO 563 ORAL BIOLOGY & PATHOLOGY IV, 3 cr., Kr. Kleinberg, 6-2860 and staff  
PRQ: For HBO 560,561,562,563: Undergrad degree in basic science & perm.of instruc.
- HBO 590 RESEARCH PROJECTS IN ORAL BIOLOGY & PATHOLOGY, 3 cr., Dr. Pollock, 6-2876  
PRQ: Students must be enrolled in masters or doctorate program

- HBO 599 GRADUATE RESEARCH, 1-12 cr., 6-2876  
HBO 690 ORAL BIOLOGY & PATHOLOGY SEMINARS, 1 cr., Dr. Taichman 6-2884  
HBO 694 THESIS RESEARCH IN ORAL BIOLOGY & PATHOLOGY, 1-12 cr.  
HBO 695 ORAL BIOLOGY & PATHOLOGY TEACHING PRACTICUM, 1-4 cr.

Students must secure signature of School of Social Welfare faculty member before registering.

- HWC 519 PRACTICE WITH CHILDREN AND ADOLESCENTS, 3 cr., Wednesday, 9:30-12:00,  
Donald McGuire  
HWC 525 WOMEN AND HEALTH CARE, 3 cr., Wednesday 12:45-3:15, Elinor Polansky  
HWC 545 INDIVIDUAL & FAMILY TREATMENT OF ALCOHOLICS & SUBSTANCE ABUSERS, 3 cr.,  
Wednesday, 6:15-8:45, Frances Brisbane  
HWC 546 TREATING CHILDREN OF ALCOHOLICS 3 cr., Sunday, 12:00-5:00, March 1, 17, 24, 31,  
April 14, 21, 18, May 5, Frances Brisbane  
HWC 549 OVERVIEW OF GAY & LESBIAN ISSUES, 3 cr., Thursday, 9:30-12:00 Robert Hawkins  
HWC 554 SOCIAL WORK & THE LEGAL SYSTEM, 3 cr., Wednesday, 6:15-8:45, Steven Kraft

144  
145  
146  
147  
148

149  
150  
151  
152  
153

154  
155  
156  
157  
158

159  
160  
161  
162  
163

164  
165  
166  
167  
168

DEPT	COURSE	TITLE	CREDITS	SECT	TYPE	MEETING TIMES	INSTRUCTOR	LOCATION			
<b>AMS COURSES</b>											
AMS	501	DIFF EQUAT & BUP I	3.0	01	LEC	TUTH	03:45-05:00	DICKER	EARTH&SPACE	177	
AMS	503	COMPLEX ANALYSIS	3.0	01	LEC	TUTH	12:45-02:00	KIM	PHYSICS	P122	
AMS	504	FOUND OF APPL MATH	3.0	01	LEC	TUTH	11:20-12:35	DOLEZAL	LGT ENGR LAB	244	
AMS	506	FINITE STRUCTURES	3.0	01	LEC	TUTH	03:45-05:00	GRIMSON	ENGINEERING	114	
AMS	507	INTRO APPLIED PROB	3.0	REMARK: FORMERLY MSA 507							
				01	LEC	MW	05:30-06:45		PHYSICS	P127	
AMS	527	NUMERICAL ANALYS 11	3.0	01	LEC	TUTH	05:30-06:45	DOLEZAL	PHYSICS	P122	
AMS	529	SIMULATION & MODELING	3.0	PREREQ: CSE 201 OR EQUIVALENT REMARK: CROSSLISTED WITH CSE 529							
				01	LEC	TUTH	12:45-02:00		LGT ENGR LAB	244	
AMS	531	INV & SPARSE MATRICS	3.0	01	LEC	MW	03:30-04:45	TEWARSON	CHEMISTRY	124	
AMS	563	NONLIN DSCRT TIME SY	3.0	REMARK: CROSSLISTED ESE 556							
				01	LEC	MWF	02:30-03:20	ZEMANIAN	LGT ENGR LAB	248	
AMS	570	MATH STATISTICS I	3.0	PREREQ: AMS 312 OR EQUIVALENT							
				01	LEC	MW	02:00-03:15	LIU	LGT ENGR LAB	244	
AMS	573	CATEGORICAL DATA	3.0	PREREQ: AMS 572							
				01	LEC	MW	03:30-04:45	MENDELL	CHEMISTRY	128	
AMS	575	DATA ANALYSIS LAB	3.0	PREREQ: PERMISSION OF INSTRUCTOR							
				01	LAB	F	03:30-05:30	MENDELL			
AMS	576	STAT METH IN SOC SCI	3.0	PREREQ: AMS 310 OR PERMIS OF INSTR							
				01	LEC	TUTH	07:00-08:15	THODE	PHYSICS	P128	
AMS	578	REGRESSION THEORY	3.0	PREREQ: AMS 572 OR EQUIVALENT							
				01	LEC	MW	07:00-08:15	ZHANG	OLD PHYSICS	115	
AMS	584	SEQUENTIAL STAT METH	3.0	PREREQ: AMS 569, AMS 570, AMS 571							
				01	LEC	MW	05:30-06:45	ZHANG	PHYSICS	P128	
AMS	599	RESEARCH	1.0-12.0	01	TUT	HTBA		KIM			
				02	TUT	HTBA		DICKER			
AMS	605	PROBABILITY THRY II	3.0	01	LEC	MW	01:30-03:20	DICKER	CHEMISTRY	128	
AMS	691	TOPICS IN APPL MATH	3.0	REMARK: SEC1:OR:POL SCI;2:OR INT PROG;3:SQNTL ANAL;4:GME THY;5:NUM SOL PDE							
				01	LEC	HTBA		BALINSKI	ENGINEERING	112	
				02	LEC	TH	02:15-05:00	JOHNSON	LGT ENGR LAB	248	
				02	LEC	F	09:30-12:20		SOCBEHAV SCI	S632	
				04	LEC	TUTH	09:55-11:10		LGT ENGR LAB	244	
				05	LEC	MW	12:30-01:45				
				07	LEC	HTBA					
AMS	697	COLLOQUIA & SEMINARS	1.0	REMARK: SECTION 1:TOPICS IN APPLIED PROBABILITY. SI/U GRADING.							
				01	SEM	M	09:30-12:20		LGT ENGR LAB	246	
				02	SEM	W	09:30-12:20		LGT ENGR LAB	246	
AMS	698	PRACT IN TEACHING	3.0	01	TUT	HTBA		FINCH			
				02	TUT	HTBA		BELTRAMI			
				03	TUT	HTBA		DICKER			
				04	TUT	HTBA		KIM			
AMS	699	RESEARCH	1.0-12.0	01	TUT	HTBA		BALINSKI			
				02	TUT	HTBA		BAXTER			
				03	TUT	HTBA		BELTRAMI			
				04	TUT	HTBA		CHANG			
				05	TUT	HTBA		CHEN			
				06	TUT	HTBA		DICKER			
				07	TUT	HTBA		DOLEZAL			
				08	TUT	HTBA		FINCH			
				10	TUT	HTBA		JENSEN			
				11	TUT	HTBA		KATEHAKIS			
				12	TUT	HTBA		KIM			
				13	TUT	HTBA		KUO			
				15	TUT	HTBA		MENDELL			
				16	TUT	HTBA		SRIVASTAV			
				17	TUT	HTBA		TEWARSON			
<b>ANT COURSES</b>											
ANT	500	SOC & CULTURAL ANT	3.0	PREREQ: GRADUATE STUDENT STATUS							
				01	LEC	TU	06:00-08:30PM	STEVENSON	SOCBEHAV SCI	N104	
ANT	502	DEV ANT THEORY	3.0	01	LEC	W	10:00-12:30	FARON	SOCBEHAV SCI	N505	
ANT	503	EVOL OF THE STATE	3.0	01	LEC	W	02:30-05:00	STONE	SOCBEHAV SCI	N505	
ANT	520	PRINC SOC CULT ANTH	3.0	01	LEC	TUTH	01:30-02:45	GLICK	SOCBEHAV SCI	S514	
ANT	578	LANG & CULT CONTEXT	3.0	01	LEC	TUTH	11:30-12:45	BONVILLAIN	SOCBEHAV SCI	S514	
ANT	600	PRACTICUM IN TCHNG	1.0-12.0	01	TUT	HTBA		STAFF			
				02	TUT	HTBA		GLICK			
				03	TUT	HTBA		CARRASCO			
				04	TUT	HTBA		FARON			
				05	TUT	HTBA		GILMORE			
				06	TUT	HTBA		HICKS			
				07	TUT	HTBA		ARENS			
				08	TUT	HTBA		LIGHTFOOT			
				09	TUT	HTBA		KENNEDY			
				10	TUT	HTBA		NEWTON			
				11	TUT	HTBA		STARR			
				12	TUT	HTBA		STEVENSON			
				13	TUT	HTBA		WEIGAND			
				15	TUT	HTBA		BONVILLAIN			
				17	TUT	HTBA		GRINE			
ANT	610	INDIVIDUAL RESEARCH	1.0-12.0	01	TUT	HTBA		STAFF			
				02	TUT	HTBA		GLICK			
				03	TUT	HTBA		CARRASCO			
				04	TUT	HTBA		FARON			
				05	TUT	HTBA		GILMORE			
				06	TUT	HTBA		HICKS			
				07	TUT	HTBA		ARENS			
				08	TUT	HTBA		LIGHTFOOT			
				09	TUT	HTBA		KENNEDY			
				10	TUT	HTBA		NEWTON			
				11	TUT	HTBA		STARR			
				12	TUT	HTBA		STEVENSON			
				13	TUT	HTBA		WEIGAND			
				15	TUT	HTBA		BONVILLAIN			

DEPT	COURSE	TITLE	CREDITS	SECT	TYPE	MEETING TIMES	INSTRUCTOR	LOCATION	
				16	TUT	HTBA	STONE		
				17	TUT	HTBA	GRINE		
				18	TUT	HTBA	CREEL		
				19	TUT	HTBA	FLEAGLE		
				20	TUT	HTBA	INKE		
				21	TUT	HTBA	JUNGERS		
				22	TUT	HTBA	KRAUSE		
				23	TUT	HTBA	STERN		
				24	TUT	HTBA	SUSMAN		
				25	TUT	HTBA	ARONOFF		
				26	TUT	HTBA	JONAITIS		
				27	TUT	HTBA	MITTERMEIE		
				28	TUT	HTBA	HARBOTTLE		
				29	TUT	HTBA	ANSHEN		
				30	TUT	HTBA	LARSON		
ANT	630	SEMINAR IN PHYS ANTH	3.0	PREREQ: ANT 530 AND/OR PERMISSION					
				01	SEM	TU	GRINE	SOCBEHAV SCI N526	
ANT	640	#AFRICAN ETHNOLOGY	1.0-3.0	01	SEM	F	ARENS	SOCBEHAV SCI N505	
ANT	680	SPECIAL SEMINAR	1.0-3.0	PREREQ: GRADUATE STATUS					
				01	SEM	W		SOCBEHAV SCI N505	
ANT	699	RES SEM IN FIELDWORK	1.0-12.0	01	TUT	HTBA	STAFF		
				02	TUT	HTBA	GLICK		
				03	TUT	HTBA	CARRASCO		
				04	TUT	HTBA	FARON		
				05	TUT	HTBA	GILMORE		
				06	TUT	HTBA	HICKS		
				07	TUT	HTBA	ARENS		
				08	TUT	HTBA	LIGHTFOOT		
				09	TUT	HTBA	KENNEDY		
				10	TUT	HTBA	NEWTON		
				11	TUT	HTBA	STARR		
				12	TUT	HTBA	STEVENSON		
				13	TUT	HTBA	WEIGAND		
				15	TUT	HTBA	BONVILLAIN		
				16	TUT	HTBA	STONE		
				17	TUT	HTBA	GRINE		
				18	TUT	HTBA	CREEL		
				19	TUT	HTBA	FLEAGLE		
				20	TUT	HTBA	INKE		
				21	TUT	HTBA	JUNGERS		
				22	TUT	HTBA	KRAUSE		
				23	TUT	HTBA	STERN		
				24	TUT	HTBA	SUSMAN		
				25	TUT	HTBA	ARONOFF		
				26	TUT	HTBA	JONAITIS		
				27	TUT	HTBA	MITTERMEIE		
				28	TUT	HTBA	HARBOTTLE		
				29	TUT	HTBA	ANSHEN		
				30	TUT	HTBA	LARSON		
<b>ARH COURSES</b>									
ARH	503	HIST 20TH ART CRIT	3.0	01	SEM	HTBA			
ARH	543	TOPICS RENAISSNC ART	3.0	01	SEM	HTBA			
ARH	545	TOPICS 19TH CENT ART	3.0	01	SEM	HTBA			
ARH	591	PRACT WRIT ART CRIT	3.0	03	TUT	HTBA	RUBIN		
				07	TUT	HTBA	GUILMAIN		
				08	TUT	HTBA	POLCARI		
				10	TUT	HTBA	BOGART		
				17	TUT	HTBA	KUSPIT		
				18	TUT	HTBA	MOSKOWITZ		
				21	TUT	HTBA	JONAITIS		
ARH	592	TEACHING PRACTICUM	3.0	01	TUT	HTBA	GUILMAIN		
				02	TUT	HTBA	POLCARI		
ARH	595	DIRECTED READINGS	1.0-3.0	03	TUT	HTBA	RUBIN		
				07	TUT	HTBA	GUILMAIN		
				08	TUT	HTBA	POLCARI		
				10	TUT	HTBA	BOGART		
				17	TUT	HTBA	KUSPIT		
				18	TUT	HTBA	MOSKOWITZ		
				21	TUT	HTBA	JONAITIS		
<b>BCD COURSES</b>									
BCD	500	READ GEN/DEVEL BIO	1.0-3.0	PREREQ: APPROVAL OF MASTERS PROG COMMITTEE					
				01	TUT	HTBA			
BCD	530	PROJ-DEVEL BIOLOGY	2.0	01	LAB	HTBA			
BCD	532	GRAD SEM DEVEL BIO	1.0	01	SEM	W	11:30-12:30		
BCD	535	PHYS-DEV HIGH PLANTS	3.0	01	LEC	HTBA			
BCD	536	BIOLOGICAL CLOCKS	3.0	PREREQ: BASIC KNOWLEDGE OF PLANT & ANIMAL BIOLOGY & BIOCHEMISTRY					
				01	LEC	M	07:00-09:30PM		
BCD	599	RESEARCH	1.0-12.0	01	TUT	HTBA	STAFF		
				02	TUT	HTBA	ARNHEIM		
				03	TUT	HTBA	BOGENHAGEN		
				04	TUT	HTBA	DELIHAS		
				05	TUT	HTBA	EDMUNDS		
				06	TUT	HTBA	ERK		
				07	TUT	HTBA	KATZ		
				08	TUT	HTBA	KRIKORIAN		
				09	TUT	HTBA	LUCAS		
				10	TUT	HTBA	LYMAN		
				11	TUT	HTBA	MARCU		
				12	TUT	HTBA	MERRIAM		
				13	TUT	HTBA	PALATNIK		
				14	TUT	HTBA	PRIVIS		
				15	TUT	HTBA	TAICHMAN		
				16	TUT	HTBA	WALCOTT		
				17	TUT	HTBA	WILLIAMSON		
				25	TUT	HTBA	SADOGU		
				26	TUT	HTBA			
				27	TUT	HTBA			
BCD	622	DEVELOPMNTL BIO SEM	1.0	01	SEM	F	11:30-12:30		
BCD	656	CELL, TISSUE BIOLOGY	4.0	PREREQ: BACCALAUREATE IN SCIENCE OR PERMIS OF INSTR					
				01	SEM	HTBA			



DEPT	COURSE	TITLE	CREDITS	SECT	TYPE	MEETING TIMES	INSTRUCTOR	LOCATION
BCD	699	PHD RESEARCH	1.0-12.0	01	TUT	HTBA	ARNHEIM	
				02	TUT	HTBA	BATTLE	
				03	TUT	HTBA	BOGENHAGEN	
				04	TUT	HTBA	DELIHAS	
				05	TUT	HTBA	EDMUNDS	
				06	TUT	HTBA	ERK	
				07	TUT	HTBA	KATZ	
				08	TUT	HTBA	KRIKORIAN	
				09	TUT	HTBA	LUCAS	
				10	TUT	HTBA	LYMAN	
				11	TUT	HTBA	MARCU	
				12	TUT	HTBA	MERRIAM	
				13	TUT	HTBA	PALATNIK	
				14	TUT	HTBA	PRIVES	
				15	TUT	HTBA	TAICHMAN	
				16	TUT	HTBA		
				26	TUT	HTBA		
<b>BEE COURSES</b>								
BEE	500	READS IN ECOL/EVOL	1.0-3.0	PREREQ: APPROVAL OF MASTERS PROG COMMITTEE				
				01	TUT	HTBA		
BEE	552	BIOMETRY	4.0	01	SEM	HTBA		
BEE	556	RESEARCH - ECOL & EV	1.0-2.0	01	SEM	HTBA		
BEE	557	NUMERICAL TAXONOMY	3.0	PREREQ: BEE 552				
				01	LEC	HTBA		
BEE	558	TUTORIAL READINGS	1.0-18.0	01	TUT	HTBA		
				02	TUT	HTBA	ARMSTRONG	
				03	TUT	HTBA	BENTLEY	
				04	TUT	HTBA	THOMSON	
				05	TUT	HTBA	FARRIS	
				06	TUT	HTBA	FUTUYMA	
				07	TUT	HTBA	BELL	
				08	TUT	HTBA	HECHTEL	
				09	TUT	HTBA	KOEHN	
				10	TUT	HTBA	LEVINTON	
				11	TUT	HTBA	ROHLF	
				12	TUT	HTBA	SLOBODKIN	
				13	TUT	HTBA	SMOLKER	
				14	TUT	HTBA	SOKAL	
				15	TUT	HTBA	WILLIAMS	
				16	TUT	HTBA	EANES	
				20	TUT	HTBA	WALSH	
				21	TUT	HTBA	GINZBURG	
BEE	559	STUDIES IN ORGANISMS	1.0-4.0	01	TUT	HTBA	STAFF	
BEE	575	PHYLOGENETIC SYST	3.0	01	SEM	HTBA		
BEE	588	CUR TOPICS ECOL EVOL	2.0	01	SEM	HTBA		
BEE	599	RESEARCH	1.0-12.0	REMARK: CREDITS VARIABLE & REPETITIVE				
				01	TUT	HTBA		
				02	TUT	HTBA	ARMSTRONG	
				03	TUT	HTBA	BENTLEY	
				04	TUT	HTBA	CARROLL	
				05	TUT	HTBA	FARRIS	
				06	TUT	HTBA	FUTUYMA	
				07	TUT	HTBA	BELL	
				08	TUT	HTBA	HECHTEL	
				09	TUT	HTBA	KOEHN	
				10	TUT	HTBA	LEVINTON	
				11	TUT	HTBA	ROHLF	
				12	TUT	HTBA	SLOBODKIN	
				13	TUT	HTBA	SMOLKER	
				14	TUT	HTBA	SOKAL	
				15	TUT	HTBA	WILLIAMS	
				16	TUT	HTBA	EANES	
				20	TUT	HTBA	WALSH	
				21	TUT	HTBA	GINZBURG	
				22	TUT	HTBA	BATTLE	
				23	TUT	HTBA	FOWLER J	
				24	TUT	HTBA	LASER	
				25	TUT	HTBA	MALLON	
				26	TUT	HTBA	GINZBURG H	
BEE	670	INFORMAL SEMINAR	2.0	01	SEM	TUTH		
BEE	672	ECOL & EVOL COLLOQ	0.0	01	SEM	W	11:30-12:30	
BEE	693	SEM:POPLN&COMUN ECOL	2.0	REMARK: CROSSLISTED WITH OCN 693				
				01	SEM	HTBA		
BEE	699	THESIS RESEACH	1.0-12.0	01	TUT	HTBA	STAFF	
				02	TUT	HTBA	ARMSTRONG	
				03	TUT	HTBA	BENTLEY,B	
				04	TUT	HTBA	THOMSON	
				05	TUT	HTBA	FARRIS,J	
				06	TUT	HTBA	FUTUYMA	
				07	TUT	HTBA	BELL	
				08	TUT	HTBA	HECHTEL	
				09	TUT	HTBA	KOEHN	
				10	TUT	HTBA	LEVINTON J	
				11	TUT	HTBA	ROHLF	
				12	TUT	HTBA	SLOBODKIN	
				13	TUT	HTBA	SMOLKER	
				14	TUT	HTBA	SOKAL	
				15	TUT	HTBA	WILLIAMS	
				16	TUT	HTBA	EANES	
				20	TUT	HTBA	WALSH	
				21	TUT	HTBA	GINZBURG	
				22	TUT	HTBA	BATTLE	
				23	TUT	HTBA	FOWLER	
				24	TUT	HTBA	LASER	
				25	TUT	HTBA	MALLON	
				26	TUT	HTBA	GINZBURG H	
<b>BGE COURSES</b>								
BGE	510	GRADUATE GENETICS	3.0	PREREQ: PERMISSION OF INSTRUCTOR				
				01	LEC	HTBA		
BGE	530	LABORATORY ROTATION	2.0	PREREQ: PERMISSION OF INSTRUCTOR				
				01	LAB	HTBA		
BGE	531	GRAD STU SEM IN GENS	1.0	PREREQ: PERMISSION OF INSTRUCTOR				
				01	SEM	HTBA		

DEPT	COURSE	TITLE	CREDITS	SECT TYPE	MEETING TIMES	INSTRUCTOR	LOCATION
BGE	550	GENETICS SEMINAR	1.0	PREREQ: PERMISSION OF INSTRUCTOR 01 SEM HTBA			
BGE	599	GRADUATE RESEARCH	1.0-8.0	PREREQ: PERMISSION OF INSTRUCTOR REMARK: S/U GRADING 01 TUT HTBA			
BGE	699	DISSERTATION RESRCH	1.0-9.0	PREREQ: ADVANCEMENT TO CANDIDACY 01 TUT HTBA			
<b>BIO COURSES</b>							
BIO	571	BIOLOGY & ETHICS	3.0	01 LEC HTBA	TUTH 03:45-05:00	MALLON	
BIO	599	RESEARCH	1.0-18.0	REMARK: FORMERLY BHT 599 01 TUT HTBA			
BIO	600	PRACTICUM IN TEACH	0.0-0.0	01 TUT HTBA		STAFF	
BIO	601	PRACTICUM IN TEACH	1.0-3.0	01 TUT HTBA			
<b>BMO COURSES</b>							
BMO	500	READS MOLECULAR BIO	1.0-3.0	PREREQ: APPROVAL OF MASTERS PROG EXC COMMITTEE 01 TUT HTBA			
BMO	505	#REGULATION:GENE EXP	2.0	PREREQ: BIO 361 OR EQUIVALENT 01 LEC TU	02:00-03:30	STERNGLANZ MARCJ FREUNDLICH INOUYE	LIFE SCIENCE 060
BMO	510	EXPERIMENT BIOCHEM	1.0-4.0	01 LEC HTBA			
BMO	512	PHYSICAL BIOCHEM	2.0	PREREQ: BMO 520 & CHE 301 OR 312, OR EQUIVALENT 01 LEC TU	04:00-05:40	SARMA	
BMO	521	BIOCHEMISTRY II	2.0	PREREQ: INTRO BIOCHEMISTRY 01 LEC MW	04:00-04:50	SIMPSON	SOCBEHAV SCI N109
BMO	599	RESEARCH	1.0-12.0	01 TUT HTBA		STAFF	
				02 TUT HTBA		ARNHEIM	
				03 TUT HTBA		CIRILLO	
				04 TUT HTBA		DUDOCK	
				05 TUT HTBA		FREUNDLICH	
				06 TUT HTBA		INOUYE	
				07 TUT HTBA		MOOS	
				08 TUT HTBA		RILEY	
				09 TUT HTBA		SARMA	
				10 TUT HTBA		LONDON	
				11 TUT HTBA		SCHMIDT	
				12 TUT HTBA		SIMON	
				13 TUT HTBA		SIMPSON	
				14 TUT HTBA		STERNGLANZ	
				20 TUT HTBA		SAMBROOK	
				21 TUT HTBA		SETLOW	
				22 TUT HTBA		SHAW	
				23 TUT HTBA		STUDIER	
				24 TUT HTBA		MARCJ	
				25 TUT HTBA		CARLSON	
				26 TUT HTBA		ERK	
				27 TUT HTBA		KRIKORIAN	
BMO	602	COLLOQ IN MOL.BIOL.	1.0	01 SEM TH	04:00-05:00	MARCJ	
BMO	604	STUDENT SEMINAR	1.0	01 SEM TU	11:30-12:30	SCHECHTER	
BMO	606	MOL BIOL WORKSHOP	1.0	01 SEM TH	11:30-12:30	INOUYE	
BMO	687	#GENES IN EUKARYOTIC	1.0	01 SEM HTBA		MARCJ	
BMO	699	PHD RESEARCH	1.0-12.0	01 TUT HTBA		ARNHEIM	
				02 TUT HTBA		CIRILLO	
				03 TUT HTBA		DUDOCK	
				04 TUT HTBA		FREUNLICH	
				05 TUT HTBA		INOUYE	
				06 TUT HTBA		MOOS	
				07 TUT HTBA		RILEY	
				08 TUT HTBA		SARMA	
				09 TUT HTBA		LONDON	
				10 TUT HTBA		SCHMIDT	
				11 TUT HTBA		SIMON	
				12 TUT HTBA		SIMPSON	
				13 TUT HTBA		STERNGLANZ	
				14 TUT HTBA		SAMBROOK	
				20 TUT HTBA		SETLOW	
				21 TUT HTBA		SHAW	
				22 TUT HTBA		STUDIES	
				23 TUT HTBA		MARCJ	
				24 TUT HTBA		CARLSON	
				25 TUT HTBA		ERK	
				26 TUT HTBA		KRIKORIAN	
				27 TUT HTBA			
<b>BNB COURSES</b>							
BNB	500	READINGS BEHAV NEURO	1.0-3.0	PREREQ: APPROVAL OF MASTERS PROG EXC COMMITTEE 01 TUT HTBA			
BNB	532	ADV NEUROBIOLOGY	3.0	PREREQ: PERMISSION OF INSTRUCTOR REMARK: REPETITIVE CREDIT 01 LEC HTBA			
				01 SEM HTBA			
BNB	547	READING:NEUROPHYSIOL	1.0-3.0	PREREQ: PERMIS OF INSTR 01 TUT HTBA		STAFF	
BNB	562	NEUROBIO & BEHAV II	3.0	PREREQ: BNB 561 01 LEC TUTH	08:30-09:45	MENDELL	LIFE SCIENCE
BNB	599	RESEARCH	1.0-12.0	01 TUT HTBA		STAFF	
				02 TUT HTBA		CABOT	
				03 TUT HTBA		CARLSON	
				04 TUT HTBA		COHEN	
				05 TUT HTBA		DEBLAS	
				06 TUT HTBA		MATHEWS	
				07 TUT HTBA		MCKELVY	
				08 TUT HTBA		MENDEL	
				09 TUT HTBA		MERRIAM	
				10 TUT HTBA		SCOTT	
				11 TUT HTBA		SHERMAN	
				12 TUT HTBA		TUNIK	
				14 TUT HTBA		YAZULLA	
				17 TUT HTBA		HALEGOUA	

DEPT	COURSE	TITLE	CREDITS	SECT	TYPE	MEETING TIMES	INSTRUCTOR	LOCATION	
BNB	697	ADV NEUROBIO & BEHAV	1.0		PREREQ: PERMISSION OF INSTRUCTOR				
BNB	699	PHD RESEARCH	1.0-12.0	01	SEM	M	04:00-05:00		
				01	TUT	HTBA		STAFF	
				02	TUT	HTBA		CABOT	
				03	TUT	HTBA		CARLSON	
				04	TUT	HTBA		COHEN	
				05	TUT	HTBA		DEBLAS	
				06	TUT	HTBA		MATHEWS	
				07	TUT	HTBA		MCKELVY	
				08	TUT	HTBA		MENDEL	
				09	TUT	HTBA		MERRIAM	
				10	TUT	HTBA		SCOTT	
				11	TUT	HTBA		SHERMAN	
				12	TUT	HTBA		TUNIK	
				14	TUT	HTBA		YAZULLA	
CHE COURSES									
CHE	502	MECH ORG CHEM	3.0	01	LEC	MWF	08:30-09:20	LENOBLE	CHEMISTRY 121
CHE	503	SYNTH ORG CHEM	3.0	01	LEC	MWF	10:30-11:20	BATES	CHEMISTRY 121
CHE	514	TRANSITION METAL CHE	3.0	01	LEC	HTBA		HAIM	
CHE	515	ADVANCED INORGANIC	3.0	01	LEC	M	11:30-12:20	KOCH	CHEMISTRY 121
				01	LEC	W	11:30-01:20		CHEMISTRY 121
CHE	522	QUANT CHEM II	3.0	01	LEC	TUTH	09:55-11:10	PORTER	CHEMISTRY 124
CHE	528	STATISTICAL MECHANICS	3.0	01	LEC	MWF	09:30-10:20	FRIEDMAN	CHEMISTRY 121
CHE	532	SEMINAR	0.0-0.0	01	LEC	MF	12:30-01:20	PRESTWICH	CHEMISTRY 124
CHE	589	DIRECTED STUDY	1.0-3.0	01	TUT	HTBA		ALEXANDER	
				02	TUT	HTBA		BONNER	
				03	TUT	HTBA		CHU	
				04	TUT	HTBA		FOWLER	
				05	TUT	HTBA		FRIEDMAN	
				06	TUT	HTBA		GOLDFARB	
				07	TUT	HTBA		HAIM	
				08	TUT	HTBA		HANSON	
				09	TUT	HTBA		ANDERSON	
				10	TUT	HTBA		JOHNSON	
				11	TUT	HTBA		JOHNSON	
				12	TUT	HTBA		KERBER	
				13	TUT	HTBA		BATES	
				14	TUT	HTBA		BURROWS	
				15	TUT	HTBA		BIGEISEN	
				16	TUT	HTBA		LAUTERBUR	
				17	TUT	HTBA		LE NOBLE	
				18	TUT	HTBA		LAUHER	
				19	TUT	HTBA		HELQUIST	
				20	TUT	HTBA		OKAYA	
				21	TUT	HTBA		PORTER	
				22	TUT	HTBA		RAMIREZ	
				23	TUT	HTBA		SCHNEIDER	
				24	TUT	HTBA		KOCH	
				25	TUT	HTBA		SPRINGER	
				26	TUT	HTBA		STELL	
				27	TUT	HTBA		SUJISHI	
				28	TUT	HTBA		WHITTEN	
				29	TUT	HTBA		WISHNIA	
				30	TUT	HTBA		PRESTWICH	
				31	TUT	HTBA		OJIMA	
				32	TUT	HTBA			
				33	TUT	HTBA		BELL	
				34	TUT	HTBA		ALLEN	
				35	TUT	HTBA		KANDEL	
				37	RBU	HTBA			
				38	TUT	HTBA		ISHIDA	
				39	TUT	HTBA		HERLEY	
CHE	590	M.S. TERM PAPER	3.0	01	TUT	HTBA		ALEXANDER	
				02	TUT	HTBA		BONNER	
				03	TUT	HTBA		CHU	
				04	TUT	HTBA		FOWLER	
				05	TUT	HTBA		FRIEDMAN	
				06	TUT	HTBA		GOLDFARB	
				07	TUT	HTBA		HAIM	
				08	TUT	HTBA		HANSON	
				09	TUT	HTBA		ANDERSON	
				10	TUT	HTBA		JOHNSON	
				11	TUT	HTBA		JOHNSON	
				12	TUT	HTBA		KERBER	
				13	TUT	HTBA		BATES	
				14	TUT	HTBA		BURROWS	
				15	TUT	HTBA		BIGEISEN	
				16	TUT	HTBA		LAUTERBUR	
				17	TUT	HTBA		LE NOBLE	
				18	TUT	HTBA		LAUHER	
				19	TUT	HTBA		HELQUIST	
				20	TUT	HTBA		OKAYA	
				21	TUT	HTBA		PORTER	
				22	TUT	HTBA		RAMIREZ	
				23	TUT	HTBA		SCHNEIDER	
				24	TUT	HTBA		KOCH	
				25	TUT	HTBA		SPRINGER	
				26	TUT	HTBA		STELL	
				27	TUT	HTBA		SUJISHI	
				28	TUT	HTBA		WHITTEN	
				29	TUT	HTBA		WISHNIA	
				30	TUT	HTBA		PRESTWICH	
				31	TUT	HTBA		OJIMA	
				32	TUT	HTBA			
				33	TUT	HTBA		BELL	
				34	TUT	HTBA		ALLEN	
				35	TUT	HTBA		KANDEL	
				37	RBU	HTBA			
				38	TUT	HTBA		ISHIDA	
				39	TUT	HTBA		HERLEY	
CHE	610	PRACT IN TEACHING	1.0-3.0	01	TUT	HTBA			
CHE	611	PRACTICUM IN TEACHNG	0.0-0.0	01	TUT	HTBA			
CHE	695	INORGANIC CHEM SEM	1.0	01	SEM	HTBA			
CHE	696	ORGANIC CHEM SEMINAR	1.0	01	SEM	HTBA			

DEPT	COURSE	TITLE	CREDITS	SECT	TYPE	MEETING TIMES	INSTRUCTOR	LOCATION	
CHE	697	PHYSICAL CHEM SEM	1.0	01	SEM	HTBA			
CHE	698	COLLOQUIUM	1.0-2.0	01	SEM	F	04:00-06:00	OLD CHEM 116	
CHE	699	RESEARCH	1.0-12.0	01	TUT	HTBA	ALEXANDER		
				02	TUT	HTBA	BONNER		
				03	TUT	HTBA	CHU		
				04	TUT	HTBA	FOWLER		
				05	TUT	HTBA	FRIEDMAN		
				06	TUT	HTBA	GOLDFARB		
				07	TUT	HTBA	HAIM		
				08	TUT	HTBA	HANSON		
				09	TUT	HTBA	ANDERSON		
				10	TUT	HTBA	JOHNSON		
				11	TUT	HTBA	JOHNSON		
				12	TUT	HTBA	KERBER		
				13	TUT	HTBA	BATES		
				14	TUT	HTBA	BURROWS		
				15	TUT	HTBA	BIGEISEN		
				16	TUT	HTBA	LAUTERBUR		
				17	TUT	HTBA	LE NOBLE		
				18	TUT	HTBA	LAUHER		
				19	TUT	HTBA	HELQUIST		
				20	TUT	HTBA	OKAYA		
				21	TUT	HTBA	PORTER		
				22	TUT	HTBA	RAMIREZ		
				23	TUT	HTBA	SCHNEIDER		
				24	TUT	HTBA	KOCH		
				25	TUT	HTBA	SPRINGER		
				26	TUT	HTBA	STELL		
				27	TUT	HTBA	SUJISHI		
				28	TUT	HTBA	WHITTEN		
				29	TUT	HTBA	WISHNIA		
				30	TUT	HTBA	PRESTWICH		
				31	TUT	HTBA	OJIMA		
				32	TUT	HTBA			
				33	TUT	HTBA	BELL		
				34	TUT	HTBA	ALLEN		
				35	TUT	HTBA	KANDEL		
				37	RBU	HTBA			
				38	TUT	HTBA	ISHIDA		
				39	TUT	HTBA	HERLEY		
<b>CLT COURSES</b>									
CLT	501	LITERARY THEORY II	3.0						
				01	SEM	W	04:00-06:30	GROSS	
CLT	504	COMP STDS IN GENRE	3.0					MELVILLE LBR E4327	
				01	SEM	TU	04:00-06:30	GABBARD	
CLT	597	DIRECTED READINGS MA	1.0-3.0					MELVILLE LBR E432	
				01	TUT	HTBA	STAFF		
				02	TUT	HTBA	STAFF		
				03	TUT	HTBA	HATHORN		
CLT	599	INDEPENDENT STUDY	1.0-3.0						
				01	TUT	HTBA	STAFF		
				02	TUT	HTBA	STAFF		
CLT	602	INTERDISCIPLINARY SEM	3.0					OLD PHYSICS 205	
CLT	607	MAJOR AUTHORS COMP	3.0						
				01	SEM	TH	04:00-06:30	PETREY	
				01	SEM	M	04:00-06:30	GROSS	
								MELVILLE LBR E4327	
								FREEDMAN	
CLT	690	THESIS RESEARCH	1.0-12.0						
				01	TUT	HTBA	STAFF		
CLT	698	PRACTICUM IN TEACHG	3.0						
				01	TUT	HTBA	STAFF		
CLT	699	DIR READS:PHD CANDID	1.0-12.0						
				01	TUT	HTBA	STAFF		
<b>CSE COURSES</b>									
CSE	503	VLSI DESIGN	4.0						
				01	LEC	TUTH	03:45-05:00	ZORAT	
CSE	504	BIT MICROPROCSR APP	4.0					LGT ENGR LAB 244	
				01	LEC	MW	03:30-04:45	SMITH	
CSE	523	LAB IN COMP SCI I	2.0					LGT ENGR LAB 244	
				01	LEC	HTBA		BERNSTEIN	
CSE	524	LAB IN COMP SCI II	3.0						
				01	LEC	HTBA		BERNSTEIN	
CSE	526	PRIN PROGRAMNG LANG	3.0						
				01	LEC	TUTH	09:55-11:10	SRIVAS	
CSE	528	COMPUTER GRAPHICS	3.0					LGT_ENGR LAB 244	
				01	LEC	HTBA		ZORAT	
CSE	529	SIMULATION & MODELING	3.0						
				01	LEC	TUTH	12:45-02:00	BADR	
CSE	543	COMPUT AND UNDECID	3.0					LGT ENGR LAB 244	
				01	LEC	HTBA		SRIVAS	
CSE	587	IND STUDY COMP-SCI	1.0-4.0						
				01	TUT	HTBA		BADR	
				02	TUT	HTBA		BERNSTEIN	
				03	TUT	HTBA		BUCKLEY	
				04	TUT	HTBA		GELERNTER	
				05	TUT	HTBA		GIACALONE	
				06	TUT	HTBA		HELLER	
				07	TUT	HTBA		HENDERSON	
				08	TUT	HTBA		HSIANG	
				09	TUT	HTBA		KEDEM	
				10	TUT	HTBA		KIFER	

DEPT	COURSE	TITLE	CREDITS	SECT	TYPE	MEETING TIMES	INSTRUCTOR	LOCATION
				11	TUT	HTBA	SCIORE	
				12	TUT	HTBA	SMITH	
				13	TUT	HTBA	SMOLKA	
				14	TUT	HTBA	SRIVAS	
				15	TUT	HTBA	STARK	
				16	TUT	HTBA	WARREN	
				17	TUT	HTBA	WITTIE	
				18	TUT	HTBA	ZORAT	
CSE	599	RESEARCH	1.0-12.0			REMARK: MAY BE REPEATED. S/U GRADING ONLY		
				01	TUT	HTBA	BADR	
				02	TUT	HTBA	BERNSTEIN	
				03	TUT	HTBA	BUCKLEY	
				04	TUT	HTBA	GELERNTER	
				05	TUT	HTBA	GIACALONE	
				06	TUT	HTBA	HELLER	
				07	TUT	HTBA	HENDERSON	
				08	TUT	HTBA	HSIANG	
				09	TUT	HTBA	KEDEM	
				10	TUT	HTBA	KIFER	
				11	TUT	HTBA	SCIORE	
				12	TUT	HTBA	SMITH	
				13	TUT	HTBA	SMOLKA	
				14	TUT	HTBA	SRIVAS	
				15	TUT	HTBA	STARK	
				16	TUT	HTBA	WARREN	
				17	TUT	HTBA	WITTIE	
				18	TUT	HTBA	ZORAT	
CSE	621	SEM PROGRAM LANGUAGE	3.0	01	SEM	HTBA	STARK	
CSE	631	SEM DATABASE SYSTEMS	3.0	01	SEM	HTBA	KIFER	
CSE	681	SP TOP PROG LANGS	3.0	01	SEM	HTBA	GIACALONE	
CSE	682	SP TOP COMP SYS DES	3.0			REMARK: MAY BE REPEATED		
				01	LEC	HTBA	HENDERSON	
CSE	698	PRACTICUM IN TEACH	1.0-3.0			REMARK: MAY BE REPEATED		
CSE	699	RESEARCH	1.0-12.0	01	TUT	HTBA	STAFF	
				02	TUT	HTBA	BADR	
				03	TUT	HTBA	BERNSTEIN	
				04	TUT	HTBA	BUCKLEY	
				05	TUT	HTBA	GELERNTER	
				06	TUT	HTBA	GIACALONE	
				07	TUT	HTBA	HELLER	
				08	TUT	HTBA	HENDERSON	
				09	TUT	HTBA	HSIANG	
				10	TUT	HTBA	KEDEM	
				11	TUT	HTBA	KIFER	
				12	TUT	HTBA	SCIORE	
				13	TUT	HTBA	SMITH	
				14	TUT	HTBA	SMOLKA	
				15	TUT	HTBA	SRIVAS	
				16	TUT	HTBA	STARK	
				17	TUT	HTBA	WARREN	
				18	TUT	HTBA	WITTIE	
							ZORAT	
<b>DLF COURSES</b>								
DLF	601	INTERNSHIP FOR LANG	1.0-3.0			PREREQ: FLUENT KNOWLEDGE OF FRENCH		
				01	SEM	HTBA		
DLF	602	EXTERNSHIP FOR LANG	1.0-3.0			PREREQ: ALL COURSES COMPLETED		
				01	REC	HTBA		
DLF	699	DOCTORAL RESEARCH	1.0-6.0			PREREQ: PRELIMINARY EXAMINATION MUST BE PASSED		
				01	TUT	HTBA		
<b>DLG COURSES</b>								
DLG	601	INTERNSHIP IN FL	1.0-3.0			PREREQ: FLUENT KNOWLEDGE OF GERMAN		
				01	SEM	HTBA	STAFF	
DLG	602	EXTERNSHIP IN FL	1.0-3.0			PREREQ: ALL COURSES COMPLETED		
				01	REC	HTBA	STAFF	
DLG	699	DOCTORAL RESEARCH	1.0-6.0			PREREQ: PRELIMINARY EXAMINATION MUST BE PASSED		
				01	TUT	HTBA	STAFF	
<b>DLI COURSES</b>								
DLI	601	INTERNSHIP	1.0-3.0			PREREQ: FLUENT KNOWLEDGE OF LANGUAGE		
				01	REC	HTBA		
DLI	602	EXTERNSHIP FOR LANG	1.0-3.0			PREREQ: ALL COURSES COMPLETED		
				01	REC	HTBA		
DLI	699	DOCTORAL RESEARCH	1.0-6.0			PREREQ: PRELIMINARY EXAMINATION MUST BE PASSED		
				01	TUT	HTBA		
<b>DLR COURSES</b>								
DLR	601	INTERNSHIP IN FL	1.0-3.0			PREREQ: FLUENT KNOWLEDGE OF LANGUAGE		
				01	SEM	HTBA		
DLR	602	EXTERNSHIP IN FL	1.0-3.0			PREREQ: ALL COURSES COMPLETED		
				01	REC	HTBA	STAFF	
DLR	699	DOCTORAL RESEARCH	1.0-6.0			PREREQ: PRELIMINARY EXAMINATION MUST BE PASSED		
				01	TUT	HTBA	STAFF	
<b>DLS COURSES</b>								
DLS	601	INTERNSHIP FOR LANG	1.0-3.0			PREREQ: FLUENT KNOWLEDGE OF LANGUAGE		
				01	SEM	HTBA	STAFF	
DLS	602	EXTERNSHIP FOR LANG	1.0-3.0			PREREQ: ALL COURSES COMPLETED		
				01	REC	HTBA		
DLS	699	DOCTORAL RESEARCH	1.0-6.0			PREREQ: PRELIMINARY EXAMINATION MUST BE PASSED		
				01	TUT	HTBA	STAFF	
						REMARK: REQUIRED IN DOCTOR OF ARTS PROGRAM		
<b>DLT COURSES</b>								
DLT	601	INTERNSHIP IN TESOL	1.0-3.0			PREREQ: GOOD BACKGROUND IN TESOL		
				01	TUT	HTBA	SRIDHAR	

DEPT	COURSE	TITLE	CREDITS	SECT TYPE	MEETING TIMES	INSTRUCTOR	LOCATION
DLT	602	EXTERNSHIP IN TESOL	1.0-3.0	PREREQ: ALL COURSES COMPLETED FOR THE DA REMARK: S/U GRADING			
				01 TUT	HTBA	SRIDHAR	
DLT	699	DOCTORAL RESEARCH	1.0-6.0	PREREQ: PRELIM MUST BE PASSED			
				01 TUT	HTBA	ANSHEN	
				02 TUT	HTBA	ARONOFF	
				03 TUT	HTBA	CARTON	
				04 TUT	HTBA	BROSELOW	
				06 TUT	HTBA	SRIDHAR	
ECO COURSES							
ECO	501	MICROECONOMICS II	4.0	01 LEC	TUTH	09:55-11:10	WALKER
				01 REC	M	12:30-01:20	STAFF
ECO	511	MACROECONOMICS II	4.0	01 LEC	TUTH	02:15-03:30	NOVALES
				01 REC	W	12:30-01:20	STAFF
ECO	520	MATH STATISTICS	4.0	01 LEC	MWF	10:30-11:20	NAIRAY
				01 REC	F	12:30-01:20	STAFF
ECO	522	APPLIED ECONOMETRICS	3.0	PREREQ: ECO 521			
				01 LEC	TUTH	12:45-02:00	GERTLER
ECO	599	RSCH IN SPEC TOPICS	1.0-12.0	PREREQ: 12 CREDITS IN THE PROGRAM OR PERMISSON OF THE PROGRAM DIRECTOR			SOCBEHAV SCI S632
				01 TUT	HTBA	AMES	
				02 TUT	HTBA	DAWES	
				03 TUT	HTBA	DUSANSKY	
				04 TUT	HTBA	HAUSE	
				05 TUT	HTBA	HENDRICKS	
				06 TUT	HTBA	HOOL	
				07 TUT	HTBA	HURD	
				08 TUT	HTBA	JAMES	
				10 TUT	HTBA	LOCAY	
				12 TUT	HTBA	MUENCH	
				13 TUT	HTBA	NEUBERGER	
				15 TUT	HTBA	SANDERSON	
				16 TUT	HTBA	STALEY	
				17 TUT	HTBA	WALKER	
				18 TUT	HTBA	WILLIS	
				19 TUT	HTBA	WINN	
				21 TUT	HTBA	ZSCHOCK	
				22 TUT	HTBA	ZWEIG	
				24 TUT	HTBA	NAIRAY	
				27 TUT	HTBA	KRISTEIN	
				28 TUT	HTBA	GERTLER	
				29 TUT	HTBA	ANTON	
				30 TUT	HTBA	NOVALES	
				31 TUT	HTBA	WEISS	
				32 TUT	HTBA	COLEMAN	
				33 TUT	HTBA	PORTER	
				34 TUT	HTBA	ROSENTHAL	
				35 TUT	HTBA	MCGUIRE	
ECO	601	ADV MICROECO THRY II	2.0	PREREQ: ECO 600 OR EQUIVALENT			
				01 LEC	MWF	01:30-02:20	HENDRICKS
ECO	609	STUDIES:ECON THEORY	2.0	REMARK: MAY BE REPEATED			
				01 LEC	TUTH	09:55-11:10	ROSENTHAL
ECO	611	ADV MACRO THEORY II	2.0	PREREQ: ECO 610			
				01 LEC	TUTH	11:20-12:35	NOVALES
ECO	621	ADV ECONOMETRICS II	2.0	PREREQ: ECO 620			
				01 LEC	MWF	02:30-03:20	WINN
ECO	622	SEM:APP ECONOMETRICS	2.0	PREREQ: ECO 521 OR PERM OF INST REMARK: FORMERLY ECO 522			
				01 LEC	MWF	12:30-01:20	COLEMAN
ECO	640	LABOR ECO I	2.0	PREREQ: CHECK WITH INSTRUCTOR			
				01 LEC	TUTH	02:15-03:30	WILLIS
ECO	643	DEMOGRAPHIC ECO II	2.0	PREREQ: ECO 500,501			
				01 LEC	MWF	09:30-10:20	LOCAY
ECO	651	INTERNATIONAL FINANC	2.0	01 LEC	TUTH	12:45-02:00	HOOL
ECO	660	COMP ECO SYSTEMS	2.0	01 LEC	TU	03:45-06:15	NEUBERGER
ECO	690	SEMINAR APPLIED ECO	1.0-6.0	REMARK: OPEN TO 2ND & 3RD YEAR STUDENTS IN PHD PROGRAM & FACULTY			
				01 LEC	M	03:30-04:45	PORTER
ECO	691	SEMINAR ECO THEORY	1.0-6.0	REMARK: OPEN TO 2ND & 3RD YR PHD STU AND INTERESTED FACULTY			
				01 LEC	W	03:30-04:45	WALKER
ECO	695	RESEARCH WORKSHOPS	1.0-6.0	PREREQ: THREE SEMESTERS OF COURSE WORK IN THE PH.D. PROGRAM			
				01 SEM	TU	03:45-05:00	MUENCH
				02 SEM	TH	03:45-05:00	SANDERSON
ECO	698	PRACT IN TEACHING	1.0-6.0	REMARK: S/U GRADING			
				01 TUT	HTBA	AMES	
				02 TUT	HTBA	DAWES	
				03 TUT	HTBA	DUSANSKY	
				04 TUT	HTBA	HAUSE	
				05 TUT	HTBA	HENDRICKS	
				06 TUT	HTBA	HOOL	
				07 TUT	HTBA	HURD	
				08 TUT	HTBA	JAMES	
				10 TUT	HTBA	LOCAY	
				12 TUT	HTBA	MEUNCH	
				13 TUT	HTBA	NEUBERGER	
				15 TUT	HTBA	SANDERSON	
				16 TUT	HTBA	STALEY	
				17 TUT	HTBA	WALKER	
				18 TUT	HTBA	WILLIS	
				19 TUT	HTBA	WINN	
				21 TUT	HTBA	ZSCHOCK	
				22 TUT	HTBA	ZWEIG	
				24 TUT	HTBA	NAIRAY	
				27 TUT	HTBA	KRISTEIN	
				28 TUT	HTBA	GERTLER	
				29 TUT	HTBA	ANTON	
				30 TUT	HTBA	NOVALES	
				31 TUT	HTBA	WEISS	
				32 TUT	HTBA	COLEMAN	
				33 TUT	HTBA	PORTER	
				34 TUT	HTBA	ROSENTHAL	
				35 TUT	HTBA	MCGUIRE	

DEPT	COURSE	TITLE	CREDITS	SECT	TYPE	MEETING TIMES	INSTRUCTOR	LOCATION	
ECO	699	THESIS RESEARCH	1.0-9.0	REMARK: S/U GRADING					
				01	TUT	HTBA	AMES		
				02	TUT	HTBA	DAWES		
				03	TUT	HTBA	DUSANSKY		
				04	TUT	HTBA	HAUSE		
				05	TUT	HTBA	HENDRICKS		
				06	TUT	HTBA	HOOB		
				07	TUT	HTBA	HURD		
				08	TUT	HTBA	JAMES		
				10	TUT	HTBA	LOCAY		
				12	TUT	HTBA	MUENCH		
				13	TUT	HTBA	NEUBERGER		
				15	TUT	HTBA	SANDERSON		
				16	TUT	HTBA	STALEY		
				17	TUT	HTBA	WALKER		
				18	TUT	HTBA	WILLIS		
				19	TUT	HTBA	WINN		
				21	TUT	HTBA	ZSCHOCK		
				22	TUT	HTBA	ZWEIG		
				24	TUT	HTBA	NAIRAY		
				27	TUT	HTBA	KRISTEIN		
				28	TUT	HTBA	GERTLER		
				29	TUT	HTBA	ANTON		
				30	TUT	HTBA	NOVALES		
				31	TUT	HTBA	WEISS		
				32	TUT	HTBA	COLEMAN		
				33	TUT	HTBA	PORTER		
				34	TUT	HTBA	ROSENTHAL		
				35	TUT	HTBA	MCGUIRE		
<b>EGL COURSES</b>									
EGL	503	STUDIES IN MILTON	3.0	01	LEC	TU 04:00-06:30	PEQUIGNEY	HUMANITIES	237
EGL	505	STUDIES IN GENRE	3.0	REMARK: SEC 1:SHORT STORY; SEC 2:SHAW					
				01	LEC	TH 07:00-09:30PM	FORTUNA	HUMANITIES	237
EGL	535	STUD IN NEOCLASSICSM	3.0	REMARK: RISE OF THE NOVEL					
				01	LEC	TU 04:00-06:30	MARESCA	HUMANITIES	237
EGL	540	ROMANTICISM	3.0	REMARK: ROMANTIC LYRIC					
				01	LEC	M 04:00-06:30	ERDMAN	HUMANITIES	318
EGL	550	20TH C BRITISH LIT	3.0	01	LEC	M 07:00-09:30PM	SIMPSON	HUMANITIES	237
EGL	565	AMERICAN RENAISSANCE	3.0	01	LEC	M 04:00-06:30	NEWLIN	HUMANITIES	237
EGL	581	FICTION WORKSHOP	3.0	PREREQ: ADMISSION TO THE M.A.PROGRAM IN CREATIVE WRITING					
				01	TUT	W 07:00-09:30PM	FLANAGAN	HUMANITIES	320
EGL	583	NON-FICTION WORKSHOP	3.0	PREREQ: ADMISSION TO THE MA PROGRAM IN CREATIVE WRITING					
				REMARK: ART OF THE ESSAY					
				01	TUT	TH 04:00-06:30	JORDAN	HUMANITIES	320
EGL	585	CREATIVE WRTG PROJCT	1.0-12.0	PREREQ: COMPLETION OF FIRST FULL YEAR OF MA PROGRAM IN CREATIVE WRITING					
				13	TUT	HTBA	HARVEY		
				19	TUT	HTBA	LUDWIG		
				22	TUT	HTBA	NEWLIN		
				31	TUT	HTBA	SIMPSON		
				46	TUT	HTBA	GROSS		
				55	TUT	HTBA	FLANAGAN		
				57	TUT	HTBA	HARRIS		
				58	TUT	HTBA	JORDAN		
				62	TUT	HTBA	COOPER		
EGL	597	METHODS IN RESEARCH	1.0-12.0	03	TUT	HTBA	BASHFORD		
				07	TUT	HTBA	DOLAN		
				08	TUT	HTBA	ERDMAN		
				09	TUT	HTBA	FIESS		
				11	TUT	HTBA	FRY		
				13	TUT	HTBA	HARVEY		
				15	TUT	HTBA	HUFFMAN		
				16	TUT	HTBA	KRANIDAS		
				17	TUT	HTBA	LEVIN		
				18	TUT	HTBA	LEVINE		
				19	TUT	HTBA	LUDWIG		
				20	TUT	HTBA	MILLER		
				22	TUT	HTBA	NEWLIN		
				23	TUT	HTBA	PEGUIGNEY		
				25	TUT	HTBA	ROGERS		
				28	TUT	HTBA	SEARS		
				30	TUT	HTBA	SHEEHAN		
				31	TUT	HTBA	SIMPSON		
				32	TUT	HTBA	SPECTOR		
				33	TUT	HTBA	STAMPFER		
				38	TUT	HTBA	WILSON		
				39	TUT	HTBA	ZIMBARDO		
				40	TUT	HTBA	GOLDBERG		
				41	TUT	HTBA	FORTUNA		
				42	TUT	HTBA	MARESCA		
				45	TUT	HTBA	SCHEPS		
				46	TUT	HTBA	GROSS		
				47	TUT	HTBA	ALTIZER		
				49	TUT	HTBA	LIPTON		
				51	TUT	HTBA	SQUIER		
				52	TUT	HTBA	KESSNER		
				54	TUT	HTBA	HARADA		
				55	TUT	HTBA	FLANAGAN		
				56	TUT	HTBA	LAURENCE		
				57	TUT	HTBA	HARRIS		
				58	TUT	HTBA	JORDAN		
				62	TUT	HTBA	COOPER		
				65	TUT	HTBA	OLSTER		
				66	TUT	HTBA	ELBOW		
				67	TUT	HTBA	MUNICH		
				69	TUT	HTBA	BIALOSTOSK		
				70	TUT	HTBA	BELANOFF		
				71	TUT	HTBA	SPRINKER		
				72	TUT	HTBA	FONTAINE		
EGL	599	INDEPENDENT STUDIES	3.0	03	TUT	HTBA	BASHFORD		
				07	TUT	HTBA	DOLAN		
				08	TUT	HTBA	ERDMAN		
				09	TUT	HTBA	FIESS		
				11	TUT	HTBA	FRY		
				13	TUT	HTBA	HARVEY		
				15	TUT	HTBA	HUFFMAN		
				16	TUT	HTBA	KRANIDAS		
				17	TUT	HTBA	LEVIN		
				18	TUT	HTBA	LEVINE		
				19	TUT	HTBA	LUDWIG		
				20	TUT	HTBA	MILLER		
				22	TUT	HTBA	NEWLIN		
				23	TUT	HTBA	PEGUIGNEY		

DEPT	COURSE	TITLE	CREDITS	SECT	TYPE	MEETING TIMES	INSTRUCTOR	LOCATION	
				25	TUT	HTBA	ROGERS		
				28	TUT	HTBA	SEARS		
				30	TUT	HTBA	SHEEHAN		
				31	TUT	HTBA	SIMPSON		
				32	TUT	HTBA	SPECTOR		
				33	TUT	HTBA	STAMPFER		
				38	TUT	HTBA	WILSON		
				39	TUT	HTBA	ZIMBARDO		
				40	TUT	HTBA	GOLDBERG		
				41	TUT	HTBA	FORTUNA		
				42	TUT	HTBA	MARESCA		
				45	TUT	HTBA	SCHEPS		
				46	TUT	HTBA	GROSS		
				47	TUT	HTBA	ALTIZER		
				49	TUT	HTBA	LIPTON		
				51	TUT	HTBA	SQUIRE		
				52	TUT	HTBA	KESSNER		
				54	TUT	HTBA	HARADA		
				55	TUT	HTBA	FLANAGAN		
				56	TUT	HTBA	LAURENCE		
				57	TUT	HTBA	HARRIS		
				58	TUT	HTBA	JORDAN		
				62	TUT	HTBA	COOPER		
				65	TUT	HTBA	OLSTER		
				66	TUT	HTBA	ELBOW		
				67	TUT	HTBA	MUNICH		
				69	TUT	HTBA	BIALOSTOSK		
				70	TUT	HTBA	BELANOFF		
				71	TUT	HTBA	SPRINKER		
				72	TUT	HTBA	FONTAINE		
EGL	606	PERIOD & TRADITION	3.0			REMARK: SEC 1:MEDIEVAL; SEC 2:POLITICS & LIT; SEC 3:VICTORIAN; SEC 4:PURITAN			
				02	SEM	M	07:00-09:30PM	HUMANITIES	320
				03	SEM	W	04:00-06:30	HUMANITIES	320
				04	SEM	TU	07:00-09:30PM	HUMANITIES	320
EGL	607	INDIVIDUAL AUTHORS	3.0			REMARK: SEC 1:JOHNSON; SEC 2:JOYCE; SEC 3:FAULKNER & STEVENS			
				02	SEM	TU	04:00-06:30	HUMANITIES	320
				03	SEM	W	02:30-05:00	HUMANITIES	237
EGL	611	EGL LIT PRO-SEM II	3.0			REMARK: CRITICAL THEORY			
				01	SEM	TH	04:00-06:30	OLD PHYSICS	205
EGL	612	THEORIES IN COMP	3.0						
EGL	690	THESIS RESEARCH	1.0-12.0					HUMANITIES	320
				03	TUT	HTBA	BASHFORD		
				07	TUT	HTBA	DOLAN		
				08	TUT	HTBA	ERDMAN		
				09	TUT	HTBA	FIESS		
				11	TUT	HTBA	FRY		
				13	TUT	HTBA	HARVEY		
				15	TUT	HTBA	HUFFMAN		
				16	TUT	HTBA	KRANIDAS		
				17	TUT	HTBA	LEVIN		
				18	TUT	HTBA	LEVINE		
				19	TUT	HTBA	LUDWIG		
				20	TUT	HTBA	MILLER		
				22	TUT	HTBA	NEWLIN		
				23	TUT	HTBA	PEGUIGNEY		
				25	TUT	HTBA	ROGERS		
				28	TUT	HTBA	SEARS		
				29	TUT	HTBA	SHAW		
				30	TUT	HTBA	SHEEHAN		
				31	TUT	HTBA	SIMPSON		
				32	TUT	HTBA	SPECTOR		
				33	TUT	HTBA	STAMPFER		
				38	TUT	HTBA	WILSON		
				39	TUT	HTBA	ZIMBARDO		
				40	TUT	HTBA	GOLDBERG		
				41	TUT	HTBA	FORTUNA		
				42	TUT	HTBA	MARESCA		
				45	TUT	HTBA	SCHEPS		
				46	TUT	HTBA	GROSS		
				47	TUT	HTBA	ALTIZER		
				49	TUT	HTBA	LIPTON		
				51	TUT	HTBA	SQUIRE		
				52	TUT	HTBA	KESSNER		
				54	TUT	HTBA	HARADA		
				55	TUT	HTBA	FLANAGAN		
				56	TUT	HTBA	LAURENCE		
				57	TUT	HTBA	HARRIS		
				58	TUT	HTBA	JORDAN		
				62	TUT	HTBA	COOPER		
				65	TUT	HTBA	OLSTER		
				66	TUT	HTBA	ELBOW		
				67	TUT	HTBA	MUNICH		
				69	TUT	HTBA	BIALOSTOSK		
				70	TUT	HTBA	BELANOFF		
				71	TUT	HTBA	SPRINKER		
				72	TUT	HTBA	FONTAINE		
EGL	698	PRAC TEACHING LIT	3.0						
EGL	699	DIRECTED READING	1.0-12.0					HUMANITIES	317
				01	TUT	MW	12:45-02:00		
				03	TUT	HTBA	BASHFORD		
				07	TUT	HTBA	DOLAN		
				08	TUT	HTBA	ERDMAN		
				09	TUT	HTBA	FIESS		
				11	TUT	HTBA	FRY		
				13	TUT	HTBA	HARVEY		
				14	TUT	HTBA	LEVY		
				15	TUT	HTBA	HUFFMAN		
				16	TUT	HTBA	KRANIDAS		
				17	TUT	HTBA	LEVIN		
				18	TUT	HTBA	LEVINE		
				19	TUT	HTBA	LUDWIG		
				20	TUT	HTBA	MILLER		
				22	TUT	HTBA	NEWLIN		
				23	TUT	HTBA	PEGUIGNEY		
				25	TUT	HTBA	ROGERS		
				28	TUT	HTBA	SEARS		
				30	TUT	HTBA	SHEEHAN		
				31	TUT	HTBA	SIMPSON		
				32	TUT	HTBA	SPECTOR		
				33	TUT	HTBA	STAMPFER		
				38	TUT	HTBA	WILSON		
				39	TUT	HTBA	ZIMBARDO		
				40	TUT	HTBA	GOLDBERG		
				41	TUT	HTBA	FORTUNA		
				42	TUT	HTBA	MARESCA		
				45	TUT	HTBA	SCHEPS		
				46	TUT	HTBA	GROSS		
				47	TUT	HTBA	ALTIZER		
				49	TUT	HTBA	LIPTON		
				51	TUT	HTBA	SQUIRE		
				52	TUT	HTBA	KESSNER		



DEPT	COURSE	TITLE	CREDITS	SECT	TYPE	MEETING TIMES	INSTRUCTOR	LOCATION		
				54	TUT	HTBA	HARADA			
				55	TUT	HTBA	FLANAGAN			
				56	TUT	HTBA	LAURENCE			
				57	TUT	HTBA	HARRIS			
				58	TUT	HTBA	JORDAN			
				62	TUT	HTBA	COOPER			
				65	TUT	HTBA	OLSTER			
				66	TUT	HTBA	ELBOW			
				67	TUT	HTBA	MUNICH			
				69	TUT	HTBA	BIALOSTOSK			
				70	TUT	HTBA	BELANOFF			
				71	TUT	HTBA	SPRINKER			
				72	TUT	HTBA	FONTAINE			
<b>EMP COURSES</b>										
EMP	502	ACCTG & FIN DEC ANAL	3.0	REMARK: TO BE GIVEN AT SUATC FARMINGDALE						
				01	LEC	W	07:00-10:00PM	BRAWERMAN		
EMP	509	MANAGEMENT INFO SYS	3.0	REMARK: CROSSLISTED WITH CEY 509						
				01	LEC	TH	07:00-10:00PM	FUCHEL	LGT ENGR LAB 154	
EMP	517	QUALITY MANAGEMENT	3.0	01	LEC	TU	07:00-09:30PM	CAPLAN	LGT ENGR LAB 154	
EMP	588	TECH COMMUNICATION	3.0	REMARK: CROSSLISTED WITH EST 588						
				01	SEM	TU	06:30-09:00PM	SPANIER	ENGINEERING 112	
<b>ESC COURSES</b>										
ESC	501	HEAT CONVECTION	3.0	01	LEC	TUTH	11:20-12:35	KARNI	LGT ENGR LAB 254	
ESC	514	INTRO TO TURBULENCE	3.0	01	LEC	TUTH	09:55-11:10	O'BRIEN	LGT ENGR LAB 254	
ESC	523	ATMOS.MOLEC.PROC.	3.0	01	LEC	TUTH	03:45-05:00	VARANASI	LGT ENGR LAB 254	
ESC	543	PLASTICITY	3.0	01	LEC	TUTH	12:45-02:00	RUBINSTEIN	LGT ENGR LAB 248	
ESC	545	THEOR METEOROLOGY I	3.0	01	LEC	TUTH	05:15-06:30	HOGAN	LGT ENGR LAB 254	
ESC	592	CLASSICAL THERMO	3.0	01	LEC	MWF	02:30-03:20	WANG	LGT ENGR LAB 254	
ESC	596	MECH ENG DES MS PROJ	3.0	PREREQ: ESC 525,526; PERM OF INST						
				REMARK: S/U GRADING; WILL MEET AT GRUMMAN						
				01	TUT	TUTH	05:00-08:00			
ESC	599	RESEARCH	1.0-12.0	01	TUT	HTBA		BERLAD		
				02	TUT	HTBA		ALANKUS		
				03	TUT	HTBA		CESS		
				04	TUT	HTBA		DRUBKA		
				05	TUT	HTBA		CHIANG		
				06	TUT	HTBA		HARRIS		
				07	TUT	HTBA		IRVINE		
				08	TUT	HTBA		LEE		
				09	TUT	HTBA		O'BRIEN		
				10	TUT	HTBA		STELL		
				11	TUT	HTBA		TASI		
				12	TUT	HTBA		VARANASI		
				13	TUT	HTBA		WANG		
				14	TUT	HTBA		YANG		
				15	TUT	HTBA		FOX		
				16	TUT	HTBA		HOGAN		
				17	TUT	HTBA		KARNI		
				18	TUT	HTBA		HAMEED		
				19	TUT	HTBA		LEE		
				20	TUT	HTBA		RUBINSTEIN		
ESC	621	COMBUSTION THEORY	3.0	01	LEC	MW	03:30-04:45	YANG	LGT ENGR LAB 254	
ESC	671	OPT METH EXP STR ANA	3.0	01	LEC	TU	05:30-08:00	CHIANG	HVY ENGR LAB 201	
ESC	696	SPEC PROB IN MECH	3.0	01	TUT	HTBA				
				02	TUT	HTBA				
				03	TUT	HTBA				
				04	TUT	HTBA				
				05	TUT	HTBA				
				06	TUT	HTBA				
				07	TUT	HTBA				
				08	TUT	HTBA				
				09	TUT	HTBA				
				10	TUT	HTBA				
				11	TUT	HTBA				
				12	TUT	HTBA				
				13	TUT	HTBA				
				14	TUT	HTBA		WANG		
				15	TUT	HTBA		FOX		
				16	TUT	HTBA		KARNI		
				17	TUT	HTBA		HAMEED		
				18	TUT	HTBA		LEE		
				19	TUT	HTBA		RUBINSTEIN		
ESC	698	PRACTICUM IN TCHNG	3.0	01	TUT	HTBA		BERLAD		
				02	TUT	HTBA		ALANKUS		
				03	TUT	HTBA		CESS		
				04	TUT	HTBA		DRUBKA		
				05	TUT	HTBA		CHIANG		
				06	TUT	HTBA		HARRIS		
				07	TUT	HTBA		IRVINE		
				08	TUT	HTBA		LEE	LGT ENGR LAB 103	
				09	TUT	HTBA		O'BRIEN		
				10	TUT	HTBA		STELL		
				11	TUT	HTBA		TASI		
				12	TUT	HTBA		VARANASI		
				13	TUT	HTBA		WANG		
ESC	699	RESEARCH	1.0-12.0	01	TUT	HTBA				
				02	TUT	HTBA				
				03	TUT	HTBA				
				04	TUT	HTBA				
				05	TUT	HTBA				
				06	TUT	HTBA				
				07	TUT	HTBA				
				08	TUT	HTBA				
				09	TUT	HTBA				
				10	TUT	HTBA				
				11	TUT	HTBA				
				12	TUT	HTBA				
				13	TUT	HTBA				

DEPT	COURSE	TITLE	CREDITS	SECT	TYPE	MEETING TIMES	INSTRUCTOR	LOCATION			
				14	TUT	HTBA	YANG				
				15	TUT	HTBA	FOX				
				16	TUT	HTBA	HOGAN				
				17	TUT	HTBA	KARNI				
				18	TUT	HTBA	HAMEED				
				19	TUT	HTBA	LEE				
				20	TUT	HTBA	RUBINSTEIN				
<b>ESE COURSES</b>											
ESE	504	CONGESTION & DELAY	3.0	01	LEC	TH 06:00-08:30PM	CHOUDHURY	ENGINEERING	114		
ESE	507	ELEC DEV CKT&SYS I I	0.0-3.0	PREREQ: PERMISSION OF GRADUATE PROGRAM CHAIRMAN REMARK: NOT FOR STUDENTS WITH UNDERGRADUATE DEGREE IN ELEC ENGINEERING							
				01	LEC	M 06:00-08:30PM	WATERS	LGT ENGR LAB	244		
ESE	512	SOLID-STATE ELECT II	3.0	01	LEC	TUTH 08:30-09:45	MARSOCCI	LGT ENGR LAB	244		
ESE	520	ELEC II:FUND ELECMAG	3.0	01	LEC	TU 07:00-09:30PM	PAREKH	LGT ENGR LAB	244		
ESE	530	COMPUTER-AIDED DESIG	3.0	PREREQ: BS IN EE							
				01	LEC	TUTH 12:45-02:00	SUSSMAN-FO	LGT ENGR LAB	246		
ESE	531	THRY-DIGIT COMMUN I	3.0	PREREQ: ESE 503 OR PERMIS OF INSTR							
				01	LEC	MW 06:00-07:15PM	UCCI	LGT ENGR LAB	248		
ESE	544	OPTIMAL FILTERING	3.0	01	LEC	TUTH 02:15-03:30	YEH	LGT ENGR LAB	248		
ESE	545	COMPUTER ARCHITECTUR	4.0	PREREQ: ESE 318							
				01	LEC	TUTH 03:45-05:00	ROBERTAZZI	LGT ENGR LAB	248		
ESE	556	NONLIN DSCRT TIME SY	3.0	REMARK: CROSSLISTED WITH AMS 563							
				01	LEC	MWF 02:30-03:20	ZEMANIAN	LGT ENGR LAB	248		
ESE	557	DIGITL SIGNAL PROC II	3.0	PREREQ: ESE 347 OR 547 OR PERMISSION OF INSTRUCTOR							
				01	LEC	W 06:00-08:30PM	PASHTOON	LGT ENGR LAB	254		
ESE	560	OPTICAL INFO PROC I	3.0	PREREQ: BACHELOR'S DEG OR EQUIV IN PHY,MATH,ENG'G OR BIOLOGICAL SCIENCES.							
				01	LEC	TUTH 02:15-03:30	DHADWAL	LGT ENGR LAB	244		
ESE	564	FUND ROBOTICS II	3.0	PREREQ: PERMISSION OF INSTRUCTOR							
				01	LEC	M 06:00-08:30PM	ESLAMI	LGT ENGR LAB	246		
ESE	597	PRACTICUM:ENGINEERIN	1.0-3.0	01	TUT	HTBA	SHAPIRO	LGT ENGR LAB	205		
				03	TUT	HTBA	CARLETON				
				04	TUT	HTBA	CHANG				
				05	TUT	HTBA	CHEN				
				08	TUT	HTBA	MARSOCCI				
				09	TUT	HTBA	RAPPAPORT				
				10	TUT	HTBA	SHORT				
				11	TUT	HTBA	SMITH				
				14	TUT	HTBA	TRUXAL				
				15	TUT	HTBA	TUAN				
				20	TUT	HTBA					
				21	TUT	HTBA	ZEMANIAN				
				23	TUT	HTBA	UCCI				
				24	TUT	HTBA	ESLAMI	LGT ENGR LAB	217		
				25	TUT	HTBA	SUSSMAN-FO	LGT ENGR LAB	225		
				26	TUT	HTBA	PAREKH				
				27	TUT	HTBA	PASHTOON	LGT ENGR LAB	225		
				28	TUT	HTBA	HANTGAN				
				29	TUT	HTBA	LILLY				
				30	LEC	HTBA					
				31	TUT	HTBA	ROBERTAZZI				
				32	TUT	HTBA	YEH				
				33	TUT	HTBA	CHOUDHURY				
				34	TUT	HTBA	DHADWAL				
				35	TUT	HTBA	MURRAY				
ESE	599	RESEARCH	1.0-12.0	01	TUT	HTBA	SHAPIRO	LGT ENGR LAB	205		
				03	TUT	HTBA	CARLETON				
				04	TUT	HTBA	CHANG				
				05	TUT	HTBA	CHEN				
				08	TUT	HTBA	MARSOCCI				
				09	TUT	HTBA	RAPPAPORT				
				10	TUT	HTBA	SHORT				
				11	TUT	HTBA	SMITH				
				14	TUT	HTBA	TRUXAL				
				15	TUT	HTBA	TUAN				
				20	TUT	HTBA					
				21	TUT	HTBA	ZEMANIAN				
				23	TUT	HTBA	UCCI				
				24	TUT	HTBA	ESLAMI	LGT ENGR LAB	217		
				25	TUT	HTBA	SUSSMAN-FO	LGT ENGR LAB	225		
				26	TUT	HTBA	PAREKH				
				27	TUT	HTBA	PASHTOON				
				28	TUT	HTBA	HANTGAN				
				29	TUT	HTBA	LILLY				
				30	TUT	HTBA	BAJPAI				
				31	TUT	HTBA	ROBERTAZZI				
				32	TUT	HTBA	YEH				
				33	TUT	HTBA	CHOUDHURY				
				34	TUT	HTBA	DHADWAL				
				35	TUT	HTBA	MURRAY				
ESE	670	TOPICS IN ELEC SCI	0.0-3.0	PREREQ: SEC 4-ESE 502,503; SEC 9-ESE 503,504,531; PERM OF INSTRUC REMARK: 4:ARTFCL INTEL;9:MOBL COMUN SYS;L5:SEMCON ELEC II;32:SPEC EST&DIRC							
				04	LEC	MW 03:30-04:45	CHANG	LGT ENGR LAB	248		
				09	LEC	TUTH 03:45-05:00	RAPPAPORT	LGT ENGR LAB	154		
				15	LEC	M 06:00-08:30PM	TUAN	LGT ENGR LAB	254		
				32	LEC	TUTH 05:30-06:45	YEH	LGT ENGR LAB	246		
ESE	698	PRACTICUM IN TCHNG	1.0-3.0	01	TUT	HTBA	SHAPIRO	LGT ENGR LAB	205		
				03	TUT	HTBA	CARLETON				
				04	TUT	HTBA	CHANG				
				05	TUT	HTBA	CHEN				
				08	TUT	HTBA	MARSOCCI				
				09	TUT	HTBA	RAPPAPORT				
				10	TUT	HTBA	SHORT				
				11	TUT	HTBA	SMITH				
				14	TUT	HTBA	TRUXAL				
				15	TUT	HTBA	TUAN				
				20	TUT	HTBA	ADMN. STAF				
				22	TUT	HTBA					
				23	TUT	HTBA	ZEMANIAN				
				24	TUT	HTBA	UCCI				
				26	TUT	HTBA	ESLAMI	LGT ENGR LAB	217		
				27	TUT	HTBA	SUSSMAN-FO	LGT ENGR LAB	225		
				28	TUT	HTBA	PAREKH				
				29	TUT	HTBA	PASHTOON				
				30	TUT	HTBA	HANTGAN				
				31	TUT	HTBA	ROBERTAZZI				
							LILLY				
				32	TUT	HTBA	BAJPAI				
				33	TUT	HTBA	ROBERTAZZI				

DEPT	COURSE	TITLE	CREDITS	SECT	TYPE	MEETING TIMES	INSTRUCTOR	LOCATION								
ESE	699	RESEARCH	1.0-12.0	34	TUT	HTBA	YEH	LGT ENGR LAB	205							
				35	TUT	HTBA	CHOU DHURY									
				36	TUT	HTBA	DHADWAL									
				37	TUT	HTBA	MURRAY									
				01	TUT	HTBA	SHAPIRO									
				03	TUT	HTBA	CARLETON									
				04	TUT	HTBA	CHANG									
				05	TUT	HTBA	CHEN									
				08	TUT	HTBA	MARSOCCI									
				09	TUT	HTBA	RAPPAPORT									
				10	TUT	HTBA	SHORT									
				11	TUT	HTBA	SMITH									
				14	TUT	HTBA	TRUXAL									
				15	TUT	HTBA	TUAN									
				20	TUT	HTBA										
				21	TUT	HTBA	ZEMANIAN									
				23	TUT	HTBA	UCCI									
				24	TUT	HTBA	ESLAMI									
				25	TUT	HTBA	SUSSMAN-FO									
				26	TUT	HTBA	PAREKH									
27	TUT	HTBA	PASHTOON													
28	TUT	HTBA	HANTGAN													
29	TUT	HTBA	LILLY													
30	TUT	HTBA	BAJPAI													
32	TUT	HTBA	YEH													
33	TUT	HTBA	CHOU DHURY													
34	TUT	HTBA	DHADWAL													
35	TUT	HTBA	MURRAY													
<b>ESM COURSES</b>																
ESM	504	PRODUCTION PROCESSES	3.0	01	LEC	HTBA	HERMAN									
ESM	510	KINETIC PROCES SOLID	3.0	01	LEC	HTBA										
ESM	515	PHASE TRANSFORMATION	3.0	PREREQ: ESG 332												
ESM	599	RESEARCH	1.0-12.0	01	LEC	MWF	02:30-03:20	ENGINEERING	110							
				01	TUT	HTBA										
				02	TUT	HTBA										
				03	TUT	HTBA										
				04	TUT	HTBA										
				05	TUT	HTBA										
				06	TUT	HTBA										
				08	TUT	HTBA										
				09	TUT	HTBA										
				10	TUT	HTBA										
				12	TUT	HTBA										
				13	TUT	HTBA										
				14	TUT	HTBA										
				16	TUT	HTBA										
				ESM	607	IMPERFECTIONS	3.0			PREREQ: PERM OF INSTRUCTOR						
				ESM	696	PROBLEMS IN MAT SCI	3.0			01	LEC	TUTH	03:45-05:00	ENGINEERING	110	
01	TUT	HTBA														
02	TUT	HTBA														
03	TUT	HTBA														
04	TUT	HTBA														
05	TUT	HTBA														
06	TUT	HTBA														
08	TUT	HTBA														
09	TUT	MW	03:30-04:45													
10	TUT	HTBA														
12	TUT	HTBA														
13	TUT	HTBA														
14	TUT	HTBA														
16	TUT	HTBA														
ESM	697	ESM COLLOQ	1.0					01	SEM	HTBA	WANG					
ESM	698	PRACTICUM IN TCHNG	0.0-3.0					REMARK: S/U GRADING; MAY BE REPEATED								
ESM	699	RESEARCH	1.0-12.0	01	TUT	HTBA		ENGINEERING	114							
				01	TUT	HTBA										
				02	TUT	HTBA										
				03	TUT	HTBA										
				04	TUT	HTBA										
				05	TUT	HTBA										
				06	TUT	HTBA										
				08	TUT	HTBA										
				09	TUT	HTBA										
				10	TUT	HTBA										
				12	TUT	HTBA										
				13	TUT	HTBA										
				14	TUT	HTBA										
				16	TUT	HTBA										
				<b>ESS COURSES</b>												
				ESS	505	EXP. PETROLOGY LAB	1.0			PREREQ: PERMIS OF INSTR						
ESS	511	ADV PALEONTOLOGY	3.0	01	LAB	TU	12:45-05:00	LINDSLEY	EARTH&SPACE	243						
ESS	518	CARBONATE SEDIMENTS	4.0	01	LEC	HTBA		BRETSKY	EARTH&SPACE	TBA						
PREREQ: SEDIMENTARY PETROLOGY																
ESS	521	ISOTOPE GEOLOGY	3.0	01	LEC	MWF	12:30-01:20	MEYERS	EARTH&SPACE	222						
				01	LAB	TU	02:15-05:00		EARTH&SPACE	267						
				01	LEC	MWF	11:30-12:20	HANSON	EARTH&SPACE	222						
				01	LEC	TUTH	09:55-11:10	REEDER	EARTH&SPACE	177						
				01	LEC	TUTH	11:20-12:35	PREWITT	EARTH&SPACE	177						
ESS	528	CARBONATE GEOCHEM	3.0	01	LAB	TH	02:15-05:00		EARTH&SPACE	273						
ESS	531	CRYSTALLINE SOLIDS	3.0	PREREQ: ESS 201 OR EQUIV. STUD. W. DEFICIENT MINEROLOGY MAY AUDIT ESS 201												
ESS	543	LAB CRSE ASTRO TECH	4.0	01	LAB	HTBA		PETERSON	EARTH&SPACE	TBA						
				01	LAB	HTBA			EARTH&SPACE	TBA						
				01	LEC	TUTH	12:45-02:00	THURBER	EARTH&SPACE	183						
ESS	552	PHYS OF THE EARTH II	3.0	PREREQ: ESS 352 OR EQUIVALENT OR PERMIS OF INSTR												
ESS	556	SOLID STATE GEOPHYSI	3.0	PREREQ: ESS 551 & 552 OR PERMISSION OF INSTRUCTOR												
ESS	570	EARTHQUAKE MECHANICS	3.0	01	LEC	MWF	09:30-10:20	LIEBERMAN	EARTH&SPACE	322						
				01	LEC	MWF	11:30-12:20	WONG	EARTH&SPACE	322						
ESS	599	RESEARCH	1.0-12.0	REMARK: STUDENTS NOT ON DEPT APPROVAL LIST WILL BE DEREGISTERED												
				02	TUT	HTBA		BOHLEN								
				03	TUT	HTBA		BRETSKY								
				04	TUT	HTBA		THURBER								
				05	TUT	HTBA		DODD								
				06	TUT	HTBA		COMER								

DEPT	COURSE	TITLE	CREDITS	SECT	TYPE	MEETING TIMES	INSTRUCTOR	LOCATION	
				07	TUT	HTBA	YAHIL		
				08	TUT	HTBA	WONG		
				09	TUT	HTBA	HANSON		
				10	TUT	HTBA	HARDORP		
				11	TUT	HTBA	KNACKE		
				12	TUT	HTBA	LIEBERMANN		
				13	TUT	HTBA	LINDSLEY		
				14	TUT	HTBA	LATTIMER		
				15	TUT	HTBA	MEYERS		
				16	TUT	HTBA	OWEN		
				18	TUT	HTBA	SHARP		
				19	TUT	HTBA	PETERSON		
				20	TUT	HTBA	PREWITT		
				21	TUT	HTBA	CERCONE		
				22	TUT	HTBA	SIMON		
				23	TUT	HTBA	SOLOMON		
				24	TUT	HTBA	WEIDNER		
				25	TUT	HTBA	REEDER		
				26	TUT	HTBA	FORMAN		
				27	TUT	HTBA	CALDWELL		
				30	TUT	HTBA	CALDWELL		
ESS	600	PRACTICUM IN TCHNG	1.0-3.0	REMARK: STUDENTS NOT ON DEPT APPROVAL LIST WILL BE DEREGISTERED					
				02	TUT	HTBA	BOHLEN		
				03	TUT	HTBA	BRETSKY		
				04	TUT	HTBA	THURBER		
				05	TUT	HTBA	DODD		
				06	TUT	HTBA	COMER		
				07	TUT	HTBA	YAHIL		
				08	TUT	HTBA	WONG		
				09	TUT	HTBA	HANSON		
				10	TUT	HTBA	HARDORP		
				11	TUT	HTBA	KNACKE		
				13	TUT	HTBA	LINDSLEY		
				14	TUT	HTBA	LATTIMER		
				15	TUT	HTBA	MEYERS		
				16	TUT	HTBA	OWEN		
				18	TUT	HTBA	SHARP		
				19	TUT	HTBA	PETERSON		
				20	TUT	HTBA	PREWITT		
				21	TUT	HTBA	CERCONE		
				22	TUT	HTBA	SIMON		
				23	TUT	HTBA	SOLOMON		
				24	TUT	HTBA	WEIDNER		
				25	TUT	HTBA	REEDER		
				30	TUT	HTBA	CALDWELL		
ESS	603	TOPICS IN PETROLOGY	1.0-3.0	09	SEM	HTBA	HANSON	EARTH&SPACE TBA	
ESS	605	# SED BASIN SEM	1.0-3.0	21	SEM	MWF 09:30-10:20	CERCONE	EARTH&SPACE 177	
ESS	607	# PLATE TECTONICS	1.0-3.0	06	SEM	HTBA	COMER	EARTH&SPACE TBA	
ESS	612	SEM ASTRO/ASTRO PHYS	3.0	30	SEM	HTBA	CALDWELL	EARTH&SPACE TBA	
ESS	699	THESIS RESEARCH	1.0-12.0	REMARK: STUDENTS NOT ON DEPT APPROVAL LIST WILL BE DEREGISTERED					
				02	TUT	HTBA	BOHLEN		
				03	TUT	HTBA	BRETSKY		
				04	TUT	HTBA	THURBER		
				05	TUT	HTBA	DODD		
				06	TUT	HTBA	COMER		
				07	TUT	HTBA	YAHIL		
				08	TUT	HTBA	WONG		
				09	TUT	HTBA	HANSON		
				10	TUT	HTBA	HARDORP		
				11	TUT	HTBA	KNACKE		
				12	TUT	HTBA	LIEBERMANN		
				13	TUT	HTBA	LINDSLEY		
				14	TUT	HTBA	LATTIMER		
				15	TUT	HTBA	MEYERS		
				16	TUT	HTBA	OWEN		
				18	TUT	HTBA	SHARP		
				19	TUT	HTBA	PETERSON		
				20	TUT	HTBA	PREWITT		
				22	TUT	HTBA	SIMON		
				23	TUT	HTBA	SOLOMON		
				24	TUT	HTBA	WEIDNER		
				25	TUT	HTBA	REEDER		
				26	TUT	HTBA	FORMAN		
				30	TUT	HTBA	CALDWELL		
<b>EST COURSES</b>									
EST	570	DESIGN COMP COURSWAR	3.0	PREREQ: EST 565 REMARK: FORMERLY CROSS-LISTED WITH CEY 570					
				01	LEC	TH 05:30-08:00	LIAO	ENGINEERING 110	
				21	LEC	HTBA			
EST	571	COMP-BASED EDUC TECH	3.0	PREREQ: EST 565 AND EST 570 OR PERMISSION OF INSTRUCTOR					
				01	LEC	TU 06:00-08:30PM	FERGUSON	ENGINEERING 110	
EST	582	SYS APPRCH HUM MACH	3.0	PREREQ: COREQ: CEN 580 OR PERM INSTRUC REMARK: FORMERLY CROSS-LISTED WITH CEN 582					
				01	LEC	W 06:00-08:30PM	REAVEN	ENGINEERING 110	
EST	583	COMPUTER LITERACY	3.0	REMARK: FORMERLY CROSS-LISTED WITH CEN 583					
				01	LEC	W 05:30-08:00	LEONHARDT	ENGINEERING 143	
EST	588	TECH COMMUNICATION	3.0	REMARK: OPEN TO EMP STUDENTS					
				01	SEM	TU 06:30-09:00PM	SPANIER	ENGINEERING 112	
EST	591	IND STUDY TECH & SOC	1.0-3.0	PREREQ: EST 590 REMARK: FORMERLY ESE 585					
				01	TUT	HTBA	STAFF		
EST	598	PRACTICM IN TEACHING	3.0	REMARK: S/U GRADING					
				01	TUT	HTBA			
<b>FRN COURSES</b>									
FRN	508	ADVANCED STYLISTICS	3.0	PREREQ: GOOD KNOWLEDGE OF FRENCH -CED STUDENTS NEED PERMISSION					
				01	SEM	W 04:30-07:00	ZIMMERMANN		
FRN	513	APPLIED LING IN FREN	3.0	PREREQ: FRN 510					
				01	LEC	TU 04:30-07:00	KAPUSCINSK	MELVILLE LBR N3085	
FRN	542	18TH CENT FRN THR	3.0	01 SEM M 04:30-07:00			HAAC	PSYCHOLOGY A 265	
FRN	552	CAMUS & HIS CNTMPRYS	3.0	01 SEM TH 04:30-07:00			RIZZUTO	MELVILLE LBR N3085	
FRN	581	INDEPENDENT IND STUD	1.0-6.0	REMARK: S/U GRADING. VARIABLE & REPETITIVE					
				01	TUT	HTBA	STAFF		



DEPT	COURSE	TITLE	CREDITS	SECT	TYPE	MEETING TIMES	INSTRUCTOR	LOCATION
				07	TUT	HTBA	CHINCHILLA	
				08	TUT	HTBA	CLELAND	
				09	TUT	HTBA	COWAN	
				11	TUT	HTBA	GARBER	
				12	TUT	HTBA	LIDA	
				13	TUT	HTBA	KUISEL	
				14	TUT	HTBA	LAMPARD	
				15	TUT	HTBA	LEBOVICS	
				16	TUT	HTBA	LEE	
				17	TUT	HTBA	LEMAY	
				18	TUT	HTBA	LARSON	
				19	TUT	HTBA	SEIFMAN	
				20	TUT	HTBA	MAIN	
				21	TUT	HTBA	MARCUS	
				22	TUT	HTBA	PRATT	
				23	TUT	HTBA	BARNHART	
				24	TUT	HTBA	ROSENTHAL	
				25	TUT	HTBA	MARKER	
				26	TUT	HTBA	SEMMEL	
				27	TUT	HTBA	TAYLOR	
				28	TUT	HTBA	TOMES	
				29	TUT	HTBA	OWENS	
				30	TUT	HTBA	WEINSTEIN	
				31	TUT	HTBA	WELTSCH	
				33	TUT	HTBA	WILLIAMS	
				35	TUT	HTBA	LANDSMAN	
				40	TUT	HTBA	STEIN	
				41	TUT	HTBA		
				43	TUT	HTBA	WEINSTEIN	
				44	TUT	HTBA	WISHNIA J	
HIS	585	DIR READ MA III	1.0-18.0	01	TUT	HTBA		
				02	TUT	HTBA	ALIN	
				03	TUT	HTBA	ANGRESS	
				04	TUT	HTBA	BOTTIGHEIM	
				05	TUT	HTBA	BURNER	
				06	TUT	HTBA	MILLER	
				07	TUT	HTBA	CHINCHILLA	
				08	TUT	HTBA	CLELAND	
				09	TUT	HTBA	COWAN	
				11	TUT	HTBA	GARBER	
				12	TUT	HTBA	LIDA	
				13	TUT	HTBA	KUISEL	
				14	TUT	HTBA	LAMPARD	
				15	TUT	HTBA	LEBOVICS	
				16	TUT	HTBA	LEE	
				17	TUT	HTBA	LEMAY	
				18	TUT	HTBA	LARSON	
				19	TUT	HTBA	SEIFMAN	
				20	TUT	HTBA	MAIN	
				21	TUT	HTBA	MARCUS	
				22	TUT	HTBA	PRATT	
				23	TUT	HTBA	BARNHART	
				24	TUT	HTBA	ROSENTHAL	
				25	TUT	HTBA	MARKER	
				26	TUT	HTBA	SEMMEL	
				27	TUT	HTBA	TAYLOR	
				28	TUT	HTBA	TOMES	
				30	TUT	HTBA	WEINSTEIN	
				31	TUT	HTBA	WELTSCH	
				33	TUT	HTBA	WILLIAMS	
				35	TUT	HTBA	LANDSMAN	
				40	TUT	HTBA	STEIN	
				41	TUT	HTBA		
				43	TUT	HTBA	WEINSTEIN	
				44	TUT	HTBA	WISHNIA J	
HIS	586	DIR READ MA IV	1.0-3.0	01	TUT	HTBA		
				02	TUT	HTBA	ALIN	
				03	TUT	HTBA	ANGRESS	
				04	TUT	HTBA	BOTTIGHEIM	
				05	TUT	HTBA	BURNER	
				06	TUT	HTBA	MILLER	
				07	TUT	HTBA	CHINCHILLA	
				08	TUT	HTBA	CLELAND	
				09	TUT	HTBA	COWAN	
				11	TUT	HTBA	GARBER	
				12	TUT	HTBA	LIDA	
				13	TUT	HTBA	KUISEL	
				14	TUT	HTBA	LAMPARD	
				15	TUT	HTBA	LEBOVICS	
				16	TUT	HTBA	LEE	
				17	TUT	HTBA	LEMAY	
				18	TUT	HTBA	LARSON	
				19	TUT	HTBA	SEIFMAN	
				20	TUT	HTBA	MAIN	
				21	TUT	HTBA	MARCUS	
				22	TUT	HTBA	PRATT	
				23	TUT	HTBA	BARNHART	
				24	TUT	HTBA	ROSENTHAL	
				25	TUT	HTBA	MARKER	
				26	TUT	HTBA	SEMMEL	
				27	TUT	HTBA	TAYLOR	
				28	TUT	HTBA	TOMES	
				29	TUT	HTBA	OWENS	
				30	TUT	HTBA	WEINSTEIN	
				31	TUT	HTBA	WELTSCH	
				33	TUT	HTBA	WILLIAMS	
				35	TUT	HTBA	LANDSMAN	
				40	TUT	HTBA	STEIN	
				41	TUT	HTBA		
				43	TUT	HTBA	WEINSTEIN	
HIS	622	RDG SEM US POL ECOMY	3.0	01	SEM	M	LANDSMAN	SOCBEHAV SCI S311
HIS	632	US DIPLOMATIC HIS	3.0	01	SEM	W	BARNHART	SOCBEHAV SCI N303
HIS	654	RSRCH SEM ENGLISH HIS	3.0	01	SEM	TU	SEMMEL	SOCBEHAV SCI N303
HIS	682	DIR READ PHD I	1.0-18.0	01	TUT	HTBA		
				02	TUT	HTBA	ALIN	
				03	TUT	HTBA	ANGRESS	
				04	TUT	HTBA	BOTTIGHEIM	
				05	TUT	HTBA	BURNER	
				06	TUT	HTBA	MILLER	
				07	TUT	HTBA	CHINCHILLA	
				08	TUT	HTBA	CLELAND	
				09	TUT	HTBA	COWAN	
				11	TUT	HTBA	GARBER	
				12	TUT	HTBA	LIDA	
				13	TUT	HTBA	KUISEL	
				14	TUT	HTBA	LAMPARD	
				15	TUT	HTBA	LEBOVICS	
				16	TUT	HTBA	LEE	

DEPT	COURSE	TITLE	CREDITS	SECT	TYPE	MEETING TIMES	INSTRUCTOR	LOCATION
				17	TUT	HTBA	LEMAY	
				18	TUT	HTBA	LARSON	
				20	TUT	HTBA	MAIN	
				21	TUT	HTBA	MARCUS	
				22	TUT	HTBA	PRATT	
				23	TUT	HTBA	BARNHART	
				24	TUT	HTBA	ROSENTHAL	
				25	TUT	HTBA	MARKER	
				26	TUT	HTBA	SEMMEL	
				27	TUT	HTBA	TAYLOR	
				28	TUT	HTBA	TOMES	
				29	TUT	HTBA		
				30	TUT	HTBA	WEINSTEIN	
				31	TUT	HTBA	WELTSCH	
				33	TUT	HTBA	WILLIAMS	
				35	TUT	HTBA	LANDSMAN	
				40	TUT	HTBA	STEIN	
				41	TUT	HTBA		
				43	TUT	HTBA	WEINSTEIN	
				44	TUT	HTBA	WISHNIA J	
HIS	684	DIR READ PHD II	1.0-18.0	01	TUT	HTBA		
				02	TUT	HTBA	ALIN	
				03	TUT	HTBA	ANGRESS	
				04	TUT	HTBA	BOTTIGHEIM	
				05	TUT	HTBA	BURNER	
				06	TUT	HTBA	MILLER	
				07	TUT	HTBA	CHINCHILLA	
				08	TUT	HTBA	CLELAND	
				09	TUT	HTBA	COWAN	
				10	TUT	HTBA	FOX	
				11	TUT	HTBA	GARBER	
				12	TUT	HTBA	LIDA	
				13	TUT	HTBA	KUISEL	
				14	TUT	HTBA	LAMPARD	
				15	TUT	HTBA	LEBOVICS	
				16	TUT	HTBA	LEE	
				17	TUT	HTBA	LEMAY	
				18	TUT	HTBA	LARSON	
				20	TUT	HTBA	MAIN	
				21	TUT	HTBA	MARCUS	
				22	TUT	HTBA	PRATT	
				23	TUT	HTBA	BARNHART	
				24	TUT	HTBA	ROSENTHAL	
				25	TUT	HTBA	MARKER	
				26	TUT	HTBA	SEMMEL	
				27	TUT	HTBA	TAYLOR	
				28	TUT	HTBA	TOMES	
				29	TUT	HTBA	OWENS	
				30	TUT	HTBA	WEINSTEIN	
				31	TUT	HTBA	WELTSCH	
				33	TUT	HTBA	WILLIAMS	
				35	TUT	HTBA	LANDSMAN	
				40	TUT	HTBA	STEIN	
				41	TUT	HTBA		
				43	TUT	HTBA	WEINSTEIN	
				44	TUT	HTBA	WISHNIA J	
HIS	685	DIR READ PHD III	1.0-9.0	01	TUT	HTBA		
				02	TUT	HTBA	ALIN	
				03	TUT	HTBA	ANGRESS	
				04	TUT	HTBA	BOTTIGHEIM	
				05	TUT	HTBA	BURNER	
				06	TUT	HTBA	MILLER	
				07	TUT	HTBA	CHINCHILLA	
				08	TUT	HTBA	CLELAND	
				09	TUT	HTBA	COWAN	
				11	TUT	HTBA	GARBER	
				12	TUT	HTBA	LIDA	
				13	TUT	HTBA	KUISEL	
				14	TUT	HTBA	LAMPARD	
				15	TUT	HTBA	LEBOVICS	
				16	TUT	HTBA	LEE	
				17	TUT	HTBA	LEMAY	
				18	TUT	HTBA	LARSON	
				20	TUT	HTBA	MAIN	
				21	TUT	HTBA	MARCUS	
				22	TUT	HTBA	PRATT	
				23	TUT	HTBA	BARNHART	
				24	TUT	HTBA	ROSENTHAL	
				25	TUT	HTBA	MARKER	
				26	TUT	HTBA	SEMMEL	
				27	TUT	HTBA	TAYLOR	
				28	TUT	HTBA	TOMES	
				29	TUT	HTBA	OWENS	
				30	TUT	HTBA	WEINSTEIN	
				31	TUT	HTBA	WELTSCH	
				33	TUT	HTBA	WILLIAMS	
				35	TUT	HTBA	LANDSMAN	
				40	TUT	HTBA	STEIN	
				41	TUT	HTBA		
				43	TUT	HTBA	WEINSTEIN	
				44	TUT	HTBA	WISHNIA J	
HIS	686	DIR READ PHD IV	1.0-18.0	01	TUT	HTBA		
				02	TUT	HTBA	ALIN	
				03	TUT	HTBA	ANGRESS	
				04	TUT	HTBA	BOTTIGHEIM	
				05	TUT	HTBA	BURNER	
				06	TUT	HTBA	MILLER	
				07	TUT	HTBA	CHINCHILLA	
				08	TUT	HTBA	CLELAND	
				09	TUT	HTBA	COWAN	
				11	TUT	HTBA	GARBER	
				12	TUT	HTBA	LIDA	
				13	TUT	HTBA	KUISEL	
				14	TUT	HTBA	LAMPARD	
				15	TUT	HTBA	LEBOVICS	
				16	TUT	HTBA	LEE	
				17	TUT	HTBA	LEMAY	
				18	TUT	HTBA	LARSON	
				20	TUT	HTBA	MAIN	
				21	TUT	HTBA	MARCUS	
				22	TUT	HTBA	PRATT	
				23	TUT	HTBA	BARNHART	
				24	TUT	HTBA	ROSENTHAL	
				25	TUT	HTBA	MARKER	
				26	TUT	HTBA	SEMMEL	
				27	TUT	HTBA	TAYLOR	
				28	TUT	HTBA	TOMES	
				29	TUT	HTBA	OWENS	
				30	TUT	HTBA	WEINSTEIN	
				31	TUT	HTBA	WELTSCH	
				33	TUT	HTBA	WILLIAMS	
				35	TUT	HTBA	LANDSMAN	

DEPT	COURSE	TITLE	CREDITS	SECT	TYPE	MEETING TIMES	INSTRUCTOR	LOCATION
				40	TUT	HTBA	STEIN	
				41	TUT	HTBA		
				43	TUT	HTBA	WEINSTEIN	
				44	TUT	HTBA	WISHNIA J	
HIS	699	RSCH FOR PHD	1.0-18.0	01	TUT	HTBA		
				02	TUT	HTBA	ALIN	
				03	TUT	HTBA	ANGRESS	
				04	TUT	HTBA	BOTTIGHEIM	
				05	TUT	HTBA	BURNER	
				06	TUT	HTBA	MILLER	
				07	TUT	HTBA	CHINCHILLA	
				08	TUT	HTBA	CLELAND	
				09	TUT	HTBA	COWAN	
				11	TUT	HTBA	GARBER	
				12	TUT	HTBA	LIDA	
				13	TUT	HTBA	KUISEL	
				14	TUT	HTBA	LAMPARD	
				15	TUT	HTBA	LEBOVICS	
				16	TUT	HTBA	LEE	
				17	TUT	HTBA	LEMAY	
				18	TUT	HTBA	LEVINE	
				20	TUT	HTBA	MAIN	
				21	TUT	HTBA	MARCUS	
				22	TUT	HTBA	PRATT	
				23	TUT	HTBA	BARNHART	
				24	TUT	HTBA	ROSENTHAL	
				25	TUT	HTBA	MARKER	
				26	TUT	HTBA	SEMMEL	
				27	TUT	HTBA	TAYLOR	
				28	TUT	HTBA	TOMES	
				29	TUT	HTBA		
				30	TUT	HTBA	WEINSTEIN	
				31	TUT	HTBA	WELTSCH	
				33	TUT	HTBA	WILLIAMS	
				35	TUT	HTBA	LANDSMAN	
				40	TUT	HTBA	STEIN	
				43	TUT	HTBA	WEINSTEIN	
<b>ITL COURSES</b>								
ITL	502	ITALIA IN TRANSIZION	3.0	01	SEM	W 04:30-07:00	FONTANELLA	PSYCHOLOGY A 265
ITL	522	ITL HUM & RENAISS LIT	3.0	PREREQ: KNOWLEDGE OF ITAL LANG & SOME LIT				
				01	SEM	TH 04:30-07:00	CARPETTO	PSYCHOLOGY A 144
ITL	562	CONTEMPORARY LIT	3.0	REMARK: CROSS-LISTED WITH CED 580				
				01	LEC	M 04:30-07:00	MIGNONE	PSYCHOLOGY A 356
ITL	581	INDEPENDENT READING	1.0-6.0	01	TUT	HTBA	STAFF	
				02	TUT	HTBA	STAFF	
ITL	590	THESIS RESEARCH	1.0-6.0	PREREQ: PERMISSION OF DIRECTOR OF GRADUATE STUDIES				
				REMARK: MAY BE REPEATED				
				01	TUT	HTBA	STAFF	
ITL	595	PRACTICUM TEACHNG II	0.0-0.0	PREREQ: EXCELLENT KNOWLEDGE OF ITALIAN				
				REMARK: S/U GRADING ONLY				
				01	SEM	HTBA		
ITL	599	PRACTICUM IN TEACH	1.0-6.0	01	SEM	HTBA		
<b>LIN COURSES</b>								
LIN	521	SYNTAX	3.0	REMARK: FORMERLY ESL 521; CROSSLISTED WITH ANT 571				
				01	LEC	M 06:00-08:30PM	ANSHEN	SOCBEHAV SCI N104
LIN	525	CONTRASTIVE ANALYSIS	3.0	REMARK: FORMERLY ESL 525; CROSSLISTED WITH ANT 575				
				01	LEC	W 06:00-08:30PM	BROSELOW	SOCBEHAV SCI N107
LIN	526	ANLYS UNCM TAUGHT LAN	3.0	REMARK: FORMERLY ESL 526; CROSSLISTED WITH ANT 576				
				01	LEC	MW 01:30-02:45	ARONOFF	SOCBEHAV SCI N107
LIN	531	LANGUAGE TESTING	3.0	REMARK: FORMERLY ESL 531				
				01	LEC	MWF 11:30-12:20	CARTON	SOCBEHAV SCI N107
LIN	532	SECOND LANG ACQUISTN	3.0	REMARK: FORMERLY ESL 532				
				01	LEC	TUTH 02:15-03:30	SRIDHAR	SOCBEHAV SCI N107
LIN	535	HISTORICAL LIN	3.0	REMARK: FORMERLY ESL 535; CROSSLISTED WITH SPN 501				
				01	LEC	MW 03:30-04:45	HOBERMAN	SOCBEHAV SCI N107
LIN	550	SPECL TOPICS IN LING	3.0	REMARK: CROSS CULTURAL STUDY OF LANGUAGE USE				
				01	LEC	TUTH 09:55-11:10	SRIDHAR	SOCBEHAV SCI N104
LIN	571	PRACTICUM I	3.0	REMARK: FORMERLY ESL 571				
				01	LEC	MW 03:30-04:45	ANSARA	SOCBEHAV SCI N108
LIN	572	PRACTICUM II	3.0	REMARK: FORMERLY ESL 572				
				01	LEC	TUTH 03:45-05:00	ANSARA	SOCBEHAV SCI N107
LIN	591	DIR READ APPL LIN	3.0	PREREQ: PERMISSION OF FACULTY				
				REMARK: FORMERLY ESL 591				
				01	TUT	HTBA	ANSHEN	
				02	TUT	HTBA	ARONOFF	
				03	TUT	HTBA	CARTON	
				04	TUT	HTBA	BROSELOW	
				05	TUT	HTBA	ANSARA	
				06	TUT	HTBA	SRIDHAR	
LIN	595	THESIS	3.0-6.0	PREREQ: INVITATION BY THE FACULTY				
				REMARK: FORMERLY ESL 595				
				01	TUT	HTBA	ANSHEN	
				02	TUT	HTBA	ARONOFF	
				03	TUT	HTBA	CARTON	
				04	TUT	HTBA	BROSELOW	
				05	TUT	HTBA	ANSARA	
				06	TUT	HTBA	SRIDHAR	
<b>MAR COURSES</b>								
MAR	503	CHEMICAL OCEANOGRPHY	4.0	REMARK: MESP ENROLLMENT OR WRITTEN PERMIS OF INSTR				
				01	LEC	TUTH 02:45-04:25	COCHRAN	CHALNGERHALL 163
							SCRANTON	
MAR	506	GEOLOGICAL OCNGRPHY	4.0	PREREQ: ONE YR PHYSICS, ONE YR CALCULUS & PERM OF INSTR				
				REMARK: CED STUDENTS MUST HAVE WRITTEN PERMIS OF INSTR				
				01	LEC	MW 10:20-12:00	BOKUNIEWIC	ENDEAVOR HALL 158
MAR	510	GEOCHEMICAL MODELING	3.0	PREREQ: PERM OF INSTRUC				
				01	LEC	MW 03:00-04:15	MACKIN	CHALNGERHALL 163



DEPT	COURSE	TITLE	CREDITS	SECT	TYPE	MEETING TIMES	INSTRUCTOR	LOCATION
MAR	515	PHYTOPLANKTON ECOLOGY	3.0	PREREQ: GENERAL BIOLOGY 01	LEC	TUTH 10:00-11:15	COSPER CARPENTER	ENDEVOR HALL 158
MAR	522	ENVIRONMENTAL TOXICO	3.0	REMARK: REQUIRES MESP ENROLLMENT OR WRITTEN PERMIS OF INSTRUCTOR 01	LEC	TUTH 08:45-10:00	WURSTER	CHALNGERHALL 163
MAR	523	MARINÉ BOTANY	4.0	PREREQ: GENERAL BOTANY/ ECOLOGY REMARK: MESP OR DIV BIO SCI ENROLLMENT OR WRITTEN PERMISSION OF INSTRUCTOR 01	LEC	TUTH 02:00-03:40	BRINKHUIS	ENDEVOR HALL 158
MAR	525	MARINE ECOLOGY-CRITI	1.0	01	TUT	HTBA	GERARD	ENDEVOR HALL
MAR	534	AQUACULTURE	3.0	01	LEC	TUTH 10:45-12:00	GERARD SIDDALL MALOUF	ENDEVOR HALL
MAR	539	COMPUTER ANALYSIS	1.0	PREREQ: PERM OF INSTRUC 01	REC	W 10:30-11:20	SIDDALL	ENDEVOR HALL 158
MAR	547	OCEANOLOG PROB SOLVING	1.0	PREREQ: MAR 501 & 502 01	SEM	HTBA	SCRANTON BOKUNIEWICZ	ENDEVOR HALL 158
MAR	550	TOPICS IN MARINE SCI	1.0-12.0	REMARK: NON-MESP STUDENTS REQUIRE WRITTEN PERMIS OF INSTRUC 01	SEM	F 01:00-02:40	ZARILLO	CHALNGERHALL 163
				02	LEC	F 12:00-01:40	FUHRMAN CAPONE HARRIGAN	ENDEVOR HALL 158
				03	LEC	TUTH 04:00-05:15	CAPONE	ENDEVOR HALL 158
				04	LEC	MTH 01:00-02:15	WEYL	ENDEVOR HALL 158
				05	LAB	HTBA	BOWMAN	ENDEVOR HALL 156
MAR	552	DIRECTED STUDY	1.0-12.0	PREREQ: PERMISSION OF INSTRUCTOR 01	TUT	HTBA	BOKUNIEWICZ	
				02	TUT	HTBA	BOWMAN	
				03	TUT	HTBA	BRINKHUIS	
				04	TUT	HTBA	CAPONE	
				05	TUT	HTBA	CARPENTER	
				06	TUT	HTBA	CARTER	
				07	TUT	HTBA	CERRATO	
				08	TUT	HTBA	CONOVER	
				09	TUT	HTBA	COSPER	
				10	TUT	HTBA	COCHRAN	
				11	TUT	HTBA	FUHRMAN	
				12	TUT	HTBA	STAFF	
				13	TUT	HTBA	LOPEZ	
				14	TUT	HTBA	ROETHEL	
				15	TUT	HTBA	MALOUF	
				16	TUT	HTBA	MCHUGH	
				17	TUT	HTBA	OKUBO	
				18	TUT	HTBA	PETERSON	
				19	TUT	HTBA	PRITCHARD	
				20	TUT	HTBA	SCHUBEL	
				21	TUT	HTBA	SCRANTON	
				22	TUT	HTBA	TERRY	
				23	TUT	HTBA	WEYL	
				24	TUT	HTBA	WILSON	
				25	TUT	HTBA	WOODHEAD	
				26	TUT	HTBA	WURSTER	
				27	TUT	HTBA	ZARILLO	
				28	TUT	HTBA	PARTCH	
				29	TUT	HTBA	GERARD	
				30	TUT	HTBA	MACKIN	
				31	TUT	HTBA	DUGUAY	
				32	TUT	HTBA	SIDDALL	
				33	TUT	HTBA	HARRIGAN	
MAR	553	FISHERY MANAGEMENT	3.0	REMARK: MESP ENROLLMENT OR WRITTEN PERMIS OF INSTR 01	LEC	MW 01:30-02:45	CONOVER SIDDALL MALOUF	CHALNGERHALL 163
MAR	565	SEMINAR PREPARATION	3.0	PREREQ: CONSENT OF INSTRUCTOR & MAR 501 502,503,506, & MAR 580. 01	LEC	W 02:00-04:30	BOKUNIEWICZ	CHALNGERHALL
MAR	571	MARINE ZOOPLANKTON	3.0	PREREQ: MAR 502 & PERM OF INST 01	LEC	WF 08:45-10:00	PETERSON	CHALNGERHALL 163
MAR	580	SEMINAR	1.0	REMARK: REQUIRES MESP ENROLLMENT OR WRITTEN PERMIS OF PROGRAM DIRECTOR 01	SEM	W 12:00-12:50	WURSTER	CHALNGERHALL 163
				02	LEC	HTBA	GERARD SIDDALL MALOUF	
MAR	590	RESEARCH	1.0-12.0	REMARK: MESP ENROLLMENT OR WRITTEN PERMIS OF INSTR 01	TUT	HTBA	BOKUNIEWICZ	
				02	TUT	HTBA	BOWMAN	
				03	TUT	HTBA	BRINKHUIS	
				04	TUT	HTBA	CAPONE	
				05	TUT	HTBA	CARPENTER	
				06	TUT	HTBA	CARTER	
				07	TUT	HTBA	CERRATO	
				08	TUT	HTBA	CONOVER	
				09	TUT	HTBA	COSPER	
				10	TUT	HTBA	COCHRAN	
				11	TUT	HTBA	FUHRMAN	
				12	TUT	HTBA	STAFF	
				13	TUT	HTBA	LOPEZ	
				14	TUT	HTBA	ROETHEL	
				15	TUT	HTBA	MALOUF	
				17	TUT	HTBA	OKUBO	
				18	TUT	HTBA	PETERSON	
				19	TUT	HTBA	PRITCHARD	
				20	TUT	HTBA	SCHUBEL	
				21	TUT	HTBA	SCRANTON	
				22	TUT	HTBA	TERRY	
				23	TUT	HTBA	WEYL	
				24	TUT	HTBA	WILSON	
				25	TUT	HTBA	WOODHEAD	
				26	TUT	HTBA	WURSTER	
				27	TUT	HTBA	ZARILLO	
				28	TUT	HTBA	PARTCH	
				29	TUT	HTBA	GERARD	
				30	TUT	HTBA	MACKIN	
				31	TUT	HTBA	DUGUAY	
				32	TUT	HTBA	SIDDALL	
				33	TUT	HTBA	HARRIGAN	

DEPT	COURSE	TITLE	CREDITS	SECT	TYPE	MEETING TIMES	INSTRUCTOR	LOCATION	
<b>MAT COURSES</b>									
MAT	514	ANLYS FOR TEACHERSII	3.0						
							REMARK: PRIMARILY FOR STUDENTS IN THE MA DEG TRACK FOR SEC SCH TEACHERS		
				01	LEC	TU	06:30-09:00	MICHAELSOH	PHYSICS P124
MAT	519	SEM IN MATH TEACHING	3.0	01	LEC	W	06:00-08:30		PHYSICS P124
MAT	531	TOPOLOGY-GEOMETRY II	3.0				PREREQ: MAT 530		
				01	LEC	MWF	01:30-02:20	HILL	EARTH&SPACE 181
MAT	539	ALGEBRAIC TOPOLOGY	3.0	01	LEC	TUTH	09:55-11:10		LGT ENGR LAB 248
MAT	542	COMPLEX ANALYSIS I	3.0	01	LEC	MWF	10:30-11:20	MASKIT	OLD PHYSICS 115
MAT	546	DIFFERENTIAL EQUATON	3.0	01	LEC	TUTH	12:45-02:00	TAYLOR	PHYSICS P124
MAT	550	REAL ANALYSIS I	3.0	01	LEC	MWF	11:30-12:20	DOSS	PHYSICS P124
MAT	569	DIFFER GEOMETRY	3.0				PREREQ: MAT 531		
				01	LEC	MW	02:30-03:45	GROMOLL	CENTRAL HALL 043
MAT	591	PROBLEM SEMINAR II	3.0	01	LEC	TUTH	2:15- 3:30	JABLOW	EARTH&SPACE 181
MAT	614	TOPIC ALGEBRAIC GEOM	3.0	01	LEC	MWF	11:30-12:20	MULASE	LGT ENGR LAB 248
MAT	627	TOPIC COMPLEX ANALYS	3.0	01	LEC	MWF	12:30-01:20		LGT ENGR LAB 246
MAT	632	TOPIC DIFF EQUATIONS	3.0	01	LEC	MW	04:00-05:15	SPATZIER	CENTRAL HALL 043
MAT	639	TOPIC REAL ANALYSIS	3.0	01	LEC	TUTH	12:45-02:00	HAWKINS	PHYSICS P125
MAT	645	TOPIC DIFF GEOMETRY	3.0	01	LEC	TUTH	08:30-09:45	LEBRUN	OLD PHYSICS 115
MAT	670	ADV TOP COMPLX ANLYS	3.0	01	LEC	TUTH	11:20-12:35	KRA	CHEMISTRY 124
MAT	674	ADV TOP DIFF EQUATNS	3.0	01	LEC	TUTH	09:55-11:10	TSO	ENGINEERING 112
MAT	683	ADV TOP DIFF GEOM	3.0	01	LEC	TUTH	02:15-03:30	LAWSON	CHEMISTRY 123
MAT	696	MATHEMATICS SEMINAR	1.0-3.0				REMARK: 1:ALGEBRA;2:REAL ANALYS;3:COMP ANALYS;4:GEOM;TOPLG.FRMPLY MSM 696		
				01	SEM	HTBA			
				02	SEM	HTBA			
				03	SEM	HTBA			
				04	SEM	HTBA			
MAT	697	MATHEMATICS COLLOQ	1.0	01	LEC	TH	04:30-05:30		PHYSICS P118
MAT	698	INDEPENDENT STUDY	1.0-8.0	01	TUT	HTBA		ADLER	
				02	TUT	HTBA		BARCUS	
				03	TUT	HTBA		CHEEGER	
				04	TUT	HTBA		DOSS	
				05	TUT	HTBA		DOUGLAS	
				06	TUT	HTBA		EBIN	
				07	TUT	HTBA		FOX W	
				08	TUT	HTBA		GELLER	
				09	TUT	HTBA		GROMOLL	
				10	TUT	HTBA		HAWKINS	
				11	TUT	HTBA		HILL	
				12	TUT	HTBA		JABLOW	
				13	TUT	HTBA		JONES	
				14	TUT	HTBA		KRA	
				15	TUT	HTBA		KUGA	
				16	TUT	HTBA		KUMPEL	
				17	TUT	HTBA		LAUFER	
				18	TUT	HTBA		LAWSON	
				19	TUT	HTBA		LEBRUN	
				20	TUT	HTBA		LISTER	
				21	TUT	HTBA		MASKIT	
				22	TUT	HTBA		MCDUFF	
				23	TUT	HTBA		MICHELSON	
				24	TUT	HTBA		NISNEUICH	
				25	TUT	HTBA		PHILLIPS	
				26	TUT	HTBA		PINCUS	
				27	TUT	HTBA		SAH	
				28	TUT	HTBA		SPENCER	
				29	TUT	HTBA		SZUSZ	
				30	TUT	HTBA		TAYLOR	
				31	TUT	HTBA		TELEMAN	
				32	TUT	HTBA		THORPE	
				33	TUT	HTBA		TSO	
				34	TUT	HTBA		VINEGRAD	
				35	TUT	HTBA		ZAUSTINSKY	
MAT	699	DIRECTED RESEARCH	1.0-12.0	01	TUT	HTBA		ADLER	
				02	TUT	HTBA		BARCUS	
				03	TUT	HTBA		CHEEGER	
				04	TUT	HTBA		DOSS	
				05	TUT	HTBA		DOUGLAS	
				06	TUT	HTBA		EBIN	
				07	TUT	HTBA		FOX W	
				08	TUT	HTBA		GELLER	
				09	TUT	HTBA		GROMOLL	
				10	TUT	HTBA		HAWKINS	
				11	TUT	HTBA		HILL	
				12	TUT	HTBA		JABLOW	
				13	TUT	HTBA		JONES	
				14	TUT	HTBA		KRA	
				15	TUT	HTBA		KUGA	
				16	TUT	HTBA		KUMPEL	
				17	TUT	HTBA		LAUFER	
				18	TUT	HTBA		LAWSON	
				19	TUT	HTBA		LEBRUN	
				20	TUT	HTBA		LISTER	
				21	TUT	HTBA		MASKIT	
				22	TUT	HTBA		MCDUFF	
				23	TUT	HTBA		MICHELSON	
				24	TUT	HTBA		NISNEUICH	
				25	TUT	HTBA		STRASSER	
				26	TUT	HTBA		PHILLIPS	
				27	TUT	HTBA		PINCUS	
				28	TUT	HTBA		SAH	
				29	TUT	HTBA		SPENCER	
				30	TUT	HTBA		SZUSZ	
				31	TUT	HTBA		TAYLOR	
				32	TUT	HTBA		TELEMAN	
				33	TUT	HTBA		THORPE	
				34	TUT	HTBA		TSO	
				35	TUT	HTBA		VINEGRAD	
								ZAUSTINSKY	

DEPT	COURSE	TITLE	CREDITS	SECT	TYPE	MEETING TIMES	INSTRUCTOR	LOCATION		
<b>MUS COURSES</b>										
MUS	500	INT TO MUSIC RESRCH	3.0	01	SEM	W	01:30-04:00	BONVALOT	MELVILLE LBR	2001
MUS	502	PROSEM TONAL ANALYS	3.0	PREREQ: PERMIS OF INSTR						
MUS	507	PROSEM IN MUSIC HIS	3.0	01	SEM	TUTH	09:55-11:10	CHERLIN	FINE ARTS	2310
PREREQ: PERMIS OF INSTR										
MUS	508	COMP-THEORY STUDIES	1.0-3.0	01	SEM	HTBA	01:30-04:00	WINKLER	FINE ARTS	2310
PREREQ: PERMIS OF INSTR										
MUS	509	PERFORMANCE STUDIES	2.0-3.0	01	SEM	HTBA		STAFF		
PREREQ: AUDITION										
MUS	516	ELEC MUS WORKSHOP	3.0	01	TUT	HTBA				
PREREQ: MUS 515 OR EQUIVALENT										
MUS	523	ADV COMPOSITION	3.0	01	LAB	TU	12:45-03:15	SEMEGEN	FINE ARTS	3343
01 TUT HTBA										
07 TUT HTBA										
08 TUT HTBA										
11 TUT HTBA										
13 TUT HTBA										
14 TUT HTBA										
15 TUT HTBA										
MUS	532	RHYTHM AND NOTATION	3.0	PREREQ: PERMIS OF INSTR						
MUS	537	SEM ANALYSIS PERFORM	3.0	PREREQ: PERMIS OF INSTR						
PREREQ: PERMIS OF INSTRUCTORS										
MUS	547	TOP:BAROQUE MUS	3.0	01	SEM	TH	12:45-03:15	TREITLER	MELVILLE LBR	2001
MUS	561	ORCHESTRAL CONDUCT	3.0	01	SEM	M	01:30-04:00	BARON	FINE ARTS	3317
MUS	563	ADV CHORAL COND A	3.0-6.0	01	LAB	TU	12:45-03:15	LINFIELD	MELVILLE LBR	2001
MUS	564	ADV CHORAL COND B	3.0	01	LAB	HTBA		WEISBERG		
MUS	565	ADVANCED ORCHESTRA	2.0	01	LAB	TU	02:15-04:15	BROOKS		
01 LAB TU 04:30-06:30										
01 LAB M 04:30-06:00										
01 LAB M 04:30-06:00										
MUS	567	ORCHESTRAL REPERTORY	2.0	REMARK: S/U GRADING						
MUS	570	20 CEN CONT ENSEMBLE	2.0-3.0	01	LAB	HTBA		LEVINE	FINE ARTS	3352
PREREQ: MUS 569 OR EQUIVALENT										
REMARK: 2 CREDITS FOR INSTRUM STUDENTS 3 CREDITS FOR CONDUCTING STUDENTS										
MUS	571	ADV INSTR & VOICE A	2.0-6.0	01	LAB	TH	01:00-03:00	WEISBERG		
02 TUT HTBA										
03 TUT HTBA										
04 TUT HTBA										
05 TUT HTBA										
06 TUT HTBA										
07 TUT HTBA										
08 TUT HTBA										
09 TUT HTBA										
10 TUT HTBA										
11 TUT HTBA										
12 TUT HTBA										
13 TUT HTBA										
14 TUT HTBA										
15 TUT HTBA										
16 TUT HTBA										
17 TUT HTBA										
18 TUT HTBA										
19 TUT HTBA										
20 TUT HTBA										
MUS	573	CHAMBER MUSIC	2.0	REMARK: FILL OUT DEPT FORM AND BE ASSIGNED GROUP.						
MUS	574	MASTER CLASS CH MUS	2.0	01	LAB	HTBA		LEVINE		
MUS	575	MSTR CLS SOLO RPTORY	2.0	01	LAB	HTBA				
PREREQ: PERMIS OF INSTR										
REMARK: SEC 1-VOICE, SEC 2-PIANO, SEC 3-CELLO										
01 LAB HTBA										
02 LAB HTBA										
03 LAB HTBA										
04 LAB HTBA										
05 LAB HTBA										
06 LAB HTBA										
07 LAB HTBA										
08 LAB HTBA										
09 TUT HTBA										
MUS	579	OPERA WORKSHOP	2.0-4.0	PREREQ: AUDITIONS REQUIRED						
01 LAB TU										
04:30-07:30PM										
05:00-08:00PM										
01 LAB TH										
MUS	581	20TH CENT REPERTORY	2.0	01	TUT	M		ANDERSON	FINE ARTS	0111
MUS	591	PRACT IN TCHNG	1.0-3.0	01	TUT	HTBA		STAFF		
MUS	592	SEM:TEACHING IN MUS	1.0	01	SEM	HTBA				
MUS	595	CHAMBER PLAYERS	3.0	PREREQ: PERMIS OF INSTRUCTOR						
01 TUT HTBA										
02 TUT HTBA										
03 TUT HTBA										
04 TUT HTBA										
MUS	599	INDEPENDENT STUDY	1.0-12.0	REMARK: S/U GRADING						
01 TUT HTBA										
02 TUT HTBA										
03 TUT HTBA										
04 TUT HTBA										
05 TUT HTBA										
06 TUT HTBA										
07 TUT HTBA										
08 TUT HTBA										
11 TUT HTBA										
12 TUT HTBA										
13 TUT HTBA										
14 TUT HTBA										
15 TUT HTBA										
16 TUT HTBA										
AREL										
BONVALOT										
FULLER										
KRAMER										
BROOKS										
LAWTON										
LAYTON										
LESSARD										
SEMEGEN										
TREITLER										
WINKLER										
MCCALLA										
CHERLIN										
ROSEN										

DEPT	COURSE	TITLE	CREDITS	SECT	TYPE	MEETING TIMES	INSTRUCTOR	LOCATION	
				17	TUT	HTBA	FISHER		
				18	TUT	HTBA	SILVER		
				19	TUT	HTBA	LINFIELD		
				20	TUT	HTBA	STAFF		
MUS	623	DIR STDY COMPOSITION	1.0-12.0	REMARK: REPETITIVE					
				01	TUT	HTBA			
MUS	661	DIR STDY IN CONDUCT	1.0-12.0	REMARK: REPETITIVE					
				01	TUT	HTBA			
MUS	671	DIR STDY PERFORMANCE	1.0-12.0	REMARK: REPETITIVE					
				01	TUT	HTBA			
MUS	697	DIRECTED READING	1.0-12.0	REMARK: REPETITIVE					
				01	TUT	HTBA			
MUS	698	DIRECTED RESEARCH	1.0-12.0	REMARK: REPETITIVE					
				01	TUT	HTBA			
<b>OCN COURSES</b>									
OCN	563	MATH. MARINE ECOLOGY	2.0	PREREQ: ADVANCED CALCULUS OR PERM OF INST REMARK: CROSSLISTED WITH BEE 563					
				01	LEC	F 10:00-11:40	OKUBO	ENDEVOR HALL 168	
OCN	612	DYNAMICS I	3.0	PREREQ: MAR 501 OR PERM OF INSTRUCTOR					
				01	LEC	TUTH 12:00-01:15	WILSON	ENDEVOR HALL 168	
OCN	624	OCEANIC FRONTS	2.0	PREREQ: MAR 501,502					
				01	LEC	M 03:00-04:40	BOWMAN	ENDEVOR HALL 158	
OCN	650	RESEARCH	1.0-9.0	01	TUT	HTBA	BOKUNIEWICZ		
				02	TUT	HTBA	BOWMAN		
				03	TUT	HTBA	BRINKHUIS		
				04	TUT	HTBA	CAPONE		
				05	TUT	HTBA	CARPENTER		
				06	TUT	HTBA	CARTER		
				07	TUT	HTBA	CERRATO		
				08	TUT	HTBA	CONOVER		
				09	TUT	HTBA	COSPER		
				10	TUT	HTBA	COCHRAN		
				11	TUT	HTBA	FUHRMAN		
				12	TUT	HTBA	STAFF		
				13	TUT	HTBA	LOPEZ		
				14	TUT	HTBA	ROETHEL		
				15	TUT	HTBA	MALOUF		
				17	TUT	HTBA	OKUBO		
				18	TUT	HTBA	PETERSON		
				19	TUT	HTBA	PRITCHARD		
				20	TUT	HTBA	SCHUBEL		
				21	TUT	HTBA	SCRANTON		
				22	TUT	HTBA	TERRY		
				23	TUT	HTBA	WEYL		
				24	TUT	HTBA	WILSON		
				25	TUT	HTBA	WOODHEAD		
				26	TUT	HTBA	WURSTER		
				27	TUT	HTBA	ZARILLO		
				28	TUT	HTBA	PARTCH		
				29	TUT	HTBA	GERARD		
				30	TUT	HTBA	MACKIN		
				31	TUT	HTBA	DUGUAY		
				32	TUT	HTBA	SIDDALL		
				33	TUT	HTBA	HORRIGAN		
OCN	655	DIRECTED STUDY	1.0-9.0	PREREQ: PERMISSION OF INSTRUCTOR					
				01	TUT	HTBA	BOKUNIEWICZ		
				02	TUT	HTBA	BOWMAN		
				03	TUT	HTBA	BRINKHUIS		
				04	TUT	HTBA	CAPONE		
				05	TUT	HTBA	CARPENTER		
				06	TUT	HTBA	CARTER		
				07	TUT	HTBA	CERRATO		
				08	TUT	HTBA	CONOVER		
				09	TUT	HTBA	COSPER		
				10	TUT	HTBA	COCHRAN		
				11	TUT	HTBA	FUHRMAN		
				12	TUT	HTBA	STAFF		
				13	TUT	HTBA	LOPEZ		
				14	TUT	HTBA	ROETHEL		
				15	TUT	HTBA	MALOUF		
				16	TUT	HTBA	MCHUGH		
				17	TUT	HTBA	OKUBO		
				18	TUT	HTBA	PETERSON		
				19	TUT	HTBA	PRITCHARD		
				20	TUT	HTBA	SCHUBEL		
				21	TUT	HTBA	SCRANTON		
				22	TUT	HTBA	TERRY		
				23	TUT	HTBA	WEYL		
				24	TUT	HTBA	WILSON		
				25	TUT	HTBA	WOODHEAD		
				26	TUT	HTBA	WURSTER		
				27	TUT	HTBA	ZARILLO		
				28	TUT	HTBA	PARTCH		
				29	TUT	HTBA	GERARD		
				30	TUT	HTBA	MACKIN		
				31	TUT	HTBA	DUGUAY		
				32	TUT	HTBA	SIDDALL		
				33	TUT	HTBA	HORRIGAN		
OCN	670	PRACTICUM IN TEACHNG	1.0-3.0	01	TUT	HTBA	STAFF		
OCN	674	ESTUARINE OCEANOGRAPHY	3.0	PREREQ: MAR 501					
				01	LEC	TUTH 10:00-11:10	PRITCHARD	ENDEVOR HALL	
OCN	677	BENTHIC ECOLOGY	2.0	PREREQ: MAR 502, MAR 506 OR PERMISSION OF INSTRUCTOR					
				01	LEC	M 10:30-12:20	LOPEZ	CHALNGERHALL 163	
<b>PAM COURSES</b>									
PAM	516	DATA ANALYSIS	3.0	PREREQ: PERMISSION OF INSTRUCTOR					
				01	LEC	TUTH 12:00-02:15			
PAM	518	OPER RES FR PUB SECT	3.0	PREREQ: UPS 513 OR PERMISSION OF INSTRUCTOR					
				01	LEC	HTBA			
PAM	534	ECO THEORY PUB POL 2	3.0	PREREQ: PERMISSION OF INSTRUCTOR					
				01	LEC	HTBA			
PAM	536	CRIT ISSUE URBAN POL	3.0	01	LEC	HTBA			

DEPT	COURSE	TITLE	CREDITS	SECT	TYPE	MEETING TIMES	INSTRUCTOR	LOCATION		
PAM	541	WORKSHOP IN PAM	3.0		PREREQ: PERMIS OF INSTR					
				01	SEM	HTBA				
PAM	544	MODELLING TECHNIQUES	3.0		PREREQ: PERMISSION OF INSTRUCTOR					
				01	LEC	TUTH 09:50-11:10				
PAM	585	PUB PROG EVALUATION	3.0		PREREQ: UPS 533; BASIC MATH SKILLS					
				01	LEC	HTBA				
PAM	591	# USES HIST/PUB POLCY	3.0		01	LEC	HTBA			
PAM	592	ENERGY POLICY	3.0		01	LEC	HTBA			
PAM	595	INDIV RESRCH IN PAM	1.0-15.0		PREREQ: FOR PAM STUDENTS ONLY					
				01	LEC	HTBA				
				02	LEC	HTBA				
				03	LEC	HTBA				
				04	LEC	HTBA				
				05	LEC	HTBA				
				07	LEC	HTBA				
				08	LEC	HTBA				
PAM	596	SMALL GROUP ST PAM	1.0		PREREQ: PAM STUDENTS ONLY					
				01	LEC	HTBA				
				02	LEC	HTBA				
				03	LEC	HTBA				
PAM	597	PRACTICUM IN TEACHNG	3.0-6.0		01	TUT	HTBA			
<b>PHI COURSES</b>										
PHI	516	RES CONTEMP PHIL II	3.0		REMARK: FORMERLY PHI 531					
				01	LEC	M	06:00-08:30PM	SIMON	OLD PHYSICS 205	
PHI	536	MARXISM & COMMUNISM	3.0		REMARK: FORMERLY PHI 532					
				01	LEC	TU	06:30-09:00PM	ATHAY	OLD PHYSICS 205	
PHI	537	PHIL OF TECHNOLOGY	3.0		REMARK: FORMERLY PHI 553					
				01	LEC	TH	06:00-08:30PM	SPECTOR	PHYSICS P124	
PHI	539	PERSPEC ON FEMINISM	3.0		REMARK: FORMERLY PHI 552					
				01	LEC	W	08:00-10:30PM	KITTAY	PHYSICS P122	
PHI	590	DIRECTED READINGS	1.0-6.0		01	TUT	HTBA			
PHI	591	DIRECTED READINGS	1.0-6.0		01	TUT	HTBA			
				36	TUT	HTBA		TEJERA		
				38	TUT	HTBA		WATSON		
PHI	595	DIRECTED RESEARCH	1.0-6.0		01	TUT	HTBA			
PHI	596	DIRECTED RESEARCH	1.0-6.0		01	TUT	HTBA			
PHI	600	ANCIENT PHILOSOPHY	3.0		REMARK: PLATO					
				01	SEM	TH	01:00-03:30	ZYSKIND	OLD PHYSICS 205	
								STERNFELD		
PHI	602	MODERN PHILOSOPHY	3.0		REMARK: EMPIRICISTS					
				01	SEM	M	09:30-12:00	GELBER	OLD PHYSICS 205	
PHI	611	# SOCIAL SCI INTRFACE	3.0		REMARK: PHILOSOPHY & PSYCHOLOGY. CROSSLISTED WITH PSY 620:06, SPRING 1985					
				01	SEM	M	01:00-03:30	HEELAN	PSYCHOLOGY A 257	
PHI	612	# PHI-HUM INTERFACE	3.0		01	SEM	TH	04:00-06:30	SILVERMAN	OLD PHYSICS 205
PHI	621	INDEPENDENT STUDY	1.0-12.0		03	TUT	HTBA	BENDER		
				04	TUT	HTBA		ALLISON		
				05	TUT	HTBA		ATHAY		
				06	TUT	HTBA		BUCHLER		
				09	TUT	HTBA		CASEY		
				12	TUT	HTBA		DENICOLAS		
				14	TUT	HTBA		DILWORTH		
				18	TUT	HTBA		GELBER		
				19	TUT	HTBA		GRIM		
				20	TUT	HTBA		HEELAN		
				22	TUT	HTBA		HILL		
				23	TUT	HTBA		MARTIN		
				24	TUT	HTBA		HOWARD		
				25	TUT	HTBA		KITTAY		
				26	TUT	HTBA		IHDE		
				27	TUT	HTBA		MANCHESTER		
				28	TUT	HTBA		MILLER C		
				29	TUT	HTBA		NOLAN		
				30	TUT	HTBA		NEVILLE		
				31	SEM	HTBA				
				32	TUT	HTBA		SPECTOR		
				33	TUT	HTBA		SIMON		
				34	TUT	HTBA		STERNFELD		
				36	SEM	HTBA				
				37	TUT	HTBA		RAWLINSON		
				38	TUT	HTBA		WATSON		
				40	TUT	HTBA		WELTON		
				41	TUT	HTBA		WILLIAMS		
				44	TUT	HTBA		ZYSKIND		
PHI	622	SUPERVISED TEACHING	3.0		01	SEM	HTBA			
PHI	635	SOC AND POL PHIL	3.0		REMARK: FEMINISM AND MORAL AND POLITICAL PHILOSOPHY					
				01	SEM	TU	01:00-03:30	KITTAY	OLD PHYSICS 205	
PHI	637	AESTHETICS & RHETORC	3.0		REMARK: SEC 2: NIETZSCHE & GREEK PHILOSOPHY. FORMERLY PHI 505					
				01	LEC	W	01:00-03:30	RAWLINSON	OLD PHYSICS 205	
				02	LEC	W	06:30-09:00PM	TEJERA	OLD PHYSICS 205	
PHI	661	PHENOMENOLOGY & EXST	3.0		01	SEM	W	09:30-12:00	IHDE	OLD PHYSICS 205
PHI	662	SYSTEMATIC PHILOS	3.0		REMARK: IMAGINATION					
				01	SEM	TH	09:30-12:00	NEVILLE	OLD PHYSICS 205	
PHI	690	DISSERTATION	1.0-12.0		04	TUT	HTBA	ALLISON		
				05	TUT	HTBA		ATHAY		
				06	TUT	HTBA		BUCHLER		
				09	TUT	HTBA		CASEY		
				12	TUT	HTBA		DENICOLAS		
				14	TUT	HTBA		DILWORTH		
				18	TUT	HTBA		GELBER		
				19	TUT	HTBA		GRIM		
				20	TUT	HTBA		HEELAN		
				22	TUT	HTBA		HILL		
				23	TUT	HTBA		MARTIN		
				24	TUT	HTBA		HOWARD		
				25	TUT	HTBA		KITTAY		
				26	TUT	HTBA		IHDE		
				27	TUT	HTBA		MANCHESTER		

DEPT	COURSE	TITLE	CREDITS	SECT	TYPE	MEETING TIMES	INSTRUCTOR	LOCATION	
				28	TUT	HTBA	MILLER C		
				29	TUT	HTBA	NOLAN		
				30	TUT	HTBA	NEVILLE		
				31	TUT	HTBA	SILVERMAN		
				32	TUT	HTBA	SPECTOR		
				33	TUT	HTBA	SIMON		
				34	TUT	HTBA	STERNFELD		
				36	TUT	HTBA	TEJERA		
				37	TUT	HTBA	RAWLINSON		
				38	TUT	HTBA	WATSON		
				40	TUT	HTBA	WELTON		
				41	TUT	HTBA	WILLIAMS		
				44	TUT	HTBA	ZYSKIND		
<b>PHY COURSES</b>									
PHY	504	METH MATH PHYS II	3.0		<i>PREREQ: PHY 503</i>				
				01	LEC	TUTH	KAHN	PHYSICS	
PHY	506	CLASSICAL ELECTRODYN	3.0		<i>PREREQ: PHY 505</i>				
				01	LEC	MWF	GRAF	PHYSICS	
PHY	512	QUANTUM MECHANICS II	3.0	01	LEC	MWF	GOLDHABER	PHYSICS	
PHY	515	METHODS EXP RESEARCH	3.0	01	LAB	MW	LEE	PHYSICS	
							DEZAFRA	B114	
							GRANNIS		
							KAO		
PHY	516	METH EXPERMNTL RES	3.0		<i>PREREQ: PHY 515</i>				
				01	LAB	MW	LEE	PHYSICS	
							DEZAFRA	B114	
							GRANNIS		
							KAO		
PHY	540	STATISTICAL MECHCS	3.0	01	LEC	MWF	ALLEN	PHYSICS	
PHY	552	NUCLEAR PHYSICS II	3.0	01	LEC	MWF	RHOADES-BR	PHYSICS	
PHY	556	SOLID STATE II	3.0		<i>PREREQ: PHY 555</i>				
				01	LEC	TUTH	CHAKRAVART	PHYSICS	
PHY	565	QUANTUM ELECTRONICS I	3.0		<i>PREREQ: PHY 505 &amp; PHY 511</i>				
				01	LEC	TUTH	METCALF	PHYSICS	
PHY	580	SPECIAL RES PROJECTS	1.0-12.0		<i>REMARK: EACH PROF HAS INDIV SEC</i>				
				01	TUT	HTBA	ALLEN		
				02	TUT	HTBA	LAMBE		
				03	TUT	HTBA	KOCH		
				04	TUT	HTBA	BALAZS		
				05	TUT	HTBA	KIVELSON		
				06	TUT	HTBA	BROWN		
				07	TUT	HTBA	COURANT		
				08	TUT	HTBA	DEZAFRA		
				09	TUT	HTBA	DRESDEN		
				10	TUT	HTBA	BRENNAN		
				11	TUT	HTBA	ENGELMANN		
				12	TUT	HTBA	ARCHIE		
				13	TUT	HTBA	FEINGOLD		
				14	TUT	HTBA	FINOCCHIAR		
				15	TUT	HTBA	FOSSAN		
				16	TUT	HTBA	FOX		
				17	TUT	HTBA	PERK		
				18	TUT	HTBA	GOLDHABER		
				19	TUT	HTBA	GOOD		
				20	TUT	HTBA	GRAF		
				21	TUT	HTBA	GRANNIS		
				22	TUT	HTBA	JACKSON		
				23	TUT	HTBA	KAHN		
				24	TUT	HTBA	KAO		
				25	TUT	HTBA	KIRZ		
				26	TUT	HTBA	KUO		
				27	TUT	HTBA	BRAUNMUNZI		
				28	TUT	HTBA	LEE L		
				29	TUT	HTBA	LEE FRANZI		
				30	TUT	HTBA	LUKENS		
				31	TUT	HTBA	MCCARTHY		
				32	TUT	HTBA	MCCOY		
				33	TUT	HTBA	MCGRATH		
				34	TUT	HTBA	METCALF		
				35	TUT	HTBA	MOULD		
				36	TUT	HTBA	MUETHER		
				37	TUT	HTBA	NATHANS		
				38	TUT	HTBA	NIEH		
				39	TUT	HTBA	STERMAN		
				40	TUT	HTBA	PAUL		
				41	TUT	HTBA	CHAKRAVART		
				42	TUT	HTBA	SILSBEE		
				43	TUT	HTBA	SMITH		
				44	TUT	HTBA	SPROUSE		
				45	TUT	HTBA	STRASSENBU		
				46	TUT	HTBA	SWARTZ		
				47	TUT	HTBA	SHROCK		
				48	TUT	HTBA	WEISBERGER		
				49	TUT	HTBA	WILCOX		
				50	TUT	HTBA	YANG		
				51	TUT	HTBA	NEAL		
				52	TUT	HTBA	VANNIEUWEN		
				53	TUT	HTBA	STEPHENS		
				54	TUT	HTBA	MARX		
				55	TUT	HTBA	ROECK		
				56	TUT	HTBA	RHOADES-BR		
				57	TUT	HTBA	BURROWS		
				58	TUT	HTBA	STACHEL		
PHY	585	SPECIAL STUDY	1.0-12.0		<i>REMARK: EACH PROF HAS INDIV SEC</i>				
				01	TUT	HTBA	ALLEN		
				02	TUT	HTBA	LAMBE		
				03	TUT	HTBA	KOCH		
				04	TUT	HTBA	BALAZS		
				05	TUT	HTBA	KIVELSON		
				06	TUT	HTBA	BROWN		
				07	TUT	HTBA	COURANT		
				08	TUT	HTBA	DEZAFRA		
				09	TUT	HTBA	DRESDEN		
				10	TUT	HTBA	BRENNAN		
				11	TUT	HTBA	ENGELMANN		
				12	TUT	HTBA	ARCHIE		
				13	TUT	HTBA	FEINGOLD		
				14	TUT	HTBA	FINOCCHIAR		
				15	TUT	HTBA	FOSSAN		
				16	TUT	HTBA	FOX		
				17	TUT	HTBA	PERK		
				18	TUT	HTBA	GOLDHABER		
				19	TUT	HTBA	GOOD		

DEPT	COURSE	TITLE	CREDITS	SECT	TYPE	MEETING TIMES	INSTRUCTOR	LOCATION
				20	TUT	HTBA	GRAF	
				21	TUT	HTBA	GRANNIS	
				22	TUT	HTBA	JACKSON	
				23	TUT	HTBA	KAHN	
				24	TUT	HTBA	KAO	
				25	TUT	HTBA	KIRZ	
				26	TUT	HTBA	KUO	
				27	TUT	HTBA	BRAUNMUNZI	
				28	TUT	HTBA	LEE L	
				29	TUT	HTBA	LEE FRANZI	
				30	TUT	HTBA	LUKENS	
				31	TUT	HTBA	MCCARTHY	
				32	TUT	HTBA	MCCOY	
				33	TUT	HTBA	MCGRATH	
				34	TUT	HTBA	METCALF	
				35	TUT	HTBA	MOULD	
				36	TUT	HTBA	MUETHER	
				37	TUT	HTBA	NATHANS	
				38	TUT	HTBA	NIEH	
				39	TUT	HTBA	STERMAN	
				40	TUT	HTBA	PAUL	
				41	TUT	HTBA	CHAKRAVART	
				42	TUT	HTBA	SILSBEE	
				43	TUT	HTBA	SMITH	
				44	TUT	HTBA	SPROUSE	
				45	TUT	HTBA	STRASSENBU	
				46	TUT	HTBA	SWARTZ	
				47	TUT	HTBA	SHROCK	
				48	TUT	HTBA	WEISBERGER	
				49	TUT	HTBA	WILCOX	
				50	TUT	HTBA	YANG	
				51	TUT	HTBA	NEAL	
				52	TUT	HTBA	VANNIEWENH	
				53	TUT	HTBA	STEPHENS	
				54	TUT	HTBA	MARX	
				55	TUT	HTBA	ROCEK	
				56	TUT	HTBA	RHOADES-BR	
				57	TUT	HTBA	BURROWS	
				58	TUT	HTBA	STACHEL	
PHY	595	MASTERS THESIS RES	1.0-12.0			REMARK: MAY BE REPEATED. S/U GRADING		
				01	TUT	HTBA	ALLEN	
				02	TUT	HTBA	LAMBE	
				03	TUT	HTBA	KOCH	
				04	TUT	HTBA	BALAZS	
				05	TUT	HTBA	KIVELSON	
				06	TUT	HTBA	BROWN	
				07	TUT	HTBA	COURANT	
				08	TUT	HTBA	DEZAFRA	
				09	TUT	HTBA	DRESDEN	
				10	TUT	HTBA	BRENNAN	
				11	TUT	HTBA	ENGELMANN	
				12	TUT	HTBA	ARCHIE	
				13	TUT	HTBA	FEINGOLD	
				14	TUT	HTBA	FINOCCHIAR	
				15	TUT	HTBA	FOSSAN	
				16	TUT	HTBA	FOX	
				17	TUT	HTBA	PERK	
				18	TUT	HTBA	GOLDHABER	
				19	TUT	HTBA	GOOD	
				20	TUT	HTBA	GRAF	
				21	TUT	HTBA	GRANNIS	
				22	TUT	HTBA	JACKSON	
				23	TUT	HTBA	KAHN	
				24	TUT	HTBA	KAO	
				25	TUT	HTBA	KIRZ	
				26	TUT	HTBA	KUO	
				27	TUT	HTBA	BRAUN-MUNZ	
				28	TUT	HTBA	LEE L	
				29	TUT	HTBA	LEE FRANZI	
				30	TUT	HTBA	LUKENS	
				31	TUT	HTBA	MCCARTHY	
				32	TUT	HTBA	MCCOY	
				33	TUT	HTBA	MCGRATH	
				34	TUT	HTBA	METCALF	
				35	TUT	HTBA	MOULD	
				36	TUT	HTBA	MUETHER	
				37	TUT	HTBA	NATHANS	
				38	TUT	HTBA	NIEH	
				39	TUT	HTBA	STERMAN	
				40	TUT	HTBA	PAUL	
				41	TUT	HTBA	CHAKRAVART	
				42	TUT	HTBA	SILSBEE	
				43	TUT	HTBA	SMITH	
				44	TUT	HTBA	SPROUSE	
				45	TUT	HTBA	STRASSENBU	
				46	TUT	HTBA	SWARTZ	
				47	TUT	HTBA	SHROCK	
				48	TUT	HTBA	WEISBERGER	
				49	TUT	HTBA	WILCOX	
				50	TUT	HTBA	YANG	
				51	TUT	HTBA	NEAL	
				52	TUT	HTBA	VANNIEWENH	
				53	TUT	HTBA	STEPHENS	
				54	TUT	HTBA	MARX	
				55	TUT	HTBA	ROCEK	
				56	TUT	HTBA	RHOADES-BR	
				57	TUT	HTBA	BURROWS	
				58	TUT	HTBA	STACHEL	
PHY	599	GRADUATE SEMINARS	1.0	01	SEM	TU	DEZAFRA	PHYSICS B134
				02	SEM	M	LUKENS	PHYSICS P112
							GRANNIS	
							SPROUSE	
PHY	600	PRACTICUM	2.0			REMARK: SEE INDIVIDUAL INSTRUCTOR		
				01	SEM	HTBA	MOULD	
PHY	611	QUANTUM FLD THRY II	3.0	01	LEC	TUTH	STERMAN	PHYSICS P112
PHY	620	RELATIVITY	3.0	01	LEC	TUTH	WEISBERGER	PHYSICS P123
PHY	670	SEM THEOR PHYSICS	1.0	01	SEM	M	ROCEK	PHYSICS C120
PHY	672	SEMINAR ELEM PARTCL	1.0	01	SEM	TH	FINOCCHIAR	PHYSICS D133
PHY	674	SEM NUCLR PHYSICS	1.0	01	SEM	TU	MCGRATH	PHYSICS C120
				02	SEM	TH	KUO	PHYSICS C133
PHY	676	SEM SOLID STAT PHY	1.0	01	SEM	F	CHAKRAVART	PHYSICS C120

DEPT	COURSE	TITLE	CREDITS	SECT	TYPE	MEETING TIMES	INSTRUCTOR	LOCATION	
PHY	680	SPEC TOP THEOR PHYS	3.0	01	LEC	HTBA	PERK		
PHY	684	SPEC TOPCS NUCL PHYS	3.0	01	LEC	HTBA	GOLDBABER	PHYSICS	P112
PHY	698	COLLOQUIUM	1.0	01	SEM	W 03:30-06:00	BROWN	OLD PHYSICS	137
PHY	699	THESIS RESEARCH	1.0-15.0				HANSSON		
							STEPHENS		
							ALLEN		
							LAMBE		
							KOCH		
							BALAZS		
							KIVELSON		
							BROWN		
							COURANT		
							DEZAFRA		
							DRESDEN		
							BRENNAN		
							ENGELMANN		
							ARCHIE		
							FEINGOLD		
							FINOCCHIAR		
							FOSSAN		
							FOX		
							PERK		
							GOLDBABER		
							GOOD		
							GRAF		
							GRANNIS		
							JACKSON		
							KAHN		
							KAO		
							KIRZ		
							KUO		
							BRAUNMUNZI		
							LEE L		
							LEE FRANZI		
							LUKENS		
							MCCARTHY		
							MCCOY		
							MCGRATH		
							METCALF		
							MOULD		
							MUETHER		
							NATHANS		
							NIEH		
							STERMAN		
							PAUL		
							CHAKRAVART		
							SILSBEE		
							SMITH		
							SPROUSE		
							STRASSENBU		
							SWARTZ		
							SHROCK		
							WEISBERGER		
							WILCOX		
							YANG		
							NEAL		
							VANNIEWENH		
							STEPHENS		
							MARX		
							ROCEK		
							RHOADES-BR		
							BURROWS		
							STACHEL		
<b>POL COURSES</b>									
POL	511	INTRO METH:PUB AFFRS	3.0	01	LEC	TU 07:00-09:30PM	PIJACKI	SOCBEHAV SCI	N705
POL	529	POLICY TACTICS	3.0	01	REC	M 06:00-07:00PM	STAFF		
POL	530	# HOUSING POLICY	3.0	01	LEC	TH 07:00-09:30PM	KLEIN	SOCBEHAV SCI	N705
POL	535	EVALUATION	3.0	01	LEC	W 07:00-09:30PM	SCHNEIDER	SOCBEHAV SCI	N702
POL	538	URBAN POLITICS	3.0	01	LEC	M 07:00-09:30PM	PETRICK	SOCBEHAV SCI	N702
POL	551	FOUND:POL PSY/BEHAV	3.0	01	LEC	TH 02:00-04:30	SCHNEIDER	SOCBEHAV SCI	N702
POL	553	FOUNDATION: COMP	3.0	01	LEC	TU 01:30-04:00	IYENGAR	SOCBEHAV SCI	N705
POL	598	THESIS REGISTRATION	1.0	01	LEC	W 02:00-04:30	SCARROW	SOCBEHAV SCI	N705
POL	599	INDEPENDENT STUDY	1.0-6.0	01	TUT	HTBA	SCHNEIDER		
POL	604	APPLIED DATA ANAL II	3.0	01	TUT	HTBA	SCHNEIDER		
POL	611	RESEARCH PRACTICUM	3.0	01	LEC	MW 11:00-12:15	SEGAL	SOCBEHAV SCI	N705
POL	661	ADV TOP: POL PSY/BEH	3.0	01	TUT	HTBA	NORPOTH		
POL	677	POLITICAL ELITES	3.0	01	LEC	TU 10:00-12:30	LODGE	SOCBEHAV SCI	N705
POL	680	INDEPENDENT STUDY	1.0-6.0	01	LEC	F 10:30-01:00	MYERS	SOCBEHAV SCI	N705
POL	681	INDEPENDENT STUDY	1.0-6.0	01	TUT	HTBA	NORPOTH		
POL	699	DISSERTATION:RESEARC	1.0-12.0	01	TUT	HTBA	NORPOTH		
<b>POR COURSES</b>									
POR	500	READING PORTUGUESE	3.0	01	LEC	HTBA	NUNES		



DEPT	COURSE	TITLE	CREDITS	SECT	TYPE	MEETING TIMES	INSTRUCTOR	LOCATION
<b>PSY COURSES</b>								
PSY	502	CORRELATION&REGRESSN	3.0			<i>PREREQ: UNDERGRADUATE STATISTICS AND PSY 501 OR INSTRUCTORS PERMISSION</i>		
				01	LEC	TUTH 02:15-03:30	CROSS	SOCBEHAV SCI N104
PSY	504	FIRST YEAR LECTURES	0.0-0.0	01	LEC	TH 12:30-01:30	MORRISON	CENTRAL HALL 043
PSY	509	PRACT COMPUTER APPL	0.0-1.0			<i>PREREQ: PSY PHD STDT NOT ADVANCED TO CANDIDACY;PRE-OR COREQ SEC 2:PSY 502</i>		
						<i>REMARK: S/U GRADING ONLY</i>		
				01	TUT	HTBA	MORRISON	
				02	TUT	TH 09:30-11:30	CROSS	PSYCHOLOGY A 258
PSY	510	HISTORY OF PSYCHOLOG	3.0	01	LEC	W 09:30-12:00	BRAMEL	PSYCHOLOGY B 248
PSY	512	COGNITION & MEMORY	3.0	01	LEC	TU 09:30-12:00	JOHNSON	PSYCHOLOGY A 356
PSY	516	PRACT IN EXPERIMNTL	3.0	01	LEC	W 10:30-01:00	RACHLIN	PSYCHOLOGY B 146
PSY	524	COGNITIVE DEVELOPMNT	3.0	01	LEC	M 01:00-03:30	NEWMAN	SOCBEHAV SCI N103
PSY	534	BEHVR ASSMT:THRY,PRC	3.0			<i>PREREQ: PSY 533; CLINICAL DOCTORAL STUDENT. COREQ: PSY 601</i>		
				01	LEC	M 10:30-01:00	LEVINE F	SOCBEHAV SCI N110
PSY	535	ADV RESEARCH METHODS	3.0			<i>PREREQ: PSY 501,502; CLINICAL DOCTORAL STUDENT</i>		
				01	LEC	M 03:00-06:00	WOOD	PSYCHOLOGY B 352
PSY	537	CHILD & ADOLESCENT	3.0			<i>PREREQ: PSY 538; CLINICAL DOCTORAL STUDENT. COREQ: PSY 602</i>		
						<i>REMARK: COORDINATED WITH PSY 602</i>		
				01	LEC	M 01:00-04:00	OLEARY S	PSYCHOLOGY B 316
				01	LEC	W 01:00-03:00		
PSY	542	PROSEM DEVELOP METHD	3.0			<i>PREREQ: PSY 541</i>		
				01	SEM	HTBA	HAY	SOCBEHAV SCI S149
PSY	556	SOCIAL PSYCH RES SEM	3.0			<i>PREREQ: SOC PSY DOCTORAL STUDENT</i>		
						<i>REMARK: MAY BE REPEATED</i>		
				01	SEM	TH 03:30-06:30	FRIEND	PSYCHOLOGY B 248
PSY	560	NEUROPSYCHOLOGY	3.0	01	LEC	TH 07:00-09:30PM	STAMM	PSYCHOLOGY A 356
PSY	584	EXPERIMENTAL COLLOQ	0.0-3.0	01	TUT	TU 04:00-06:30	RACHLIN	
PSY	600	TEACHG METHDS & PRACT	1.0-3.0			<i>PREREQ: APPOINTMENT AS TCH ASST OR GRAD INSTRUCTOR;INSTRUCTOR'S PERMISSION</i>		
				30	TUT	MW 09:30-10:20	PETERSON	PSYCHOLOGY A 130
PSY	601	1ST YR CLIN PRACTICM	1.0			<i>PREREQ: COREQ:PSY 533,PSY 534;SECOND YEAR STUDENTS</i>		
				01	TUT	HTBA	LEVINE F	
PSY	602	2ND YR CLIN PRACTICM	1.0			<i>PREREQ: COREQ: PSY 537,PSY 538</i>		
						<i>REMARK: S/U GRADING</i>		
				01	TUT	HTBA	WOOD	
				01	TUT	HTBA	COLLINS	
				28	TUT	HTBA	OLEARY K	
				34	TUT	HTBA	ROSS	
				45	TUT	HTBA	CARR	
				67	TUT	HTBA	FRIEDMAN	
PSY	604	CLIN PSYCH INTERNSHP	1.0-12.0			<i>REMARK: 4TH YEAR STUDENTS</i>		
				08	TUT	HTBA	DZURILLA	
				20	TUT	HTBA	LEVINE F	
				31	TUT	HTBA	POMERANZ	
PSY	608	NEUROPSYCH INTERNSHP	3.0-12.0	01	TUT	HTBA	STAMM	
PSY	620	#SPECIAL TOPICS	1.0-3.0			<i>PREREQ: PERMISSION OF INSTRUCTOR</i>		
						<i>REMARK: SEC 6 CROSSLISTED WITH PHI 611, SPRING,1985</i>		
				01	SEM	HTBA		
				06	SEM	M 01:00-03:30	CROSS	PSYCHOLOGY A 257
				14	SEM	HTBA	JOHNSON	
				42	TUT	HTBA		
				47	SEM	HTBA	HAY	SOCBEHAV SCI S149
				55	SEM	HTBA	WEIDNER	
				62	TUT	HTBA		
PSY	696	READINGS	1.0-12.0			<i>PREREQ: INSTRUCTOR'S PERMISSION</i>		
				01	TUT	HTBA	COLLINS	
				02	TUT	HTBA	BRAMEL	
				04	TUT	HTBA	BAARS	
				06	TUT	HTBA	CROSS	
				08	TUT	HTBA	D'ZURILLA	
				09	TUT	HTBA	EMMERICH	
				10	TUT	HTBA	FRIEND	
				11	TUT	HTBA	GLASS D	
				14	TUT	HTBA	JOHNSON	
				15	TUT	HTBA	JONES-EMME	
				17	TUT	HTBA	KAYE	
				18	TUT	HTBA	FINKE	
				20	TUT	HTBA	LEVINE, F.	
				21	TUT	HTBA	LEVINE, M.	
				24	TUT	HTBA	NEWMAN	
				26	TUT	HTBA	MORRISON	
				27	TUT	HTBA	NEALE	
				28	TUT	HTBA	O'LEARY, D	
				29	TUT	HTBA	O'LEARY, S	
				30	TUT	HTBA	PETERSON	
				31	TUT	HTBA	POMERANZ	
				32	TUT	HTBA	RACHLIN	
				34	TUT	HTBA	ROSS	
				35	TUT	HTBA	SQUIRES	
				36	TUT	HTBA	SPRINGER	
				37	TUT	HTBA	STAMM	
				38	TUT	HTBA	STERNGLANZ	
				39	TUT	HTBA	SILVERSTEI	
				40	TUT	HTBA	VALINS	
				42	TUT	HTBA	WHITEHURST	
				43	TUT	HTBA	WYERS	
				44	TUT	HTBA	WEINTRAUB	
				45	TUT	HTBA	CARR	
				46	TUT	HTBA	WOOD	
				47	TUT	HTBA	HAY	
				50	TUT	HTBA	BIRNS	
				51	TUT	HTBA	PETRY	
				52	TUT	HTBA	GAGNON	
				53	TUT	HTBA	GREEN RICH	
				55	TUT	HTBA	WEIDNER	
				56	TUT	HTBA	DUBE	
				58	TUT	HTBA	LONEY	
				60	TUT	HTBA	TURSKY	
				61	TUT	HTBA		
				62	TUT	HTBA	PODOLNIK	
				64	TUT	HTBA	CRIMMINS	
				67	TUT	HTBA	FRIEDMAN J	
				70	TUT	HTBA	SPRAFKIN	

DEPT	COURSE	TITLE	CREDITS	SECT	TYPE	MEETING TIMES	INSTRUCTOR	LOCATION		
PSY	698	RESEARCH	1.0-12.0	73	TUT	HTBA	FRIEDMAN R			
				74	TUT	HTBA	STONE			
				<i>PREREQ: INSTRUCTOR'S PERMISSION</i>						
				01	TUT	HTBA	COLLINS			
				02	TUT	HTBA	BRAMEL			
				04	TUT	HTBA	BAARS			
				06	TUT	HTBA	CROSS			
				08	TUT	HTBA	D'ZURILLA			
				09	TUT	HTBA	EMMERICH			
				10	TUT	HTBA	FRIEND			
				11	TUT	HTBA	GLASS D			
				14	TUT	HTBA	JOHNSON			
				15	TUT	HTBA	JONES-EMME			
				17	TUT	HTBA	KAYE			
				18	TUT	HTBA	FINKE			
				20	TUT	HTBA	LEVINE, F.			
				21	TUT	HTBA	LEVINE, M.			
				24	TUT	HTBA	NEWMAN			
				26	TUT	HTBA	MORRISON			
				27	TUT	HTBA	NEALE			
				28	TUT	HTBA	O'LEARY, D			
				29	TUT	HTBA	O'LEARY, S			
				30	TUT	HTBA	PETERSON			
				31	TUT	HTBA	POMERANZ			
				32	TUT	HTBA	RACHLIN			
				34	TUT	HTBA	ROSS			
				35	TUT	HTBA	SQUIRES			
				36	TUT	HTBA	SPRINGER			
				37	TUT	HTBA	STAMM			
				38	TUT	HTBA	STERNGLANZ			
				40	TUT	HTBA	VALINS			
				42	TUT	HTBA	WHITEHURST			
				43	TUT	HTBA	WYERS			
				44	TUT	HTBA	WEINTRAUB			
				45	TUT	HTBA	CARR			
				46	TUT	HTBA	WOOD			
				47	TUT	HTBA	HAY			
				50	TUT	HTBA	BIRNS			
				51	TUT	HTBA	PETRY			
				52	TUT	HTBA	GAGNON			
				53	TUT	HTBA	GREEN RICH			
				55	TUT	HTBA	WEIDNER			
				56	TUT	HTBA	DUBE			
				58	TUT	HTBA	LONEY			
				60	TUT	HTBA	TURSKY			
				61	TUT	HTBA				
				62	TUT	HTBA	PODOLNIK			
63	TUT	HTBA								
64	TUT	HTBA	CRIMMINS							
70	TUT	HTBA	SPRAFKIN							
73	TUT	HTBA	FRIEDMAN							
74	TUT	HTBA	STONE							
PSY	699	DOCTORAL RESEARCH	1.0-12.0	<i>PREREQ: ADVANCEMENT TO CANDIDACY</i>						
				01	TUT	HTBA	COLLINS			
				02	TUT	HTBA	BRAMEL			
				04	TUT	HTBA	BAARS			
				06	TUT	HTBA	CROSS			
				08	TUT	HTBA	D'ZURILLA			
				09	TUT	HTBA	EMMERICH			
				10	TUT	HTBA	FRIEND			
				11	TUT	HTBA	GLASS D			
				14	TUT	HTBA	JOHNSON			
				15	TUT	HTBA	JONES-EMME			
				17	TUT	HTBA	KAYE			
				18	TUT	HTBA	FINKE			
				20	TUT	HTBA	LEVINE, F.			
				21	TUT	HTBA	LEVINE, M.			
				24	TUT	HTBA	NEWMAN			
				26	TUT	HTBA	MORRISON			
				27	TUT	HTBA	NEALE			
				28	TUT	HTBA	O'LEARY, D			
				29	TUT	HTBA	O'LEARY, S			
				30	TUT	HTBA	PETERSON			
				31	TUT	HTBA	POMERANZ			
				32	TUT	HTBA	RACHLIN			
				34	TUT	HTBA	ROSS			
				35	TUT	HTBA	SQUIRES			
				36	TUT	HTBA	SPRINGER			
				37	TUT	HTBA	STAMM			
				38	TUT	HTBA	STERNGLANZ			
				40	TUT	HTBA	VALINS			
				42	TUT	HTBA	WHITEHURST			
				43	TUT	HTBA	WYERS			
				44	TUT	HTBA	WEINTRAUB			
				45	TUT	HTBA	CARR			
				46	TUT	HTBA	WOOD			
				47	TUT	HTBA	HAY			
				49	TUT	HTBA	LOCKWOOD			
				50	TUT	HTBA	BIRNS			
				51	TUT	HTBA	PETRY			
				53	TUT	HTBA	GREEN RICH			
				55	TUT	HTBA	WEIDNER			
				56	TUT	HTBA	DUBE			
				58	TUT	HTBA	LONEY			
				60	TUT	HTBA	TURSKY			
				64	TUT	HTBA	CRIMMINS			
				70	TUT	HTBA	SPRAFKIN			
				73	TUT	HTBA	FRIEDMAN R			
				74	TUT	HTBA	STONE			
<b>RUS COURSES</b>										
RUS	517	HISTORY RUS LIT LANG	3.0	<i>PREREQ: GRADUATE IN RUSSIAN OR GOOD BACKGROUND IN RUSSIAN</i>						
				01	SEM	MWF 10:30-11:20	BETHIN	MELVILLE LBR N3062		
<b>SLV COURSES</b>										
SLV	501	SPC TOP SLAVIC LIT	3.0	<i>PREREQ: PERM OF INST</i>						
				<i>REMARK: SEM IN THE RUSSIAN NOVEL</i>						
				01	SEM	W 11:30-02:20	RZHEVSKY	SOCBEHAV SCI N103		
<b>SOC COURSES</b>										
SOC	502	QUANT ANLYS SOC DATA	3.0	01	LEC	TUTH 12:45-02:00	SCHWARTZ	SOCBEHAV SCI N403		
SOC	506	SOCIOLOGICAL THEORY	3.0	01	LEC	TUTH 05:30-06:45	RULE	SOCBEHAV SCI N403		
SOC	511	POPULATION ANALYSIS	3.0	01	SEM	MW 09:30-10:45	TYREE	SOCBEHAV SCI N403		



DEPT	COURSE	TITLE	CREDITS	SECT TYPE	MEETING TIMES	INSTRUCTOR	LOCATION
SPN	510	#20TH C SPAIN HISTRY	3.0	PREREQ: B.A. DEGREE 01 LEC	M 04:00-07:00	MONTORO	MELVILLE LBR S5407
SPN	541	#SPN LIT NARRATIVE	3.0	PREREQ: B.A. DEGREE REMARK: REPETITIVE 01 SEM	W 04:00-07:00	DEUTSCH	MELVILLE LBR S5407
SPN	571	#WOMEN POETS&SUBJECT	3.0	PREREQ: B.A.DEGREE 01 LEC	TU 04:00-07:00	GIORDANO	MELVILLE LBR S5407
SPN	588	DIRECTED MA RESEARCH	1.0-6.0	PREREQ: PERMIS OF GRADUATE STUDIES DIRECTOR OR INSTR REMARK: VARIABLE AND REPETITIVE CREDIT 01 TUT	HTBA	STAFF	
SPN	596	DIR IND INDIV STUDY	1.0-6.0	REMARK: S/U GRD;REP UP TO 9 CRS;STUDENTS NOT ON DEPT APP LST WL BE DEREGIS 01 TUT	HTBA	DELACAMPA	
				02 TUT	HTBA	DEUTSCH	
				03 TUT	HTBA	GIORDANO	
				04 TUT	HTBA	LASTRA	
				05 TUT	HTBA	KLEIN-ANDR	
				06 TUT	HTBA	MONTORO	
				07 TUT	HTBA	RIVERS	
				08 TUT	HTBA	SABAT RIVE	
				09 TUT	HTBA	PATO	
				10 TUT	HTBA	NUNES	
SPN	612	#GOLDEN AGE	3.0	PREREQ: ADVANCED DOCTORAL CANDIDACY OR PERMIS OF INSTR 01 SEM	F 02:00-04:30	RIVERS	MELVILLE LBR S5407
SPN	682	DIRECTED READINGS	1.0-9.0	REMARK: ONLY FOR STUD WHO HAVE COMP ALL CRS WRK & HAV'NT TAKEN COMP EXAM 01 TUT	HTBA	STAFF	
SPN	696	DIR DOCTORAL RSCH	1.0-9.0	REMARK: ONLY FOR STUDENTS WHO HAVE COMPLETED PHD COMP EXAMS 01 TUT	HTBA	STAFF	
<b>THR COURSES</b>							
THR	503	DRAMATIC LITERATURE	3.0	01 LEC	M 05:30-08:00	BROWN	FINE ARTS 3018
				01 LEC	F 04:00-06:30		FINE ARTS 3018
THR	504	PLAYWRITING	3.0	01 LEC	TU 05:00-07:30	LEVY	FINE ARTS 3018
THR	505	CONTEMPORARY THEATRE	3.0	01 LEC	M 03:00-05:30	ROSEN	FINE ARTS 3018
THR	523	DIRECTING	3.0	PREREQ: ADMISSION TO MA OR MFA PROGRAM OR PERM OF DIR OF GRADUATE STUDIES 01 LEC	MW 05:30-06:30	NEUMILLER	FINE ARTS 1010
				01 LAB	MW 06:30-07:30		FINE ARTS 1010
THR	550	TEACHING SEMINAR	3.0	PREREQ: ADMISSION TO THE M.A. PROGRAM REMARK: S/U GRADING ONLY 01 TUT	HTBA	LEVY	FINE ARTS
				01 LAB	HTBA		

DEPT	COURSE	TITLE	CREDITS	SECT	TYPE	MEETING TIMES	INSTRUCTOR	LOCATION
<b>CEA COURSES</b>								
CEA	518	THEMES/ISSUS WST ART	3.0	01	LEC	TH 05:45-08:15PM	JAFFE	
REMARK: INCLUDES LISTENING TO 30 RADIO LECTURES & ATTENDING 5 CLASSES								
<b>CEB COURSES</b>								
CEB	505	HIST.-L.I. ENVIR.	3.0	21	LEC	TH 06:00-08:30PM	NEWTON	
CEB	533	INTRO TO OENOLOGY	3.0	01	LEC	W 06:00-08:30PM	LYMAN	SOCBEHAV SCI N101
<b>CEC COURSES</b>								
CEC	542	EDU EXCEPT CHILDREN	3.0	01	LEC	TU 05:30-08:00	ZUSMER	SOCBEHAV SCI N101
CEC	547	LAB INSTRC STRAT SPC	3.0	21	LEC	M 07:00-09:30PM	BECKER	
PREREQ: CEC 542 AND CEC 546 OR PERMISSION OF THE INSTRUCTOR								
REMARK: TO BE GIVEN AT HUNTINGTON H.S. OAKWOOD & MCKAY ROADS								
CEC	552	CMPUT APPS FOR GIFTD	3.0	21	LEC	TU 05:30-08:00	BATCHER	
PREREQ: CEC 548 OR EQUIVALENT OR MICROCOMPUTER EXPERIENCE OR PERMISSION								
REMARK: TO BE GIVEN AT THE MANASQUAN SCHOOL (CENTRAL OFFICE) DIX HILLS								
<b>CED COURSES</b>								
CED	501	AMER CULT 20TH CNTRY	3.0	01	LEC	M 06:00-08:30PM	BASKIN	PSYCHOLOGY A 146
CED	599	INDEPENDENT STUDY	1.0-6.0	01	TUT		WISHNIA	
PREREQ: PERMISSION OF CED REQUIRED								
				02	TUT			
				03	TUT			
				04	TUT			
				05	TUT		SEIFMAN	
				06	TUT			
				07	TUT			
				08	TUT		PORCINO	
				09	TUT			
				10	TUT		LIAO	
				11	TUT			
				12	TUT			
<b>CEE COURSES</b>								
CEE	508	TCH SOC STDS VIA HUM	3.0	01	LEC	TH 06:30-09:00PM	LOMBARDI	SOCBEHAV SCI N107
CEE	509	CHILD'S LIT ELEM SCH	3.0	01	LEC	M 07:00-09:30PM	HIGGINS	SOCBEHAV SCI N117
				21	LEC	TU 07:00-09:30PM	SCHUMANN	
CEE	512	HIS CNTMP ED THOUGHT	3.0	01	LEC	TU 06:00-08:30PM	BASKIN	PSYCHOLOGY A 146
CEE	515	PRBLMS SCHOOL ADMIN	3.0	01	LEC	M 06:30-09:00PM	BONAHUE	SOCBEHAV SCI N102
CEE	522	LIT&COMP SCNDRY SCHL	3.0	21	LEC	TU 06:00-08:30PM	POLASKI	
REMARK: WILL BE GIVEN AT EASTERN CAMPUS, SUFFOLK CC, SPEONK-RVRHD RD, RIVERHLD								
CEE	530	CURR DEV EL SCH SCI	3.0	01	LEC	W 06:30-09:00PM	TRIOLO	OLD PHYSICS 206
CEE	532	WKSHP TCH READ EL SC	3.0	21	LEC	TU 07:00-09:30PM	LIPSET	
REMARK: TO BE GIVEN AT HUNTINGTON H.S.								
CEE	533	RESEARCH IN READING	3.0	01	LEC	TH 05:30-08:00	RESTAINO-B	SOCBEHAV SCI N101
PREREQ: COURSEWORK IN THE TEACHING OF READING WOULD BE HELPFUL								
CEE	598	TOPICS IN EDUCATION	1.0-6.0	01	LEC			
PREREQ: PERMISSION OF CED:246-3301								
				02	LEC			
				03	LEC			
				04	LEC			
				05	LEC			
				06	LEC			
				07	LEC			
				08	LEC			
<b>CEH COURSES</b>								
CEH	509	PHOTOG AS TEACH TOOL	3.0	01	LEC	TH 06:00-08:30PM	EDELSON	FINE ARTS 3216
CEH	512	PROJECT IN ART HIST	1.0-6.0	03	TUT		RUBIN	
PREREQ: PERMISSION OF INSTRUCTOR								
				06	TUT		EDELSON	
				07	TUT		GUILMAIN	
				08	TUT		POLCARI	
				11	TUT		KLEEGER	
				12	TUT		KORAS	
				14	TUT		JOYCE	
				15	TUT		WELDEN	
				17	TUT		KUSPIT	
				18	TUT		MOSKOWITZ	
				19	TUT		WHITE	
				20	TUT		PINDELL	
				21	TUT		JONAITIS	
				22	TUT		THOMPSON	
				23	TUT		LARESE	
				24	TUT		BEATMAN	
				25	TUT		THORNE	
				26	TUT		PEKARSKY	
				29	TUT		BUONAGURIO	
				30	TUT		COOPER	
CEH	514	STUDY IN STUDIO ART	3.0	03	TUT		RUBIN	
PREREQ: PERMISSION OF INSTRUCTOR								
REMARK: MAY BE REPEATED ONCE								
				06	TUT		EDELSON	
				07	TUT		GUILMAIN	
				08	TUT		POLCARI	
				11	TUT		KLEEGER	
				12	TUT		KORAS	
				14	TUT		JOYCE	
				15	TUT		WELDEN	
				17	TUT		KUSPIT	
				18	TUT		MOSKOWITZ	
				19	TUT		WHITE	
				20	TUT		PINDELL	
				21	TUT		JONAITIS	
				22	TUT		THOMPSON	
				23	TUT		LARESE	
				24	TUT		BEATMAN	
				25	TUT		THORNE	
				26	TUT		PEKARSKY	
				29	TUT		BUONAGURIO	
				30	TUT		COOPER	

DEPT	COURSE	TITLE	CREDITS	SECT	TYPE	MEETING TIMES	INSTRUCTOR	LOCATION		
CEH	538	# THE MODERN NOVEL	3.0	01	LEC	W	07:00-09:30PM	MCGRATH	HUMANITIES	287
CEH	567	EXPERIENCE OF MUSIC	3.0	01	LEC	TU	07:00-09:30PM	MICZNIK		
<b>CEI COURSES</b>										
CEI	501	FOUNDATNS HUMANITIES	3.0	01	SEM	M	07:00-09:30PM	GABARD	MELVILLE LBR	E4327
CEI	504	HUMN BEHAV/RTNL ACTN	3.0	01	LEC	M	05:30-08:00	GRANOVETTE	SOCBEHAV SCI	N101
CEI	505	SOC SCI METHODOLOGY	3.0	01	LEC	W	07:00-10:30PM	STALEY	SOCBEHAV SCI	N117
CEI	508	CAUSES OF CONFLICT	3.0	01	LEC	TH	05:30-08:00	GARDNER	HUMANITIES	287
CEI	522	POP ARTS AMER HIST	3.0	01	LEC	W	06:30-09:00PM	TAYLOR	SOCBEHAV SCI	N116
<b>CEL COURSES</b>										
CEL	522	ETHNC EXPER AMER LIT	3.0	01	LEC	M	05:30-08:00	KESSNER	HUMANITIES	315
<b>CEM COURSES</b>										
CEM	535	UNDESTAND ALCOHOLISM	3.0	21	LEC	W	06:00-08:30PM	WALSH		
<b>CEN COURSES</b>										
CEN	505	TCH JR H.S. CHMISTRY	3.0	01	LEC	S	10:00-12:30	KRISHNAN	CHEMISTRY	362
CEN	511	RCNT DSCVRES ASTRNMY	3.0	01	LEC	M	07:30-10:00PM	SOLOMON	EARTH&SPACE	177
CEN	539	MATH OF FINANCE &INS	3.0	01	LEC	TH	06:00-08:30PM	ADLER	PHYSICS	P117
CEN	543	MATHEMATICS TODAY	3.0	01	LEC	TU	06:00-08:30PM	LAWSON	PHYSICS	P117
CEN	561	INTRO CMPUTNG PASCAL	3.0	01	LEC	M	06:00-08:30PM	DIPPEL	ENGINEERING	110
CEN	562	ADVANCED PROGRAMMING	3.0	01	LEC	W	06:00-08:30PM	SHINDHELM	ENGINEERING	112
CEN	593	TECH.STRAT.ARM CNTRL	3.0	01	LEC	M	06:30-09:00PM	SAKITT	SOCBEHAV SCI	N110
CEN	594	LAW AND TECHNOLOGY	3.0	01	LEC	W	07:00-09:30PM	CADWELL	SOCBEHAV SCI	N110
CEN	598	TCHNLGY & HUMN VALUS	3.0	21	LEC	TH	07:00-09:30PM	HILL		
<b>CEP COURSES</b>										
CEP	506	COMPARATIVE PHYS ED	3.0	01	LEC	TH	07:00-09:30PM	MARTINGDAL	PHYSICS	P129
CEP	514	STUDY HUMAN MOVEMENT	3.0	01	LEC	TU	07:00-09:30PM	RAALF	PHYSICS	P129
<b>CER COURSES</b>										
CER	510	#SUFISM	3.0	01	LEC	TU	07:00-09:30PM	CHITTICK	SOCBEHAV SCI	N110
<b>CES COURSES</b>										
CES	502	SOC & CULT ANTHRO	3.0	01	LEC	TU	06:00-08:30PM	STEVENSON	SOCBEHAV SCI	N104
CES	510	MNGNG EMPLOYEE BNFIT	3.0	01	LEC	W	07:00-09:30PM	PRYOR	SOCBEHAV SCI	N405
CES	511	HUM RELATNS WRKPLACE	3.0	01	LEC	M	07:00-09:30PM	ENTINE	SOCBEHAV SCI	N405
CES	512	WRK LIFE IN ART.FCTN	3.0	01	LEC	TH	07:00-09:30PM	RONY	SOCBEHAV SCI	S216
CES	560	APPL LEARN BEHAV MOD	3.0	01	LEC	TU	07:00-09:30	KAYE	PSYCHOLOGY A	144
CES	589	COURTSHIP & MARRIAGE	3.0	01	LEC	TU	05:30-08:00	SELVIN	SOCBEHAV SCI	N117
CES	594	WAR & MILTRY INSTITS	3.0	01	LEC	TH	07:00-09:30PM	STEVENSON	SOCBEHAV SCI	N110
<b>CEX COURSES</b>										
CEX	506	RETIREMENT IN AM SOC	3.0	21	LEC	TU	07:00-09:30PM	ENTINE		
CEX	510	COMUTY RSRORCS ELDRLY	3.0	01	LEC	TU	05:00-07:30	PORCINO	SOCBEHAV SCI	N108
<b>CEY COURSES</b>										
CEY	502	ACCTG & FIN DEC ANAL	3.0	01	LEC	W	07:00-09:30PM	BRAWERMAN		

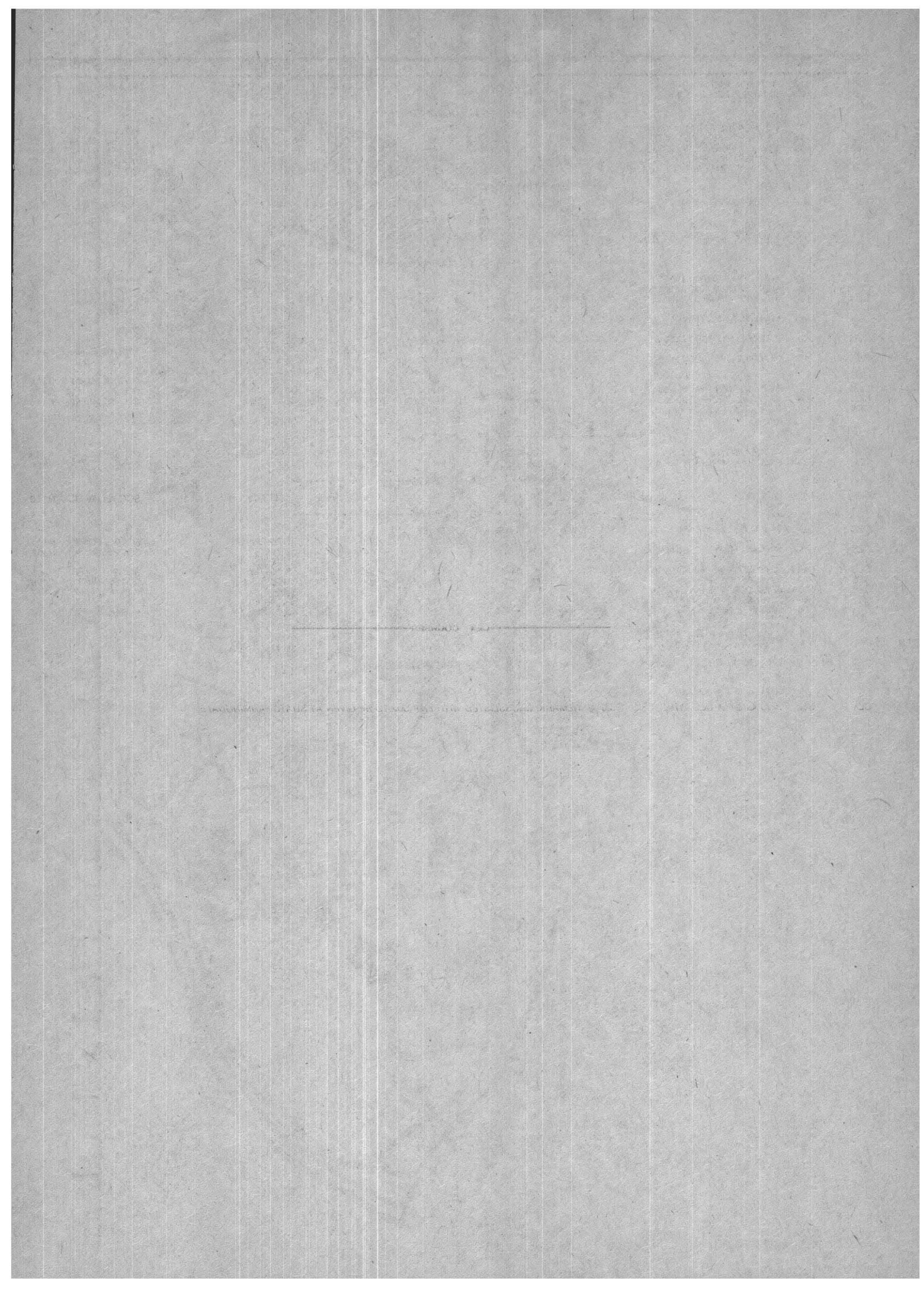

# STATE UNIVERSITY OF NEW YORK AT Stony Brook

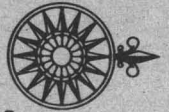



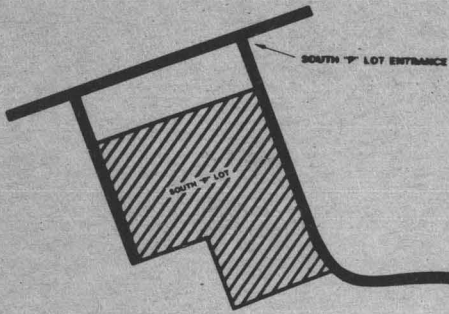

L.I.R.R.  
STATION

A B C D E F G H I J K L M N O

1  
2  
3  
4  
5  
6  
7  
8  
9



-  Visitor Parking
-  Academic Buildings
-  Residence Halls

 Free buses run regularly from North and South "P" Lots to the rest of the campus.

 Parking for the handicapped is available in most parking areas.

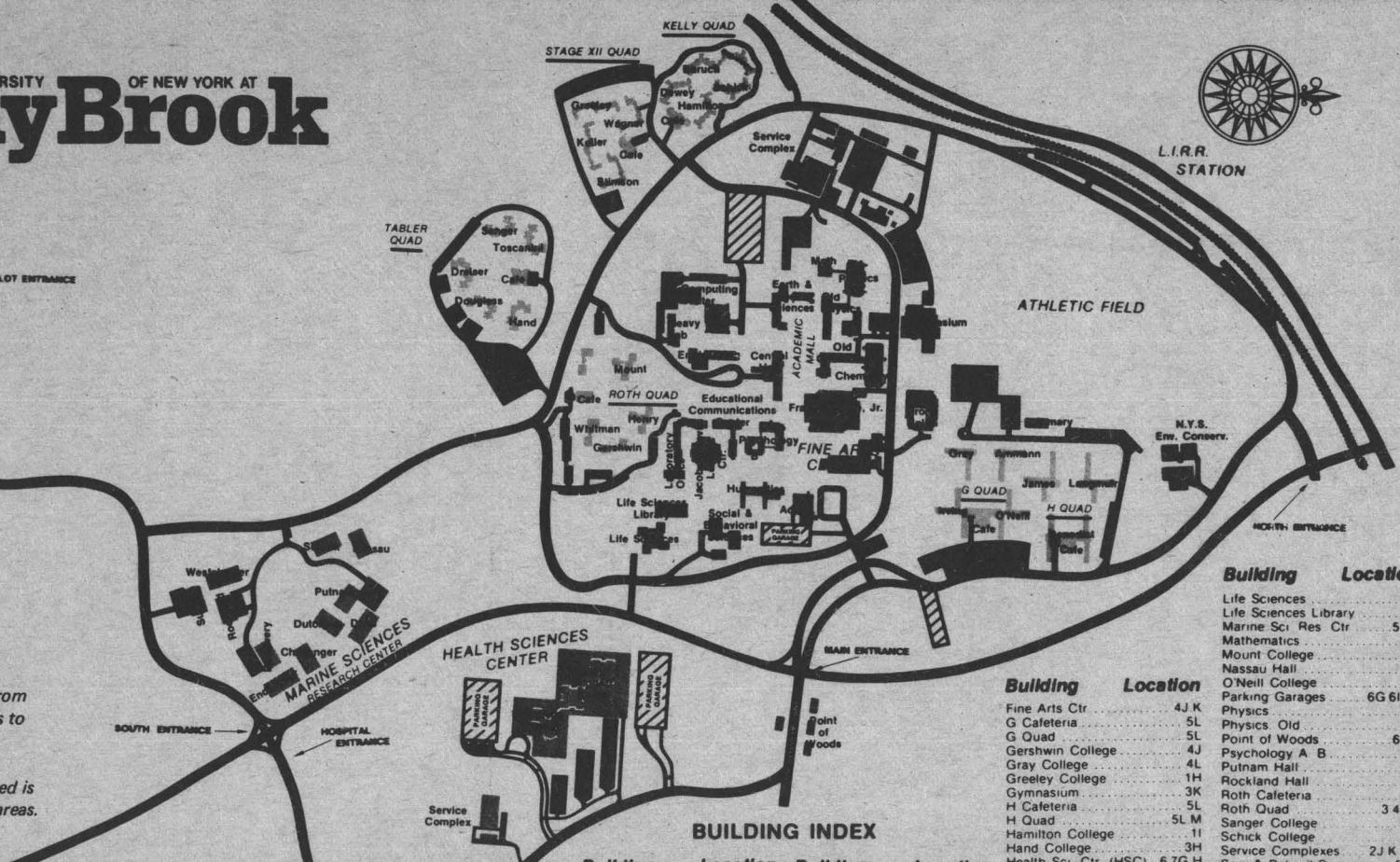

HARRY CHAPIN  
APT. COMPLEX

### Building Location

Life Sciences	5I
Life Sciences Library	5I
Marine Sci Res Ctr	56F
Mathematics	3J
Mount College	4I
Nassau Hall	5F
O'Neil College	5L
Parking Garages	6G 6I 5J
Physics	3K
Physics Old	3J
Point of Woods	67J
Psychology A-B	4J
Putnam Hall	6F
Rockland Hall	6E
Roth Cafeteria	4I
Roth Quad	3 4H I
Sanger College	2H
Schick College	1J
Service Complexes	2J K 7H
Soc & Behav'l Sciences	5I J
Stage XII Cafeteria	2I
Stage XII Quad	1H I
Stimson College	2I
Stony Brook Union	4K
Suffolk Hall	5F
Sullivan Hall	6E
Tabler Cafeteria	3H
Tabler Quad	3G H
Toscanni College	2H
University Hospital	7H
Van de Graaff Accelerator	3K
Wagner College	1I
Westchester Hall	5E
Whitman College	6H

### Building Location

Fine Arts Ctr	4J K
G Cafeteria	5L
G Quad	5L
Gershwyn College	4J
Gray College	4L
Greeley College	1H
Gymnasium	3K
H Cafeteria	5L
H Quad	5L M
Hamilton College	1I
Hand College	3H
Health Sci Ctr (HSC)	67G H
HSC Acad/Sup Areas	67 H
Henry College	4I
Humanities	5J
Infirmiry	2H
Int'l Col in Keller Col	4L
Irving College	5K
James College	4L
Keller College	2H
Kelly Cafeteria	2I
Kelly Quad	1I J
Laboratory Office	4 5I
Langmuir College	4M
Lec Ctr Jacob K Javits	4I
Library Frank Melville Jr	4J K

### BUILDING INDEX

Building	Location	Building	Location
Administration	5J	Dewey College	1I
Ammann College	4L	Discovery Hall	6F
Apts. Harry Chapin	9G	Douglass College	3H
Baruch College	1I	Dreiser College	3G
Benedict College	5L	Dutchess Hall	6F
Cardozo College	3H	Earth & Space Sciences	3J
Central Hall	4J	Ed'l Communications Ctr	4J
Challenger Hall	6F	Eisenhower College	1J
Chemistry	4K	Endeavour Hall	6F
Chemistry Old	4J	Engineering	3I
Commuter College SBU	4K	Engineering Heavy Lab	3I
Computing Ctr	3I	Engineering Light Lab	3I
Dana Hall	6F	NYS Env. Conservation	4M