

**STATE UNIVERSITY OF NEW YORK
COLLEGE AT FREDONIA**

2009 CAMPUS STATEMENT

SUNY Fredonia was founded in 1826 and the student body reflects the diversity of cultures in New York State. A coeducational institution, it attracts an almost equal number of men and women. Fredonia maintains a small university feeling, while offering regional and nationally-ranked academic programs. With a faculty of 430, SUNY Fredonia offers academic programs that reflect traditional liberal arts disciplines, as well as innovative career and professional degree options for more than 5,500 students in 79 undergraduate majors and 30 graduate programs.

Excellent facilities blend traditional with contemporary architecture, showcasing an exciting campus master plan designed by the renowned architectural firm of I.M. Pei Partners & Associates. The design consists of various components that include Maytum Hall, Williams Center, Daniel Reed Library, Michael C. Rockefeller Arts Center, McEwen Hall and Houghton Hall. The design of Daniel Reed Library earned I.M. Pei the 1969 Pre-stressed Concrete Institute Award and in 1972 the firm returned to Fredonia to complete the design of Erie Dinning Hall, and the Kirkland/Andrews Dormitory Complex.

Located in Chautauqua County, Fredonia's 249-acres and 36 facilities with over 2,000,000 square feet of gross floor area is the westernmost campus in the SUNY system. The region is an hour from Buffalo/Niagara Falls and is a destination for many interested in arts, culture, and all season recreation. The campus' modern facilities such as the Reed Library houses over one million research materials while the Music Library has over 15,000 recordings and over 30,000 music scores. Terrific athletic facilities provide a full range of personal recreational and intercollegiate sport activities and the Michael C. Rockefeller Arts Center is a draw for the entire community. Fredonia's nationally known music, theater, dance, and visual arts programs also draw tremendous artists from all around the world.

The previous year, which was overlapped between the 2004-2008 and 2008-2012 capital plans provided various campus improvements. These improvements included decommissioning of the existing HTHW system as the Campus Wide Satellite Boiler Project is nearing completion. Construction has been completed on the Williams Center Skylight Replacement Project, Site/Infrastructure phase II Project along with upgrades to Lake Way Drive Site Improvements and new roundabout to service the new Stadium Facility. In addition to these projects, the campus is currently engaged in bidding or construction of several projects that include SUNY Fredonia Incubator, Campus and Community Children's Center, Mason Hall Addition to 1051 and 1053, Maytum Hall Rehab Project, and Campus Wide Controls System Project. Presently the campus is in the design phase of various projects that include the design of the Science Technology Building, Fenton Hall Exterior Rehab, Erie Dining Hall Exterior Rehab, Williams Center Rehab, Upgrade Underground Electrical Distribution System, Mason Addition Roof Replacement, and Facilities Master Plan. Several of these projects will be ready for bidding by the end of 2009 or early 2010.

**State University of New York
College at Fredonia**

Facility Profile as of Fall 2008

Facility Profile	Instructional & Support	Residential	Total
Total State Owned Acreage			249
Total State Owned Buildings	31	14	45
Total State Owned Gross Square Feet (GSF)	1,249,357	773,471	2,022,828
Total State Owned Net Assignable Square Feet (NASF)	845,060	456,714	1,301,774

Age of Facilities	< 10 Years	10 – 40 Years	> 40 Years
Gross Square Feet	159,541	638,236	1,225,051
Percentage of Total GSF	7.9%	31.6%	60.6%

Net Assignable Space Distribution by Major Functional Area						
Instructional	Research	Student Activities	Administration	Central Services	Residential	Total
24%	2%	22%	6%	11%	35%	100%



Campus Owned Facilities

BUILDING INDEX

1. FENTON HALL
2. MASON HALL
- 2a. MASON HALL ANNEX
- 2b. MASON HALL ADDITION
- 2c. MASON RECITAL HALL (not shown)
4. ROCKEFELLAR ARTS CENTER
5. MAYTUM HALL
6. GREGORY HALL
7. ALUMNI HALL
8. MCGINNIES HALL
9. CRANSTON HALL (not shown)
12. REED LIBRARY
- 12a. REED LIBRARY ADDITION
13. McEWEN HALL
14. JEWETT HALL
15. HOUGHTON HALL
16. DODS HALL
18. LOGRASSO HALL
19. CHATAUGUA HALL
20. NIXON HALL
21. GRISSON HALL
22. KASLING HALL
23. ERIE HALL
24. DISNEY HALL
25. EISENHOWER HALL
26. PRESIDENT'S RESIDENCE
27. CENTRAL HEATING PLANT
28. MAINTENANCE BUILDING
29. FOOD SERVICE BUILDING
30. CAMPUS CENTER
31. IGOE HALL E
33. SCHULZ HALL F
34. HEMINGWAY HALL G
35. HENRIX HALL H
56. ALUMNI HOUSE
57. FENNER HOUSE
60. BUTLER BUILDING
61. THOMPSON HALL
62. FIELDHOUSE
63. HPE STORAGE
65. STOCKADE STORAGE
66. NIMO SWITCH (not shown)
67. ELECTRIC VAULT (not shown)
70. SALT STORAGE (not shown)
71. STEELE HALL NATATORIUM
74. UNIVERSITY COMMONS

- ACADEMIC BUILDINGS
- RESIDENTIAL BUILDINGS

FALL 2008

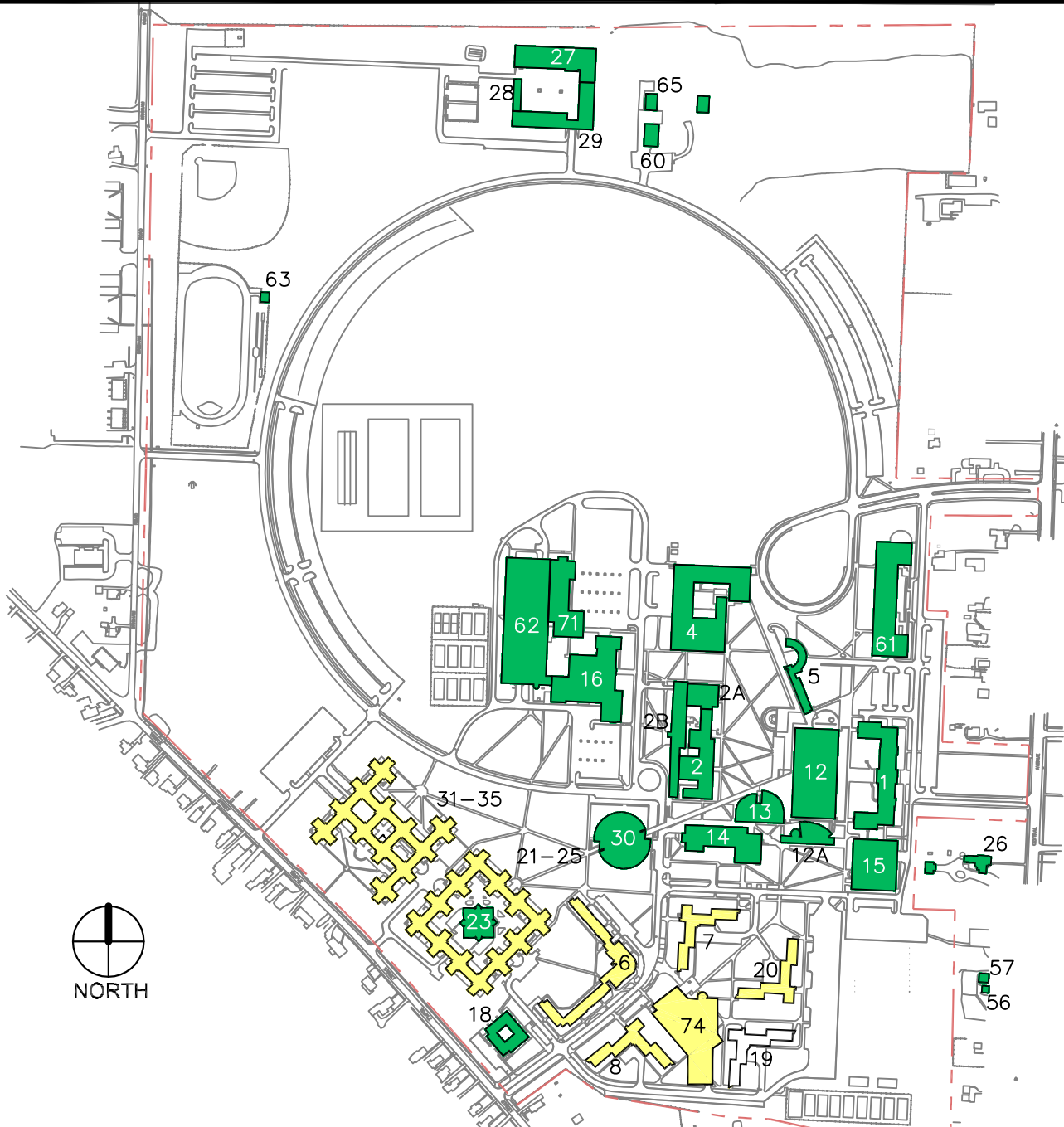



High Tech Incubator
(\$ 5.7 Million)



New Child Care Center
(\$ 4.6 Million)



Electrical Distribution Upgrade
(\$ 4.9 Million)



Campus Wide Satellite Boilers
(\$ 8.1 Million)

College at Fredonia

**State University of New York
2009/2010 Capital Program Plan
Major Ongoing Projects (Over \$1M Construction Cost)
As of July 31, 2009
(In Thousands)**

State University College at Fredonia

PROJECTS UNDER DESIGN

Capital Plan Projects	Total Estimated Project Cost	YTD Expend. thru 07-31-09	LTD Expend. thru 07-31-09	Encumbered Amount 07-31-09	Anticipated Start of Construction				
					09/10	10/11	11/12	12/13	13/14
Fenton Hall Exterior Rehabilitation	\$3,430	\$4	\$4	\$515		X			
Science Technology Building	\$60,000	\$0	\$0	\$6,261		X			
Erie Dining Hall Exterior Rehabilitation	\$1,176	\$0	\$0	\$0		X			
Reed Library Roof Replacement	\$1,388	\$0	\$0	\$0			X		
Rockefeller Arts Center Roof and Exterior Rehab	\$1,720	\$0	\$0	\$0		X			
Dods Hall Rehab	\$4,560	\$17	\$17	\$10	X				
Electrical Distribution Upgrade	\$4,901	\$0	\$0	\$706			X		

PROJECTS UNDER CONSTRUCTION

Capital Plan Projects	Total Estimated Project Cost	YTD Expend. thru 07-31-09	LTD Expend. thru 07-31-09	Encumbered Amount 07-31-09	Anticipated Completion Date				
					09/10	10/11	11/12	12/13	13/14
Rehabilitation of Mason Hall - Phase II	\$4,360	\$9	\$903	\$46			X		
Campus Wide Compliance Projects	\$1,650	\$16	\$743	\$140	X				
Campus Wide Satellite Boilers	\$8,131	\$585	\$6,516	\$1,595	X				
High Tech Incubator	\$5,700	\$1,822	\$3,374	\$2,110		X			
Rehabilitate Maytum Bldg - Phase II	\$5,697	\$8	\$395	\$5,430		X			
Site Lighting at Residence Row Drive and Parking	\$1,200	\$119	\$1,020	\$129	X				
New Child Care Center	\$4,600	\$452	\$767	\$3,545	X				
Data / Telecommunications Upgrades Various Buildings	\$2,100	\$33	\$1,041	\$5	X				
Services Complex Safety and Building Improvements	\$1,900	\$1	\$20	\$293				X	

**State University of New York
2009/2010 Capital Program Plan
Major Ongoing Projects (Over \$1M Construction Cost)
As of July 31, 2009
(In Thousands)**

State University College at Fredonia

PROJECTS UNDER CONSTRUCTION

Capital Plan Projects	Total Estimated Project Cost	YTD Expend. thru 07-31-09	LTD Expend. thru 07-31-09	Encumbered Amount 07-31-09	Anticipated Completion Date				
					09/10	10/11	11/12	12/13	13/14
Upgrade Security Control System - Various Buildings, Phase II	\$1,250	\$52	\$67	\$558				X	
Roadway & Sidewalk Reconstruction	\$1,322	\$44	\$44	\$381		X			

**State University of New York
2009/2010 Capital Program Plan
Future Planned Projects - Over \$1M Construction
As of July 31, 2009
(In Thousands)**

State University College at Fredonia

Capital Plan Projects	Total Estimated Project Cost	Funds Available	Funds Needed to Complete	SFY 2009/10 Phase \$	SFY 2010/11 Phase \$	SFY 2011/12 Phase \$	SFY 2012/13 Phase \$	SFY 2013/14 Phase \$
Rehabilitate Houghton	\$3,200	\$0	\$3,200					D \$630
Replace Bleachers/Equipment - Field House and Dods Hall	\$2,350	\$0	\$2,350	D \$250		C \$2,100		
Williams Center Rehabilitation	\$13,484	\$1,877	\$11,607	D \$1,877		C \$10,874		
Williams Center Rehabilitation		\$0				E \$733		
Addition/Renovate Rockefeller Arts Center	\$40,000	\$40,000		TBD				

PROJECT PHASES: A = Acquisition, D = Design, C = Construction, E = Equipment

**State University of New York
 Summary of Changes
 2009/2010 Capital Program Plan
 Project Cross-Reference: Current Year Status vs. Last Year
 (In Thousands)**

State University College at Fredonia

Capital Plan Project	2008 Estimated Project Cost	2009 Estimated Project Cost	Incr./Decr. In Estimate Cost
Projects Under Design			
Fenton Hall Exterior Rehabilitation	\$3,400	\$3,430	\$30
Rockefeller Arts Center Roof and Exterior Rehab		\$1,720	\$1,720
Dods Hall Rehab		\$4,560	\$4,560
Electrical Distribution Upgrade		\$4,901	\$4,901
Projects Under Construction			
Rehabilitation of Mason Hall - Phase II	\$2,685	\$4,360	\$1,675
Campus Wide Satellite Boilers	\$8,151	\$8,131	-\$20
Rehabilitate Maytum Bldg - Phase II	\$8,525	\$5,697	-\$2,828
Services Complex Safety and Building Improvements		\$1,900	\$1,900
Upgrade Security Control System - Various Buildings, Phase II		\$1,250	\$1,250
Roadway & Sidewalk Reconstruction		\$1,322	\$1,322
Completed Projects			
Rehabilitate Campus Center, Phase I Williams Hall	\$1,650	\$2,350	\$700
Campus Wide Natural Gas Upgrades	\$1,229	\$1,155	-\$74
Future Projects			
Replace Bleachers/Equipment - Field House and Dods Hall		\$2,350	\$2,350
Williams Center Rehabilitation		\$13,484	\$13,484