

**STATE UNIVERSITY OF NEW YORK
COLLEGE AT ONEONTA**

2009 CAMPUS STATEMENT

Established in 1889 as a state Normal School with the sole mission of training teachers, the College at Oneonta was a founding member of the State University of New York system in 1948. Today, SUNY Oneonta is a multi-purpose college of liberal arts and sciences, enrolling more than 5,600 students in over 60 undergraduate majors and nine graduate programs, and is noted for its outstanding and accessible faculty, excellent facilities and technology, and the natural beauty and appealing setting of its campus. The College's 250-acre main campus overlooks the scenic Susquehanna River Valley in central New York about halfway between Albany and Binghamton. The main campus has 43 buildings, as well as a Biological Field Station and the Cooperstown Graduate Program in Museum Studies on Otsego Lake in nearby Cooperstown, and a 250-acre College Camp about two miles from campus.

The campus facilities, grounds and infrastructure provide an outstanding learning environment. The Milne Library has the second largest collection among the SUNY colleges of arts and sciences, with 550,000 bound volumes, nearly 1,900 periodicals and newspaper subscriptions, and access to over 100 individual electronic databases. Campus computing facilities include a robust campus-wide network with wireless connectivity in all academic buildings. The Schumacher classroom building is fully equipped with the latest instructional technology, and all other teaching facilities have "smart classroom" capability.

Recent capital improvements include a complete renovation of the campus quad and arterial, a state-of-the-art fire alarm system, card access to residence halls, and renovations to the book store and all dining facilities. New facilities constructed within the last ten years include Alumni Field House, the new varsity soccer field, and one outdoor all-weather lit artificial turf field with a running track, and a 200-bed residence hall. A completely renovated Human Ecology Building has fully refurbished labs for computer-assisted design, chemistry, and food preparation programs. The renovation of Science I was completed in 2008, providing state of the art instructional facilities and labs, and a new planetarium. Additional renovations of the Fine Arts building are progressing and renovations of the main academic facility in Cooperstown began in 2009.

Our current Capital Plan includes \$66 million for Strategic Initiatives supporting renovations of two major academic buildings. Fizzelle Hall, our largest academic building which houses the Division of Education and several other arts and sciences departments, is in design with construction targeted for 2010-12. Renovation of Science Building II will follow Fizzelle Hall. With the completion of these renovations, the College will have renovated or upgraded all its academic buildings with the exception of the Chase Physical Education Building. The College is also embarked on an ambitious Ten-Year Dorm Capital Plan, with a major renovation of Tobey Hall completed for fall 2009, and Littell Hall renovations in process. The plan anticipates committing between \$8 to \$10 million annually in residence hall renovations and critical maintenance.

**State University of New York
College at Oneonta**

Facility Profile as of Fall 2008

| Facility Profile | Instructional & Support | Residential | Total |
|---|------------------------------------|--------------------|--------------|
| Total State Owned Acreage | | | 635 |
| Total State Owned Buildings | 41 | 17 | 58 |
| Total State Owned Gross Square Feet (GSF) | 1,439,269 | 853,829 | 2,293,098 |
| Total State Owned Net Assignable Square Feet (NASF) | 832,271 | 574,630 | 1,406,901 |

| Age of Facilities | < 10 Years | 10 – 40 Years | > 40 Years |
|--------------------------|----------------------|----------------------|----------------------|
| Gross Square Feet | 250,455 | 390,781 | 1,651,862 |
| Percentage of Total GSF | 10.9% | 17.0% | 72.0% |

| Net Assignable Space Distribution by Major Functional Area | | | | | | |
|---|-----------------|---------------------------|-----------------------|-------------------------|--------------------|--------------|
| Instructional | Research | Student Activities | Administration | Central Services | Residential | Total |
| 25% | 1% | 20% | 4% | 9% | 41% | 100% |



Campus Owned Facilities

BUILDING INDEX

- | | |
|-----------------------------|------------------------------|
| 2 BUGBEE HALL | 32 MACDUFF HALL STG XIII |
| 4 SCIENCE BLDG #1 | 33 WILSBACH HALL STG XI |
| 5 R.F. NETZER ADMIN. BLDG. | 35 EAST STREET GUEST HOUSE |
| 6 HODGDON INSTRUC RES CTR | 36 BIOLOGICAL FIELD STATION |
| 7 ALUMNI HALL | 37 HUNT COLLEGE UNION |
| 8 HUMAN ECOLOGY BUILDING | 38A TRAILER 1 (NOT SHOWN) |
| 9 C. HAL CHASE PHY ED BLDG | 38D TRAILER #8 (NOT SHOWN) |
| 10 HEATING PLANT | 40 MILNE LIBRARY |
| 11 MORRIS HALL | 41 HULBERT HALL DNG STG XV |
| 11A BACON HALL STG I | 41A HULBERT HL UNIT A STG XV |
| 11B DENISON HALL STG I | 41B HULBERT HL UNIT B STG XV |
| 12 WILBER HALL STG II | 41C HULBERT HL UNIT C STG XV |
| 13 TOBEY HALL STG III | 43 PRESIDENT'S RESIDENCE |
| 14 LITTELL HALL STG IV | 43A PRESIDENT'S GARAGE |
| 15 LEE HALL STG IV | 44 WEST STREET GUEST HOUSE |
| 16 GOLDING HALL STG VI | 45 VOLATILE STORAGE BUILDING |
| 17 MILLS HALL STG VII | 46 BUS GARAGE |
| 18 FORD HALL STG VII | 49 GROUNDS BUILDING |
| 19 GRANT HALL STG VII | 50 SALT SHED |
| 20 HAYS HALL STG VIII | 51 ALUMNI FIELD HOUSE |
| 21 HUNTINGTON HALL STG VIII | 52 UNDERGROUND BUNKER |
| 22 SHERMAN HALL STG VIII | 53 HIGGINS HALL |
| 23 FINE ARTS CENTER | 54 PAXTON ROSE PRESSBOX |
| 24 SCHUMACHER HALL | 57 BASEBALL LOCKER ROOM |
| 25 PHYS SCIENCE BLDG | 58 SUCF SITE TRAILER |
| 28 FITZELLE HALL | 59 TELESCOPE SHED |
| 27 SERVICE BLDG | 60 322 WEST STREET |
| 28 HEALTH CENTER | |
| 29 CURTIS HALL STG IX | |
| 30 BLODGETT HALL STG XI | |
| 31 MATTESON HALL STG IX | |

- ACADEMIC BUILDINGS
- RESIDENTIAL BUILDINGS

FALL 2008

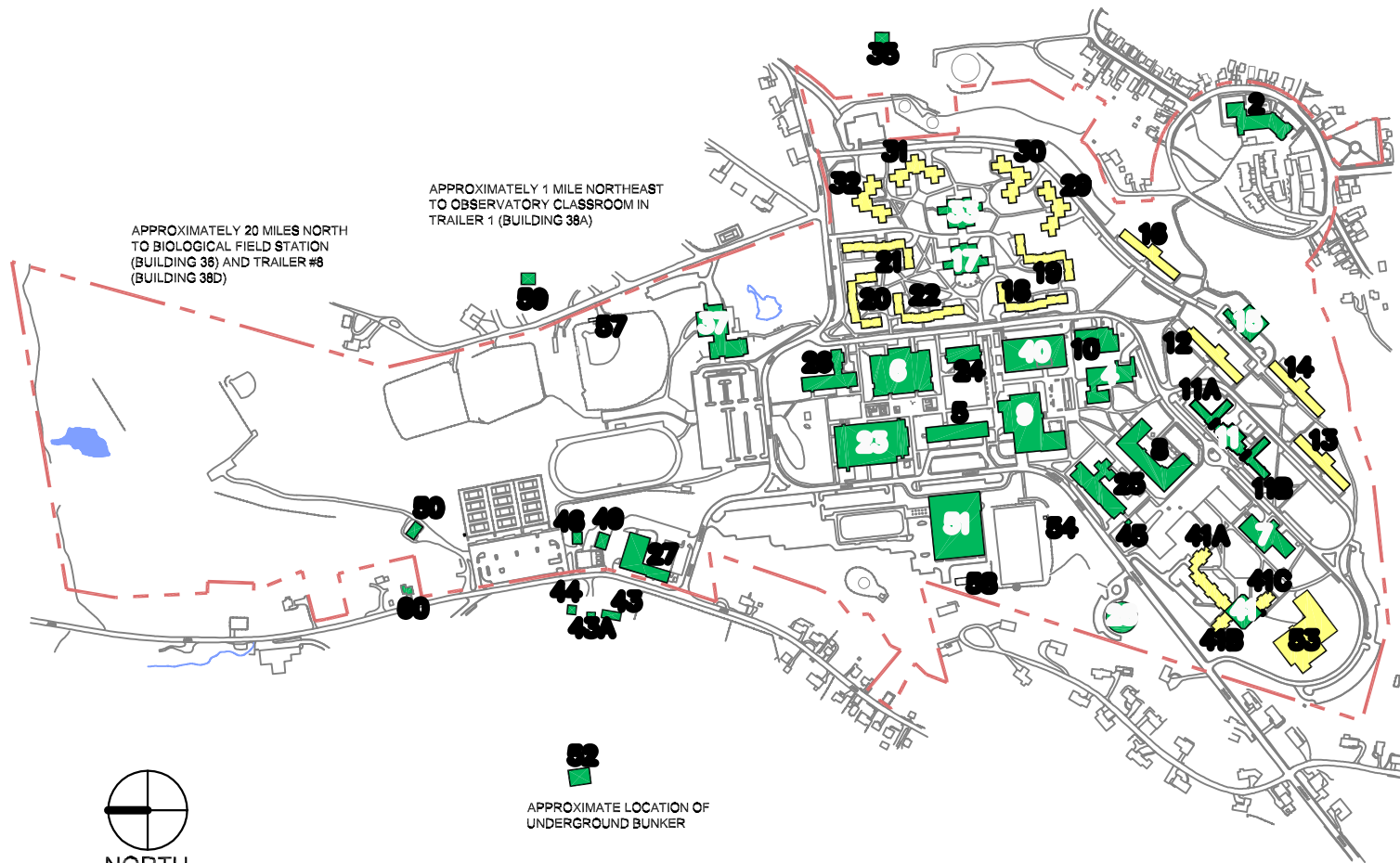



Rehab Biological Field Station
(\$ 7.0 Million)



Rehab Fitzelle Hall
(\$ 35.1 Million)



Rehab Fine Arts – Phase IIA
(\$ 6.8 Million)

College at Oneonta

**State University of New York
2009/2010 Capital Program Plan
Major Ongoing Projects (Over \$1M Construction Cost)
As of July 31, 2009
(In Thousands)**

State University College at Oneonta

PROJECTS UNDER DESIGN

| Capital Plan Projects | Total Estimated Project Cost | YTD Expend. thru 07-31-09 | LTD Expend. thru 07-31-09 | Encumbered Amount 07-31-09 | Anticipated Start of Construction | | | | |
|--|------------------------------|---------------------------|---------------------------|----------------------------|-----------------------------------|-------|-------|-------|-------|
| | | | | | 09/10 | 10/11 | 11/12 | 12/13 | 13/14 |
| Rehabilitation of Fitzelle Hall, Bldg. No. 26 | \$35,115 | \$156 | \$156 | \$4,328 | | X | | | |
| Replace HVAC/Domestic Hot Water Equipment, Instructional Resource Center | \$2,256 | \$67 | \$162 | \$328 | X | | | | |
| Replace Campus Sidewalks and Roads | \$1,200 | \$0 | \$0 | \$0 | | X | | | |
| Replace Medium Temperature Water Lines | \$2,221 | \$34 | \$69 | \$223 | X | | | | |
| Replace Roof/Windows-Physical Education Building | \$1,995 | \$0 | \$0 | \$274 | | X | | | |

PROJECTS UNDER CONSTRUCTION

| Capital Plan Projects | Total Estimated Project Cost | YTD Expend. thru 07-31-09 | LTD Expend. thru 07-31-09 | Encumbered Amount 07-31-09 | Anticipated Completion Date | | | | |
|---|------------------------------|---------------------------|---------------------------|----------------------------|-----------------------------|-------|-------|-------|-------|
| | | | | | 09/10 | 10/11 | 11/12 | 12/13 | 13/14 |
| Upgrade Central Heating Plant, Phase II | \$1,088 | \$6 | \$77 | \$869 | X | | | | |
| Rehabilitate Fine Arts Building, Phase II | \$6,510 | \$114 | \$942 | \$5,002 | | X | | | |
| Rehabilitate Biological Field Station- Cooperstown Facility, Bldg. No. 36 | \$7,030 | \$212 | \$531 | \$6,186 | | X | | | |
| ADA Modifications - Various Buildings, Phase II | \$987 | \$173 | \$248 | \$716 | X | | | | |
| Rehabilitate Fine Arts - Phase IIA | \$6,863 | \$1,863 | \$2,409 | \$4,218 | X | | | | |

**State University of New York
 2009/2010 Capital Program Plan
 Future Planned Projects - Over \$1M Construction
 As of July 31, 2009
 (In Thousands)**

State University College at Oneonta

| Capital Plan Projects | Total Estimated Project Cost | Funds Available | Funds Needed to Complete | SFY 2009/10 Phase \$ | SFY 2010/11 Phase \$ | SFY 2011/12 Phase \$ | SFY 2012/13 Phase \$ | SFY 2013/14 Phase \$ |
|---|------------------------------------|--------------------|--------------------------------|----------------------------|----------------------------|----------------------------|----------------------------|----------------------------|
| Rehabilitate Physical Science Building, Bldg no. 0025 | \$29,700 | \$0 | \$29,700 | | D \$5,700 | C \$21,000 | E \$3,000 | |
| Rehabilitate Physical Science Building | \$30,000 | \$30,000 | | TBD | | | | |

PROJECT PHASES: A = Acquisition, D = Design, C = Construction, E = Equipment

**State University of New York
Summary of Changes
2009/2010 Capital Program Plan
Project Cross-Reference: Current Year Status vs. Last Year
(In Thousands)**

State University College at Oneonta

| Capital Plan Project | 2008 Estimated Project Cost | 2009 Estimated Project Cost | Incr./Decr. In Estimate Cost |
|---|--------------------------------------|--------------------------------------|---------------------------------------|
| Projects Under Design | | | |
| Rehabilitation of Fizzle Hall, Bldg. No. 26 | \$36,000 | \$35,115 | -\$885 |
| Replace HVAC/Domestic Hot Water Equipment, Instructional Resource Center | \$3,621 | \$2,256 | -\$1,365 |
| Replace Medium Temperature Water Lines | \$2,089 | \$2,221 | \$132 |
| Replace Roof/Windows-Physical Education Building | | \$1,995 | \$1,995 |
| Projects Under Construction | | | |
| Upgrade Central Heating Plant, Phase II | \$1,280 | \$1,088 | -\$192 |
| Rehabilitate Fine Arts Building, Phase II | \$13,178 | \$6,510 | -\$6,668 |
| Rehabilitate Biological Field Station- Cooperstown Facility, Bldg. No. 36 | \$6,592 | \$7,030 | \$438 |
| ADA Modifications - Various Buildings, Phase II | \$1,339 | \$987 | -\$352 |
| Rehabilitate Fine Arts - Phase IIA | | \$6,863 | \$6,863 |
| Completed Projects | | | |
| Replace Burners, Pumps and Controls Central Heating Plant | \$2,683 | \$2,839 | \$156 |
| Rehabilitation Of Science I Building Phase I | \$13,451 | \$13,509 | \$58 |
| Future Projects | | | |
| Rehabilitate Physical Science Building, Bldg no. 0025 | | \$29,700 | \$29,700 |